

T-17-N

ATKINSON PLAT

(Landowners)

LORAIN TWP

R-4-E

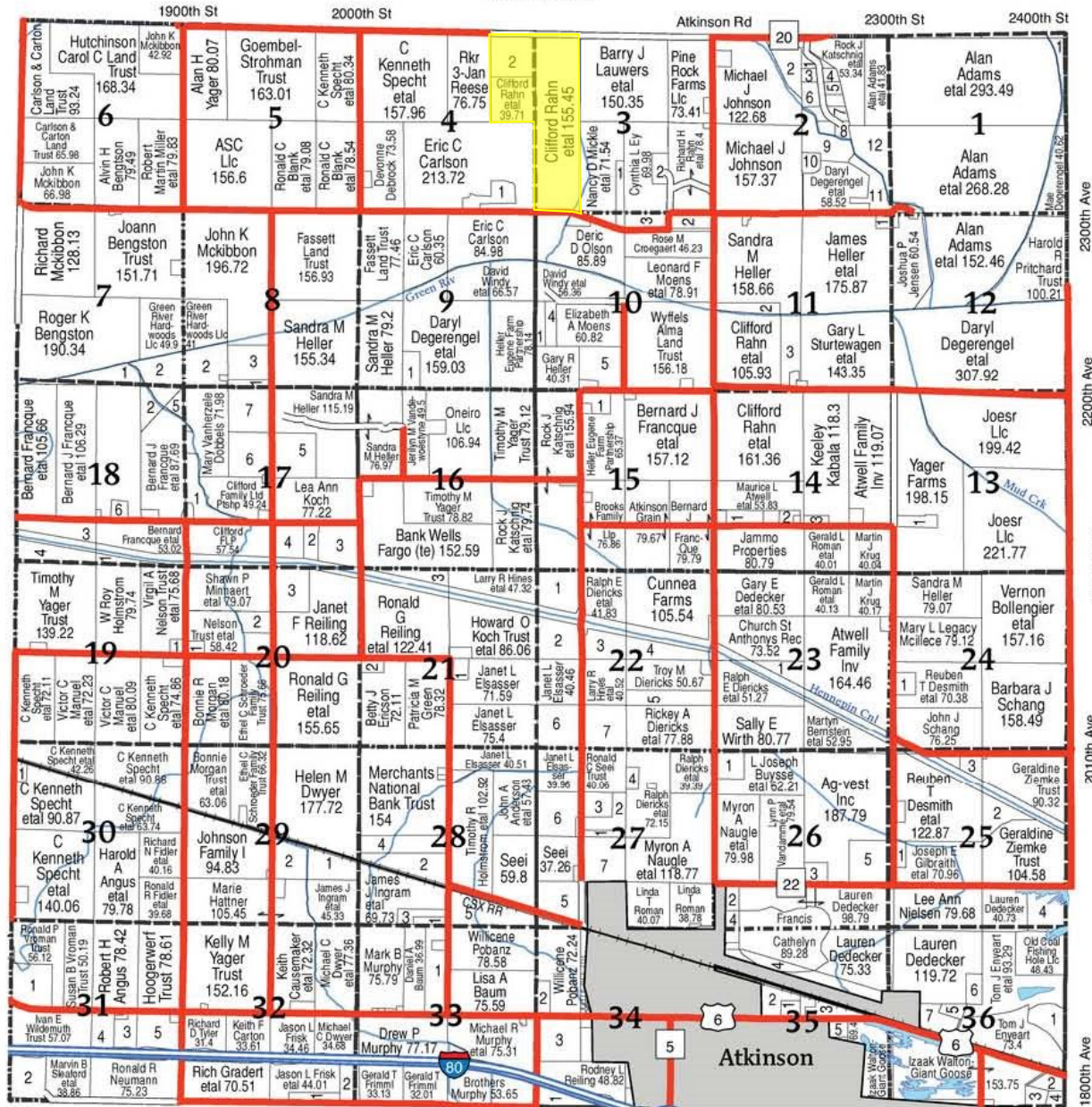
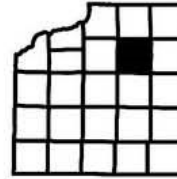

CORNWALL TWP

ATKINSON TOWNSHIP

SECTION 1

- Muirhead, Robert C 16.72

SECTION 2

- Dralle, Mary E etal 10.06
- Thomas, Craig A etal 24.24
- Johnson, Michael J etal 5.01
- Labrie, Charles A etal 5.01
- Clemenz, Steven C 5

SECTION 3

- Lease, Todd etal 9.98
- Mannon, Michael W etal 5.77
- Swinford, Paul D 5.39
- Minor, Lillian B 28.43
- Minor, Wayne E etal 7.90
- Hodgson, Rhett etal 21.10
- Adams, Alan etal 35.44
- Kerschietler, Miachel A etal 8.29
- Ey, Cynthia L 10.04

SECTION 4

- Carlson, Eric C etal 17.23
 - Rahn, Clifford etal 38.27
- #### SECTION 7
- Francque Trust, Albert etal 29.10
- #### SECTION 8
- Miller, Robert M etal 6.61

SECTION 9

- Olson, Robert T etal 13.52
- #### SECTION 10
- Heller Eugene Farm Partnership 10.07
 - Croegaert, Rose M 14.09
 - Ey, Cynthia L 13.85

SECTION 11

- Heller, Sandra M 5.45
- Heller, James etal 12.65
- Sturtewagen, Gary L etal 27.39

SECTION 13

- Yager Farms Co-ptshp 9.99

SECTION 14

- King, Luan L 11.49
- Roman Trust, Gerald L 5.11
- Federal National Mortgage Assoc 5.16

SEE PAGES 106-110 FOR ADDITIONAL NAMES NOT LISTED ON MAPS.

© Farm & Home Publishers, Ltd.

HENRY CO., IL