

Tillable Soils Map

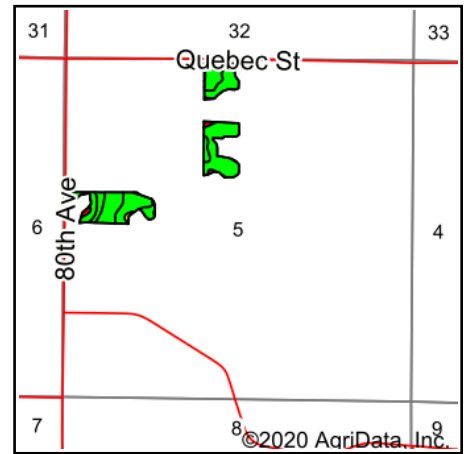

State: **Iowa**
County: **Warren**
Location: **5-74N-24W**
Township: **Squaw**
Acres: **22.87**
Date: **11/9/2020**

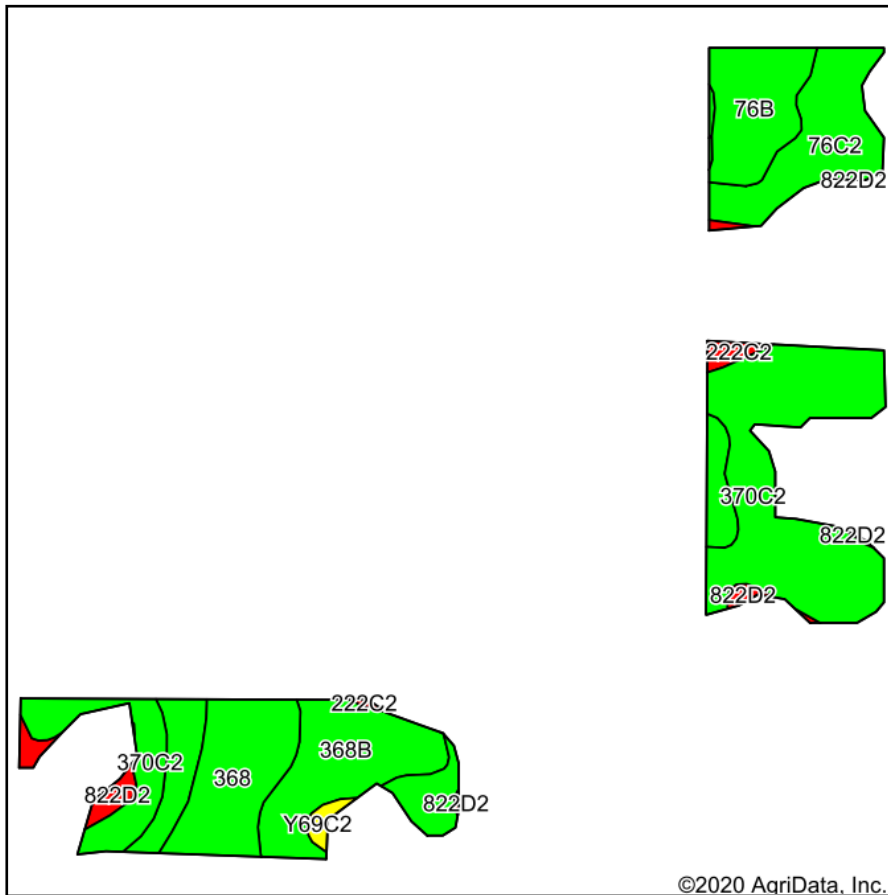

Maps Provided By:



Area Symbol: IA181, Soil Area Version: 25									
Code	Soil Description	Acres	Percent of field	CSR2 Legend	Non-Irr Class *c	CSR2**	CSR	*n NCCPI Overall	*n NCCPI Soybeans
370C2	Sharpsburg silty clay loam, 5 to 9 percent slopes, eroded	7.92	34.6%		IIIe	80	67	84	67
368B	Macksburg silty clay loam, 2 to 5 percent slopes	4.91	21.5%		Ile	89	90	87	78
76C2	Ladoga silt loam, dissected till plain, 5 to 9 percent slopes, eroded	3.62	15.8%		IIIe	75	65	78	66
368	Macksburg silty clay loam, 0 to 2 percent slopes	2.95	12.9%		Iw	93	95	87	79
76B	Ladoga silt loam, 2 to 5 percent slopes	2.35	10.3%		Ile	86	85	85	79
822D2	Lamoni silty clay loam, 9 to 14 percent slopes, eroded	0.61	2.7%		IVe	10	15	61	43
222C2	Clarinda silty clay loam, 5 to 9 percent slopes, moderately eroded	0.31	1.4%		IVw	28	25	55	43
Y69C2	Clearfield silty clay loam, dissected till plain, 5 to 9 percent slopes, eroded	0.20	0.9%		IIIw	56		67	59
Weighted Average						80.7	*-	*n 83	*n 70.9

**IA has updated the CSR values for each county to CSR2.

*- CSR weighted average cannot be calculated on the current soils data, use prior data version for csr values.

*n: The aggregation method is "Weighted Average using all components"

*c: Using Capabilities Class Dominant Condition Aggregation Method

Soils data provided by USDA and NRCS.