

Tillable Soils Map

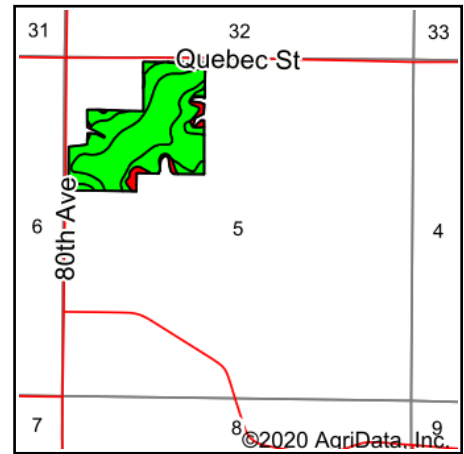

State: **Iowa**
 County: **Warren**
 Location: **5-74N-24W**
 Township: **Squaw**
 Acres: **62.58**
 Date: **11/10/2020**

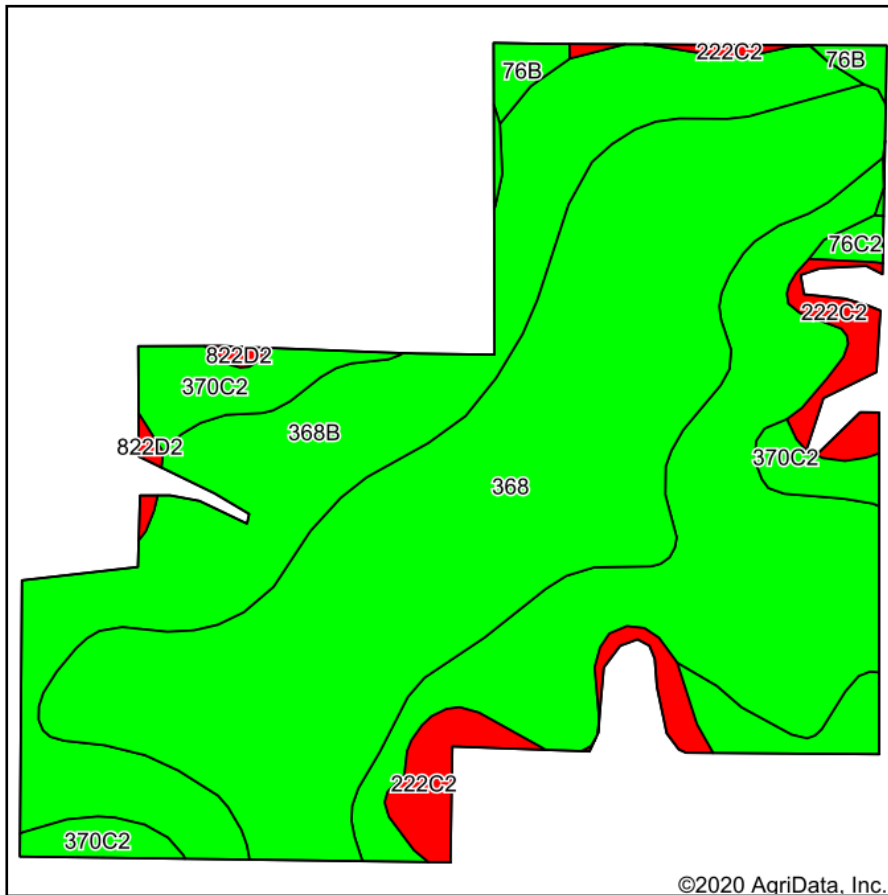

Maps Provided By:



Area Symbol: JA181. Soil Area Version: 25

Code	Soil Description	Acres	Percent of field	CSR2 Legend	Non-Irr Class *c	CSR2**	CSR	*n NCCPI Overall	*n NCCPI Soybeans
368B	Macksburg silty clay loam, 2 to 5 percent slopes	27.86	44.5%		Ile	89	90	87	78
368	Macksburg silty clay loam, 0 to 2 percent slopes	25.85	41.3%		Iw	93	95	87	79
370C2	Sharpsburg silty clay loam, 5 to 9 percent slopes, eroded	4.45	7.1%		IIle	80	67	84	67
222C2	Clarinda silty clay loam, 5 to 9 percent slopes, moderately eroded	3.08	4.9%		IVw	28	25	55	43
76B	Ladoga silt loam, 2 to 5 percent slopes	0.77	1.2%		Ile	86	85	85	79
76C2	Ladoga silt loam, dissected till plain, 5 to 9 percent slopes, eroded	0.30	0.5%		IIle	75	65	78	66
822D2	Lamoni silty clay loam, 9 to 14 percent slopes, eroded	0.27	0.4%		IVe	10	15	61	43
Weighted Average						86.6	86.7	*n 85	*n 75.7

**IA has updated the CSR values for each county to CSR2.

*n: The aggregation method is "Weighted Average using all components"

*c: Using Capabilities Class Dominant Condition Aggregation Method

Soils data provided by USDA and NRCS.