

# Soils Map - Soil Map Tillable Acres

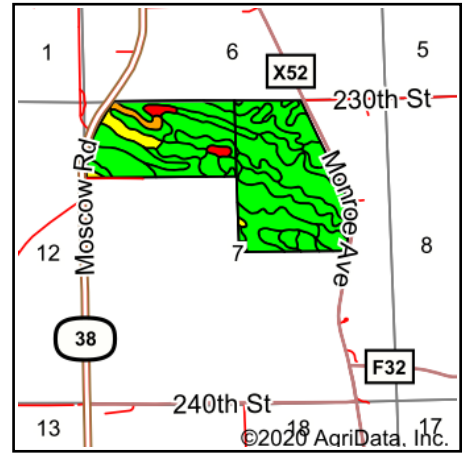

State: **Iowa**  
 County: **Cedar**  
 Location: **7-80N-2W**  
 Township: **Center**  
 Acres: **177.54**  
 Date: **12/10/2020**

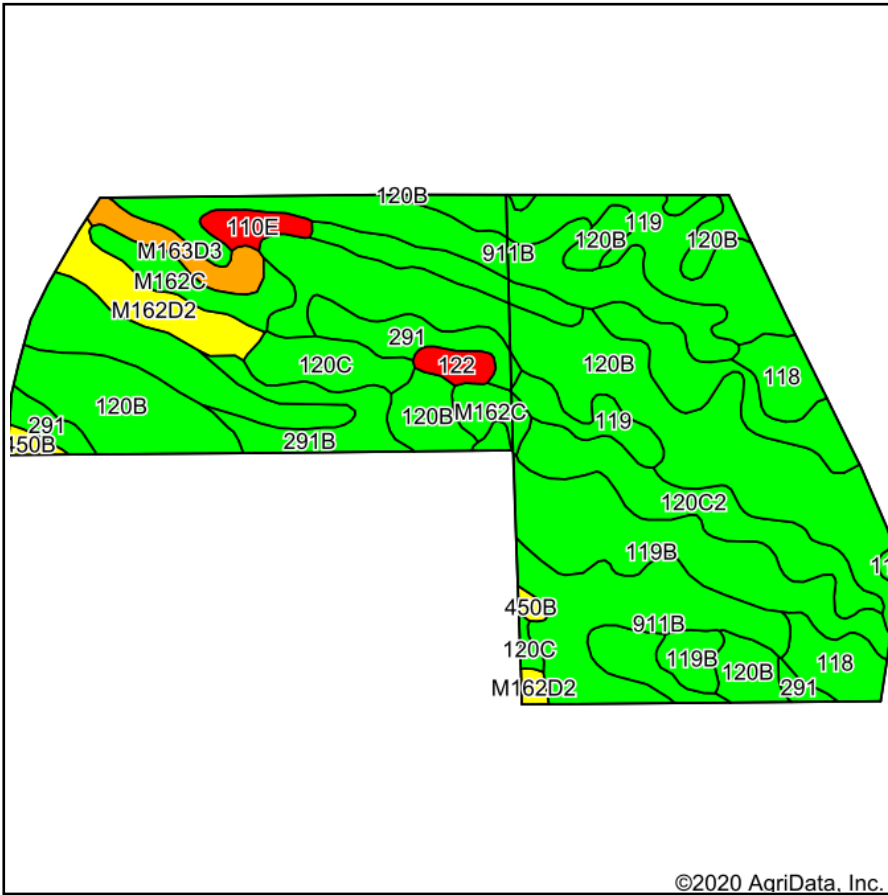

Maps Provided By:  
  
 © AgriData, Inc. 2020 [www.AgriDataInc.com](http://www.AgriDataInc.com)



Soils data provided by USDA and NRCS.

©2020 AgriData, Inc.

Code	Soil Description	Acres	Percent of field	CSR2 Legend	Non-Irr Class *c	*i Corn	*i Alfalfa	*i Soybeans	CSR2**	Corn	Oats	Soybeans	*n NCCPI Corn	*n NCCPI Soybeans
120B	Tama silty clay loam, 2 to 5 percent slopes	46.05	25.9%		Ile	232	6.5	67.3	95				97	80
911B	Colo-Ely complex, 0 to 5 percent slopes	35.15	19.8%		Ilw	204.8	4.3	59.4	86				92	76
119	Muscatine silty clay loam, 0 to 2 percent slopes	21.15	11.9%		Iw	240	6.2	69.6	100				96	91
119B	Muscatine silty clay loam, 2 to 5 percent slopes	16.12	9.1%		Ile	232	6	67.3	95				96	89
120C2	Tama silty clay loam, 5 to 9 percent slopes, eroded	9.42	5.3%		Ille	211.2	5.9	61.2	87				90	70
118	Garwin silty clay loam, 0 to 2 percent slopes	6.72	3.8%		Ilw	230.4	4.8	66.8	90				92	86
291	Atterberry silt loam, 0 to 2 percent slopes	6.39	3.6%		Iw	224	5.8	65	90				98	96
M162C	Downs silt loam, till plain, 5 to 9 percent slopes	6.11	3.4%		Ille	0	0	0	85				92	79
M162D2	Downs silt loam, till plain, 9 to 14 percent slopes, eroded	5.95	3.4%		Ive	0	0	0	57				82	65
291B	Atterberry silt loam, 2 to 5 percent slopes	5.28	3.0%		Ile	216	5.6	62.6	85	10	5	3	97	96
120C	Tama silty clay loam, 5 to 9 percent slopes	4.82	2.7%		Ille	216	6	62.6	90				93	77
M162C2	Downs silt loam, till plain, 5 to 9 percent slopes, eroded	4.13	2.3%		Ille	0	0	0	82				86	69
M163D3	Fayette silty clay loam, till plain, 9 to 14 percent slopes, severely eroded	3.15	1.8%		Ive	0	0	0	41				73	56
M162B	Downs silt loam, till plain, 2 to 5 percent slopes	2.75	1.5%		Ile	0	0	0	90				94	81



110E	Lamont fine sandy loam, 9 to 18 percent slopes	1.86	1.0%		Vle	128	3.6	37.1	16				64	45
122	Sperry silt loam, depressional, 0 to 1 percent slopes	1.43	0.8%		Illw	164.8	3.5	47.8	36				65	47
450B	Pillot silt loam, 2 to 5 percent slopes	1.06	0.6%		Ile	80	2.2	23.2	66	21	10	6	88	70
<b>Weighted Average</b>						<b>193.8</b>	<b>4.9</b>	<b>56.2</b>	<b>88.2</b>	<b>0.4</b>	<b>0.2</b>	<b>0.1</b>	<b>*n 93.1</b>	<b>*n 80.1</b>

\*\*IA has updated the CSR values for each county to CSR2.

\*i Yield data provided by the ISPAID Database version 8.1.1 developed by IA State University.

\*n: The aggregation method is "Weighted Average using all components"

\*c: Using Capabilities Class Dominant Condition Aggregation Method

Soils data provided by USDA and NRCS.