

Tillable Soils Map

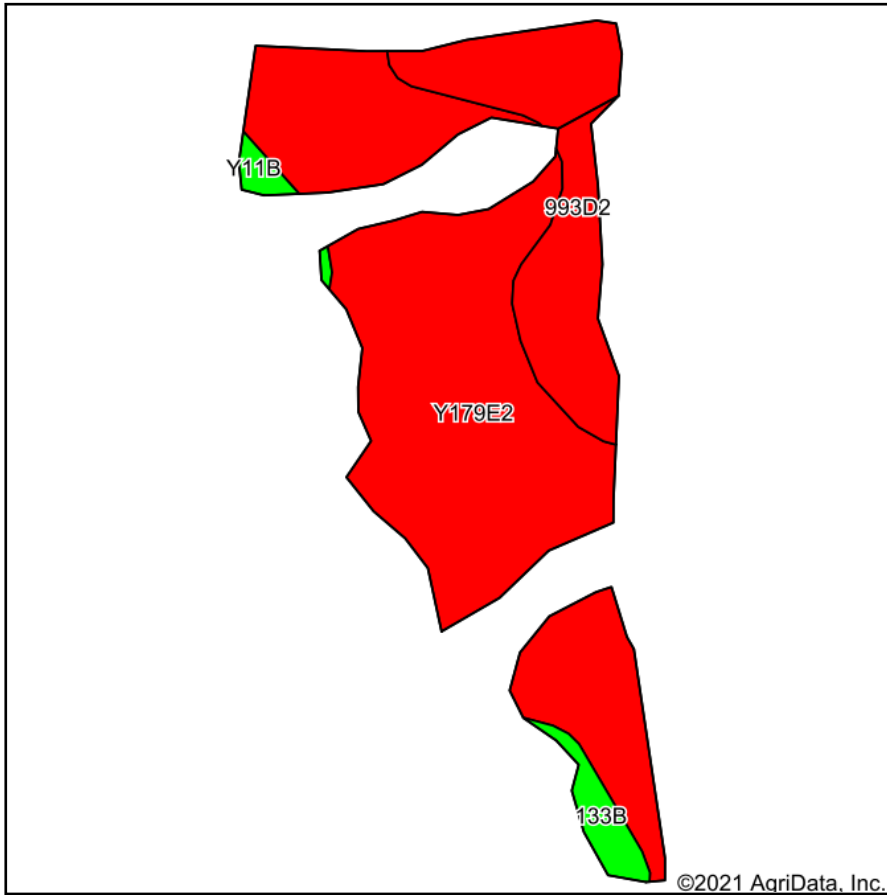

Soils data provided by USDA and NRCS.

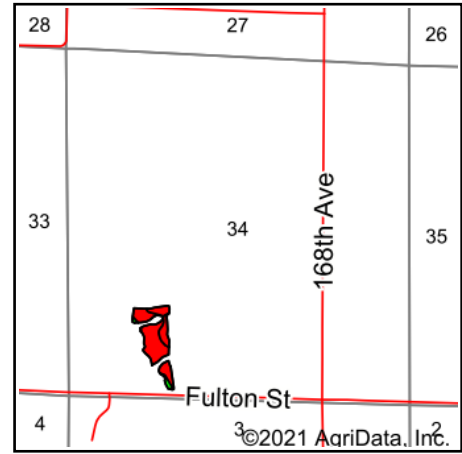

State: **Iowa**
 County: **Warren**
 Location: **34-77N-23W**
 Township: **Palmyra**
 Acres: **8.47**
 Date: **1/14/2021**



Maps Provided By:



© AgriData, Inc. 2021

www.AgriDataInc.com



Code	Soil Description	Acres	Percent of field	CSR2 Legend	Non-Irr Class *c	CSR2**	CSR	*n NCCPI Overall	*n NCCPI Soybeans
Y179E2	Gara loam, dissected till plain, 14 to 18 percent slopes, eroded	6.22	73.4%		Vle	32		72	50
993D2	Armstrong-Gara loams, 9 to 14 percent slopes, moderately eroded	1.86	22.0%		IVe	23	20	68	47
133B	Colo silty clay loam, dissected till plain, 2 to 5 percent slopes, occasionally flooded	0.27	3.2%		IIw	74	75	83	82
Y11B	Colo, occasionally flooded-Ely silty clay loams, dissected till plain, 2 to 5 percent slopes	0.12	1.4%		IIw	80		88	81
Weighted Average						32	*-	*n 71.7	*n 50.8

**IA has updated the CSR values for each county to CSR2.

*- CSR weighted average cannot be calculated on the current soils data, use prior data version for csr values.

*n: The aggregation method is "Weighted Average using all components"

*c: Using Capabilities Class Dominant Condition Aggregation Method

Soils data provided by USDA and NRCS.