

# Tillable Soils Map

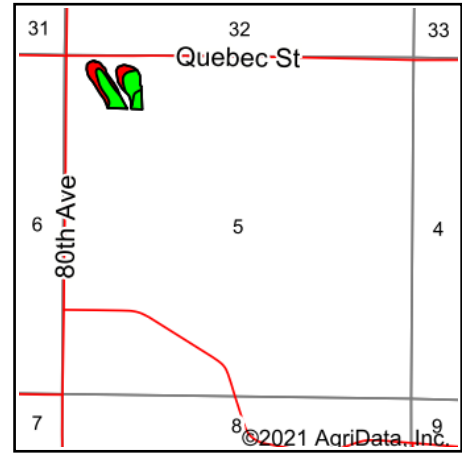

Soils data provided by USDA and NRCS.



State: **Iowa**  
 County: **Warren**  
 Location: **5-74N-24W**  
 Township: **Squaw**  
 Acres: **8.6**  
 Date: **1/14/2021**



Maps Provided By:



© AgriData, Inc. 2021

www.AgriDataInc.com



Code	Soil Description	Acres	Percent of field	CSR2 Legend	Non-Irr Class *c	CSR2**	CSR	*n NCCPI Overall	*n NCCPI Soybeans
370C2	Sharpsburg silty clay loam, 5 to 9 percent slopes, eroded	4.54	52.8%		IIIe	80	67	84	67
822D2	Lamoni silty clay loam, 9 to 14 percent slopes, eroded	3.20	37.2%		IVe	10	15	61	43
368B	Macksburg silty clay loam, 2 to 5 percent slopes	0.86	10.0%		Ile	89	90	87	78
<b>Weighted Average</b>						<b>54.9</b>	<b>50</b>	<b>*n 75.7</b>	<b>*n 59.2</b>

\*\*IA has updated the CSR values for each county to CSR2.

\*n: The aggregation method is "Weighted Average using all components"

\*c: Using Capabilities Class Dominant Condition Aggregation Method

Soils data provided by USDA and NRCS.