

Soils Map

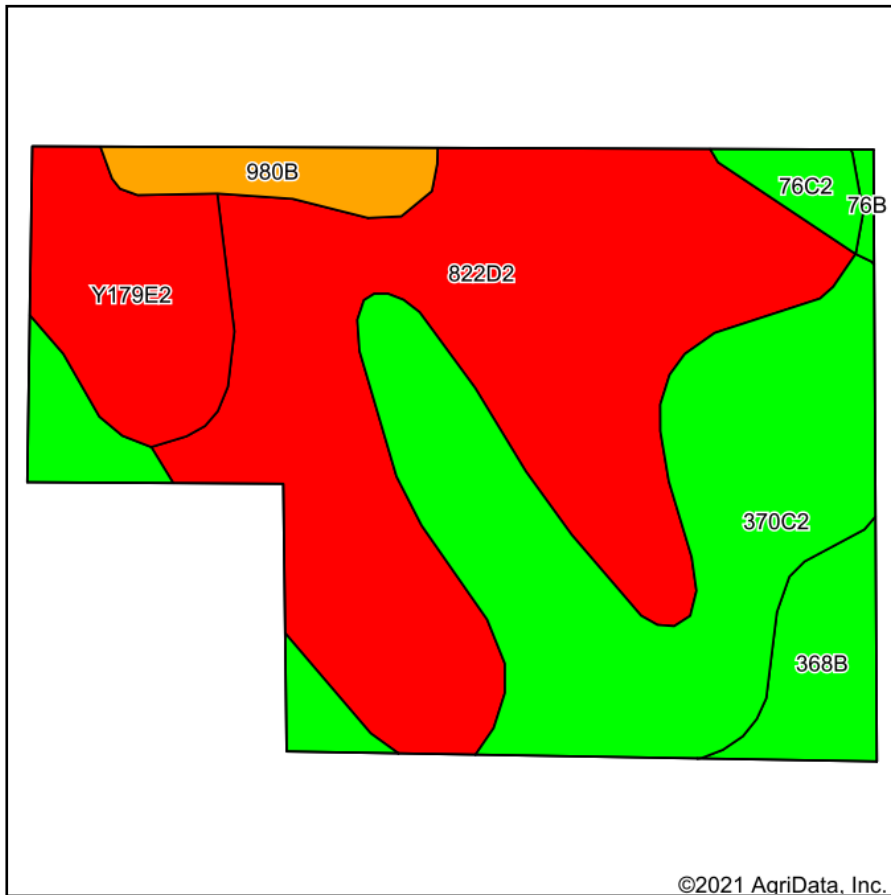

Soils data provided by USDA and NRCS.

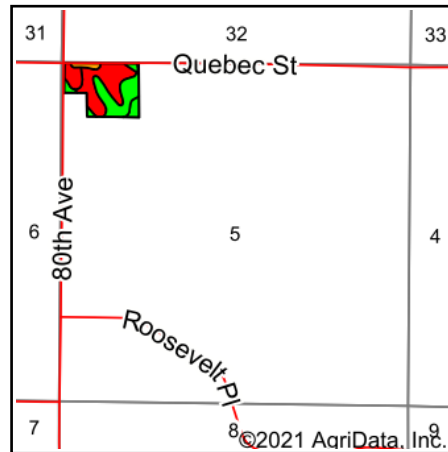

State: **Iowa**
 County: **Warren**
 Location: **5-74N-24W**
 Township: **Squaw**
 Acres: **18.5**
 Date: **1/14/2021**



Maps Provided By:



Code	Soil Description	Acres	Percent of field	CSR2 Legend	Non-Irr Class *c	CSR2**	CSR	*n NCCPI Overall	*n NCCPI Soybeans
822D2	Lamoni silty clay loam, 9 to 14 percent slopes, eroded	8.36	45.2%		IVe	10	15	61	43
370C2	Sharpsburg silty clay loam, 5 to 9 percent slopes, eroded	6.13	33.1%		IIIe	80	67	84	67
Y179E2	Gara loam, dissected till plain, 14 to 18 percent slopes, eroded	1.90	10.3%		VIe	32		72	50
368B	Macksburg silty clay loam, 2 to 5 percent slopes	0.96	5.2%		Ile	89	90	87	78
980B	Gullied land-Ely-Colo, occasionally flooded, complex, 2 to 5 percent slopes	0.73	3.9%		VIIe	42	25	10	9
76C2	Ladoga silt loam, dissected till plain, 5 to 9 percent slopes, eroded	0.35	1.9%		IIIe	75	65	78	66
76B	Ladoga silt loam, 2 to 5 percent slopes	0.07	0.4%		Ile	86	85	85	79
Weighted Average						42.3	*	*n 69.5	*n 52.7

**IA has updated the CSR values for each county to CSR2.

*- CSR weighted average cannot be calculated on the current soils data, use prior data version for csr values.

*n: The aggregation method is "Weighted Average using all components"

*c: Using Capabilities Class Dominant Condition Aggregation Method

Soils data provided by USDA and NRCS.