

Soils Map

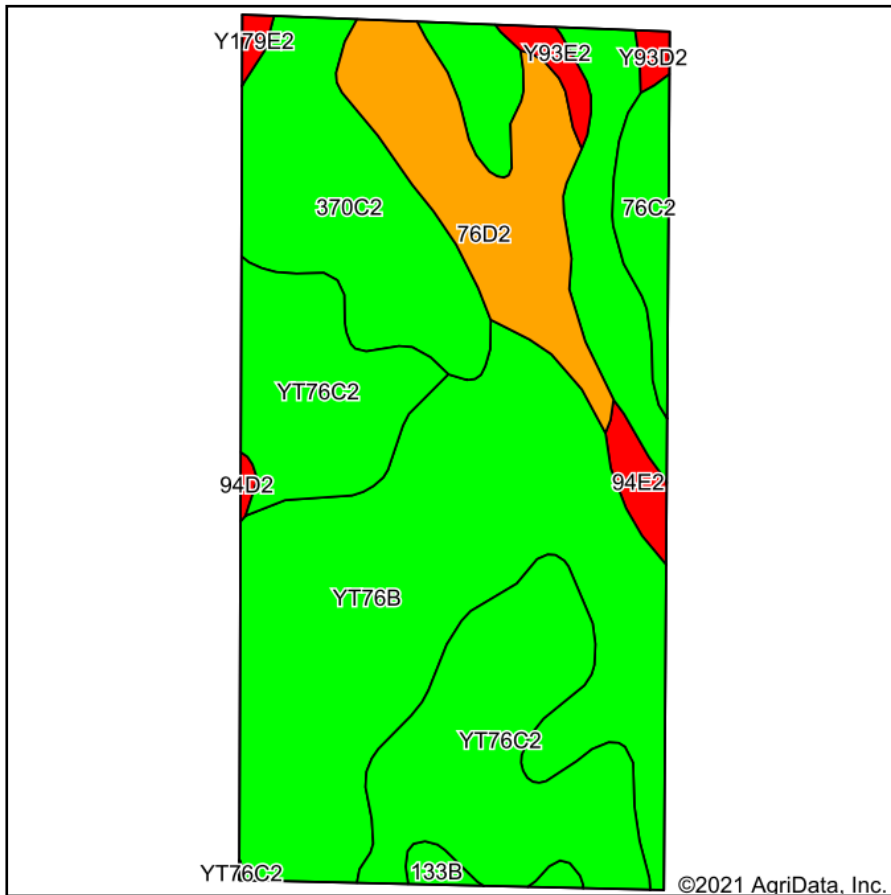

Soils data provided by USDA and NRCS.

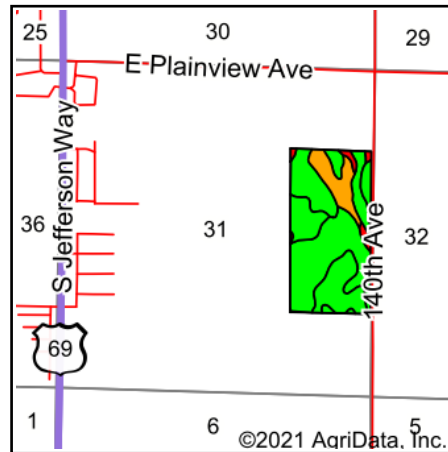

State: **Iowa**
 County: **Warren**
 Location: **31-76N-23W**
 Township: **Lincoln**
 Acres: **80**
 Date: **1/19/2021**



Maps Provided By:



Code	Soil Description	Acres	Percent of field	CSR2 Legend	Non-Irr Class *c	CSR2**	CSR	*n NCCPI Overall	*n NCCPI Soybeans
YT76B	Ladoga silt loam, terrace on dissected till plain, 2 to 5 percent slopes	28.44	35.6%		Ile	86		85	79
YT76C2	Ladoga silt loam, terrace on dissected till plain, 5 to 9 percent slopes, eroded	19.30	24.1%		IIle	78		80	68
370C2	Sharpsburg silty clay loam, 5 to 9 percent slopes, eroded	12.58	15.7%		IIIle	80	67	84	67
76D2	Ladoga silt loam, 9 to 14 percent slopes, eroded	9.01	11.3%		IIle	49	55	75	62
Y11B	Colo, occasionally flooded-Ely silty clay loams, dissected till plain, 2 to 5 percent slopes	4.80	6.0%		Ilw	80		88	81
76C2	Ladoga silt loam, dissected till plain, 5 to 9 percent slopes, eroded	2.55	3.2%		IIIle	75	65	78	66
94E2	Mystic-Caleb complex, 14 to 18 percent slopes, moderately eroded	1.07	1.3%		VIle	19	10	64	45
Y93E2	Shelby-Adair clay loams, dissected till plain, 14 to 18 percent slopes, eroded	0.77	1.0%		IVe	28		62	43
133B	Colo silty clay loam, dissected till plain, 2 to 5 percent slopes, occasionally flooded	0.68	0.8%		Ilw	74	75	83	82
Y93D2	Shelby-Adair clay loams, dissected till plain, 9 to 14 percent slopes, eroded	0.36	0.4%		IIle	35		70	51
Y179E2	Gara loam, dissected till plain, 14 to 18 percent slopes, eroded	0.29	0.4%		VIle	32		72	50
94D2	Mystic-Caleb complex, 9 to 14 percent slopes, moderately eroded	0.15	0.2%		IVe	25	25	71	50
Weighted Average						76.2	*	*n 81.8	*n 71.2

**IA has updated the CSR values for each county to CSR2.

*- CSR weighted average cannot be calculated on the current soils data, use prior data version for csr values.

*n: The aggregation method is "Weighted Average using all components"

*c: Using Capabilities Class Dominant Condition Aggregation Method

Soils data provided by USDA and NRCS.