

Soils Map

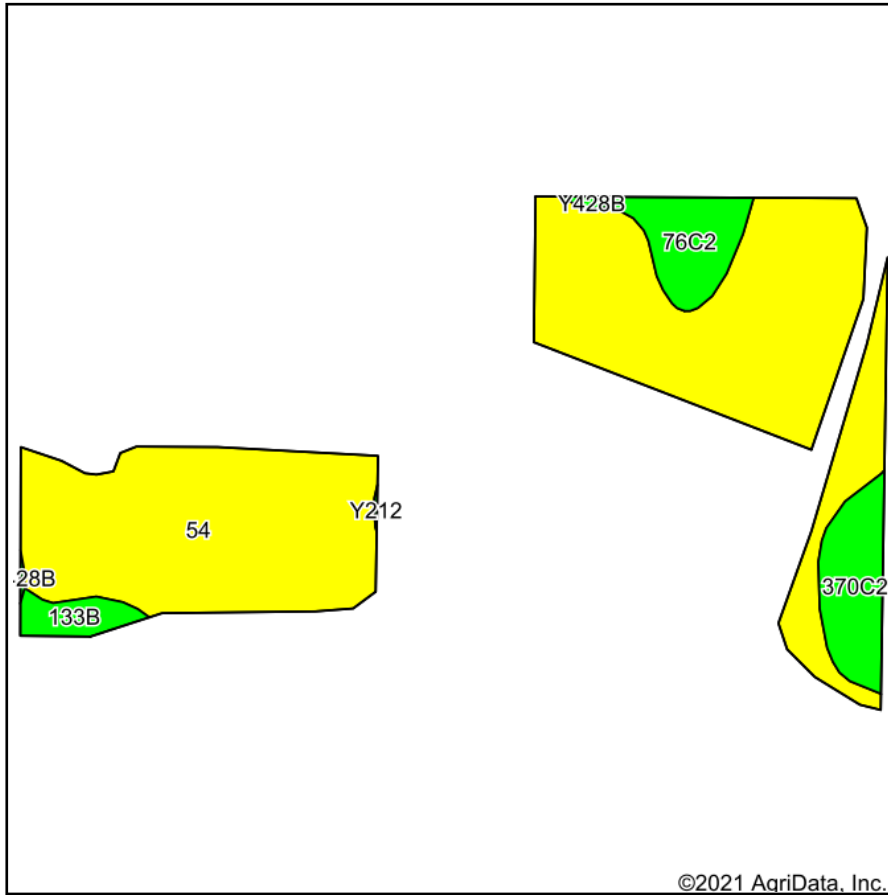

Soils data provided by USDA and NRCS.

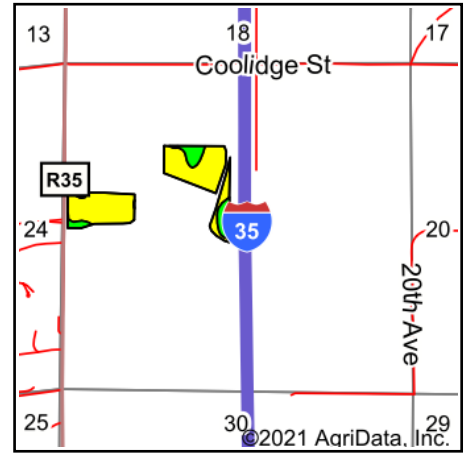

State: **Iowa**
 County: **Warren**
 Location: **19-77N-25W**
 Township: **Linn**
 Acres: **30.68**
 Date: **2/1/2021**



Maps Provided By:



| Code | Soil Description | Acres | Percent of field | CSR2 Legend | Non-Irr Class *c | CSR2** | CSR |
|------------------|---|-------|------------------|-------------|------------------|--------|-----|
| 54 | Zook silty clay loam, 0 to 2 percent slopes, occasionally flooded | 25.44 | 82.9% | | IIw | 67 | 70 |
| 370C2 | Sharpsburg silty clay loam, 5 to 9 percent slopes, eroded | 2.29 | 7.5% | | IIIe | 80 | 67 |
| 76C2 | Ladoga silt loam, dissected till plain, 5 to 9 percent slopes, eroded | 1.99 | 6.5% | | IIIe | 75 | 65 |
| 133B | Colo silty clay loam, dissected till plain, 2 to 5 percent slopes, occasionally flooded | 0.84 | 2.7% | | IIw | 74 | 75 |
| Y428B | Ely silty clay loam, dissected till plain, 2 to 5 percent slopes | 0.12 | 0.4% | | Ile | 88 | |
| Weighted Average | | | | | | 68.8 | *- |

**IA has updated the CSR values for each county to CSR2.

*- CSR weighted average cannot be calculated on the current soils data, use prior data version for csr values.

*c: Using Capabilities Class Dominant Condition Aggregation Method

Soils data provided by USDA and NRCS.