

# Soils Map

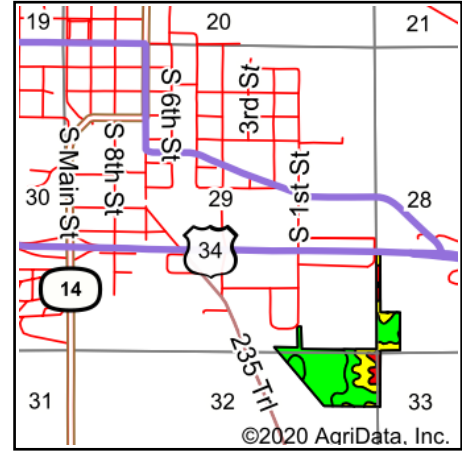

State: **Iowa**  
 County: **Lucas**  
 Location: **29-72N-21W**  
 Township: **Chariton**  
 Acres: **39.77**  
 Date: **9/4/2020**

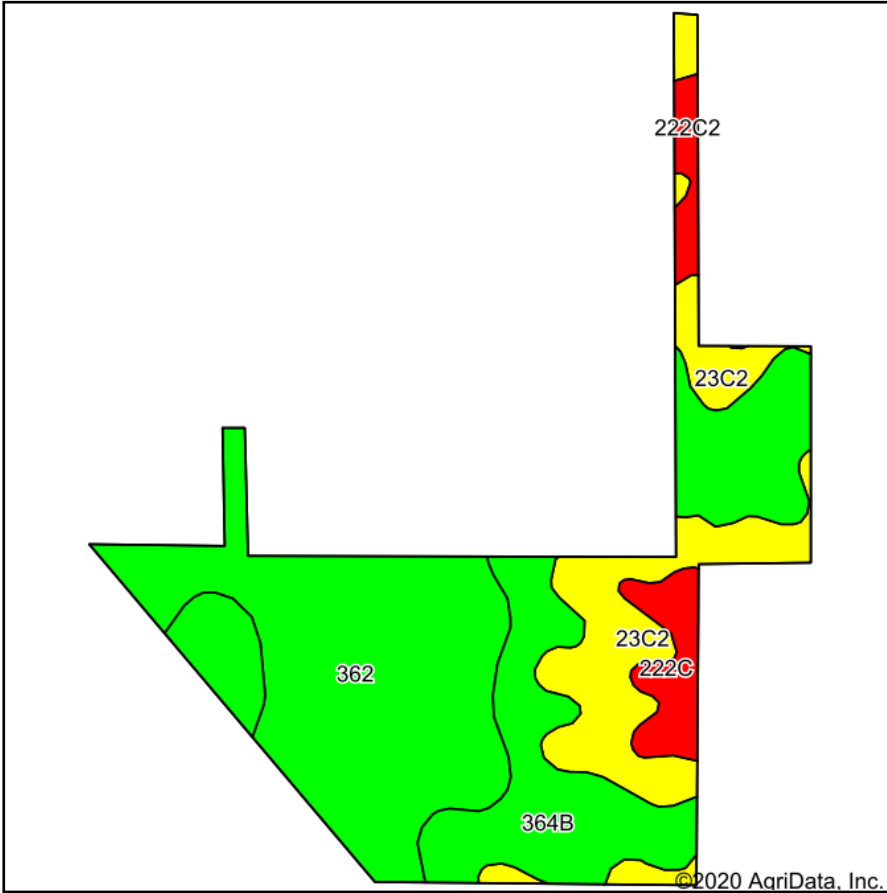

Area Symbol: IA117, Soil Area Version: 29									
Code	Soil Description	Acres	Percent of field	CSR2 Legend	Non-Irr Class *c	CSR2**	CSR	*n NCCPI Overall	*n NCCPI Soybeans
362	Haig silt loam, 0 to 2 percent slopes	15.90	40.0%		IIw	83	70	76	66
364B	Grundy silty clay loam, 2 to 5 percent slopes	12.78	32.1%		Ile	72	75	80	68
23C2	Arispe silty clay loam, 5 to 9 percent slopes, moderately eroded	8.20	20.6%		IIIe	62	50	75	69
222C	Clarinda silty clay loam, 5 to 9 percent slopes	1.98	5.0%		IVw	31	30	59	47
222C2	Clarinda silty clay loam, 5 to 9 percent slopes, moderately eroded	0.91	2.3%		IVw	28	25	55	43
<b>Weighted Average</b>						<b>71.3</b>	<b>64.5</b>	<b>*n 75.8</b>	<b>*n 65.8</b>

\*\*IA has updated the CSR values for each county to CSR2.  
 \*n: The aggregation method is "Weighted Average using all components"  
 \*c: Using Capabilities Class Dominant Condition Aggregation Method  
 Soils data provided by USDA and NRCS.