

Overton Funeral Home

501 West Ashland Ave., Indianola, IA 50125

phone 515-961-5121

announcement line 515-961-5169

Jeff and Alex Petersen, Elizabeth Waller

office@overtonfunerals.com • www.overtonfunerals.com

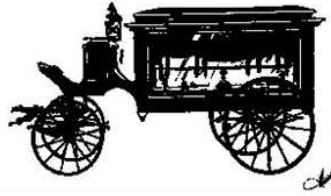

T-74-N

VIRGINIA PLAT

R-25-W

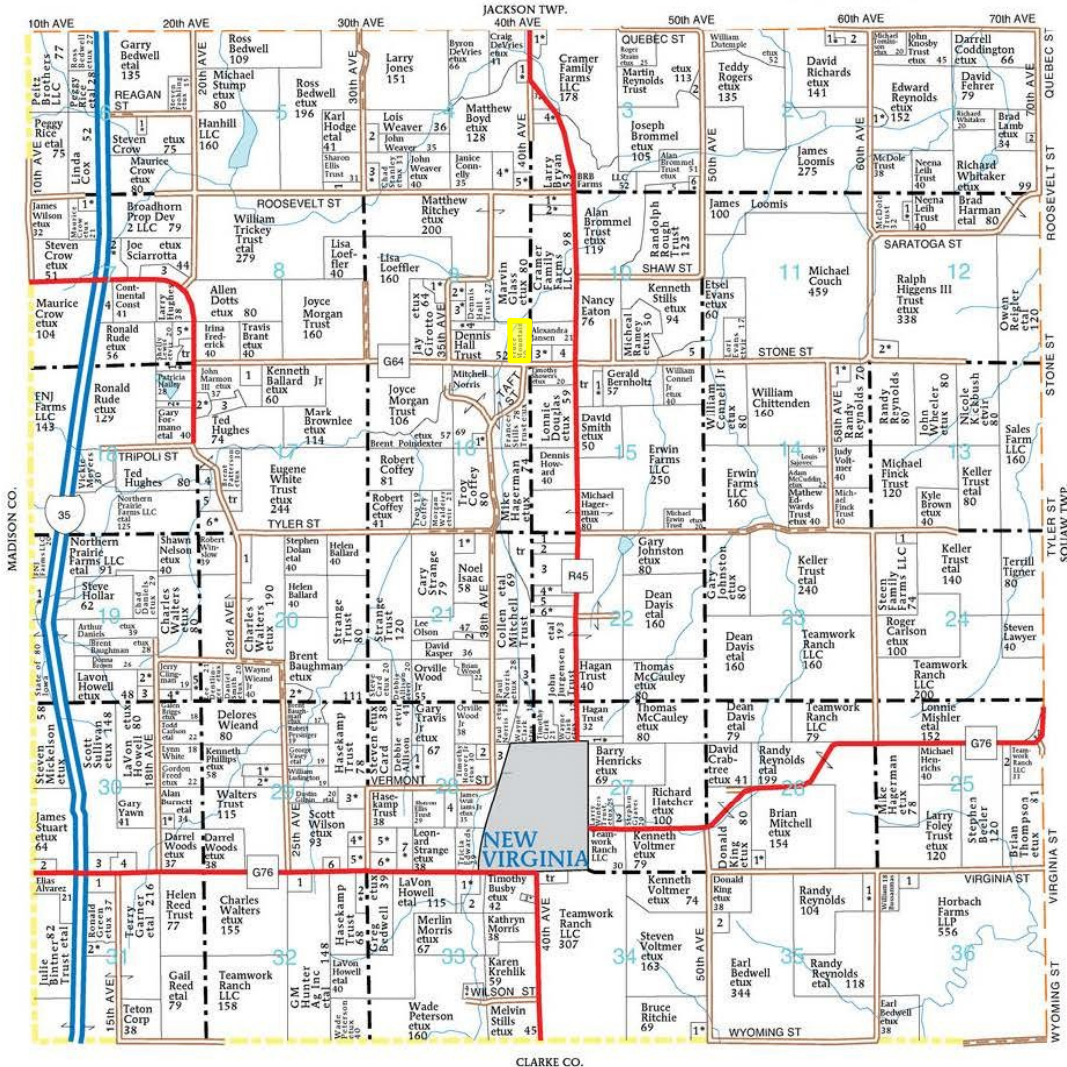

VIRGINIA TOWNSHIP

SECTION 1

- 1. Miller, James etal 7
- 2. Johnson, Bradley 5
- SECTION 2
- 1. Richards, David etux 5
- 2. Reed, Janell 7
- SECTION 3
- 1. Vyskocil, Brian etux 7
- 2. Dean, Julia 5
- 3. Thompson, Clair etux 7
- 4. Glenn, Kyler etux 7
- 5. Rough Trust, Randolph 9
- 6. Loomis, Ryan etux 6
- SECTION 4
- 1. Fantz, Jason etux 6

- 2. Midhun, Patricia 10
- 3. Isaac, Nathan etux 8
- 4. Schnobelen Trust, Mike etux 19
- 5. Freeman, Ronald etux 10
- SECTION 5
- 1. DeJode, Barbara 9
- SECTION 6
- 1. Doner, Clifford etux 5
- SECTION 7
- 1. Crow, James etux 6
- 2. Cowden, Randall etux 10
- 3. Conner, Hedi 16
- 4. Natural Gas Pipelines Co 8

- 5. Goetsch, Joel etux 9
- SECTION 9
- 1. Long, Nathanael etux 16
- 2. Black, Michael etal 6
- 3. Erickson, Dale etux 7
- 4. Goetschius, Randall etux 8
- SECTION 10
- 1. Anderson, Michael etux 12
- 2. Harwell, David etux 9
- 3. Bruce, Daniel etux 10
- 4. Cox, Brandon 10
- 5. Prymek, Randall 14
- SECTION 12
- 1. Alery, Michael etux 5

- 2. Parker, Eugene etux 13
- SECTION 14
- 1. Weeks, Justin etux 10
- SECTION 15
- 1. Davidson, Marvin etux 8
- SECTION 16
- 1. Charron, Graham etux 5
- SECTION 17
- 1. Grenier, Clinton 10
- 2. Schmidt, Toby etux 8
- 3. AEC Enterprises Inc 10
- 4. Hughes, Ted 10
- 5. McCauley, Dorothy 11
- 6. Motzko, Ashleigh etvir 15

- SECTION 18
- 1. Sanderson, Michael etux 5
- SECTION 19
- 1. Rosander, Merrill etux 12
- 2. Jelsma, Travis etux 8
- 3. Stuart, Joe 8
- 4. Alexander, Craig etux 10
- 5. Dentlinger, Lee etux 10
- 6. Kern, Cynthia 10
- 2. Paxton, Tina etal 9

- SECTION 21
- 1. Isaac, Nile etux 10
- 2. Yoda Trust 7
- 3. Jurgensen Trust, John etal 13
- SECTION 22
- 1. Schumacher, Richard 16
- 2. Williams, Ann 15
- 3. Choquette, Kenneth 48
- 4. Brand, Roger etux 11
- 5. Audlehelm, Kyle 12
- 6. Perry, Darrell etal 13
- SECTION 20
- 1. Kern, Cynthia 10
- 2. Paxton, Tina etal 9

SEE PAGES 71-72 FOR ADDITIONAL NAMES NOT LISTED ON MAPS.