

Tillable Soils Map

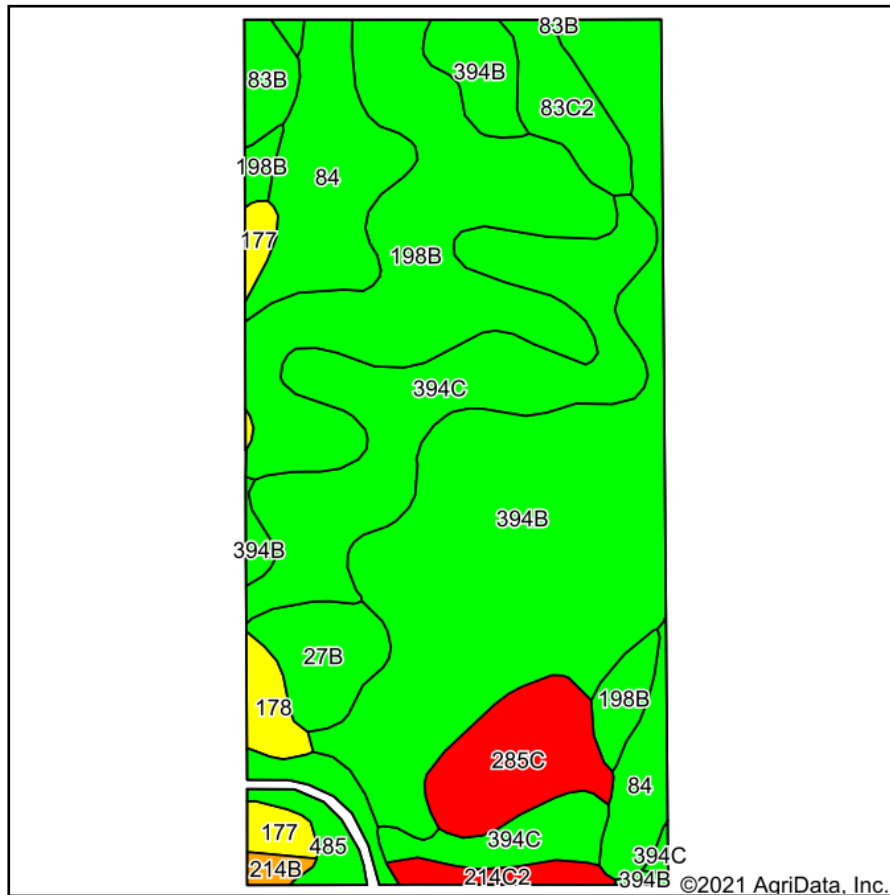

Soils data provided by USDA and NRCS.

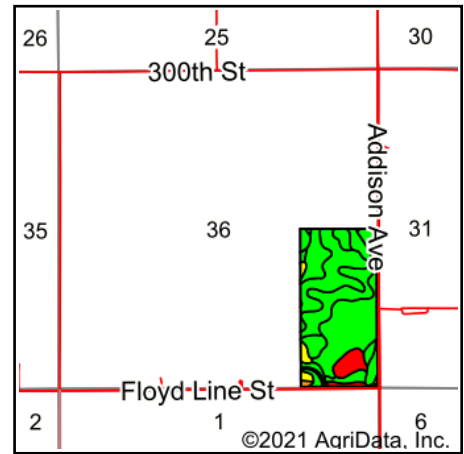

State: **Iowa**
 County: **Floyd**
 Location: **36-94N-15W**
 Township: **Riverton**
 Acres: **75.8**
 Date: **4/25/2021**

PC PEOPLES
 COMPANY
 INNOVATIVE. REAL ESTATE. SOLUTIONS.

Maps Provided By:

surety
 CUSTOMIZED ONLINE MAPPING
 © AgriData, Inc. 2021 www.AgriDataInc.com



Area Symbol: IA067, Soil Area Version: 26

Code	Soil Description	Acres	Percent of field	CSR2 Legend	Non-Irr Class *c	Irr Class *c	CSR2**	CSR	*n NCCPI Overall	*n NCCPI Corn	*n NCCPI Soybeans
394B	Ostrander loam, 2 to 5 percent slopes	24.22	32.0%		Ile		88	84	78	77	69
198B	Floyd loam, 1 to 4 percent slopes	15.23	20.1%		Ilw		89	74	85	81	85
394C	Ostrander loam, 5 to 9 percent slopes	13.53	17.8%		IIIe		83	69	77	77	67
84	Clyde silty clay loam, 0 to 3 percent slopes	7.35	9.7%		Ilw		88	77	90	90	85
285C	Burkhardt sandy loam, 5 to 9 percent slopes	3.98	5.3%		IIIs	IIle	13	5	58	58	33
27B	Terril loam, 2 to 5 percent slopes	2.53	3.3%		Ile		88	87	90	90	82
83C2	Kenyon loam, 5 to 9 percent slopes, eroded	2.30	3.0%		IIIe		84	67	83	83	66
485	Spillville loam, 0 to 2 percent slopes, occasionally flooded	1.98	2.6%		Ilw		76	92	87	87	74
83B	Kenyon loam, 2 to 5 percent slopes	1.16	1.5%		Ile		90	84	90	90	78
177	Saupe loam, 0 to 2 percent slopes	1.12	1.5%		IIs		60	63	78	78	61
178	Waukee loam, 0 to 2 percent slopes	1.08	1.4%		IIs		69	79	83	83	70
214C2	Rockton loam, 20 to 30 inches to limestone, till plain, 5 to 9 percent slopes, eroded	0.95	1.3%		IIIe		29	33	36	36	19
214B	Rockton loam, 20 to 30 inches to limestone, till plain, 2 to 5 percent slopes	0.37	0.5%		Ile		47	58	51	51	35
Weighted Average							81.3	73.1	*n 79.7	*n 78.6	*n 71.2

**IA has updated the CSR values for each county to CSR2.

*n: The aggregation method is "Weighted Average using all components"

*c: Using Capabilities Class Dominant Condition Aggregation Method

Soils data provided by USDA and NRCS.