

Tillable Soils Map

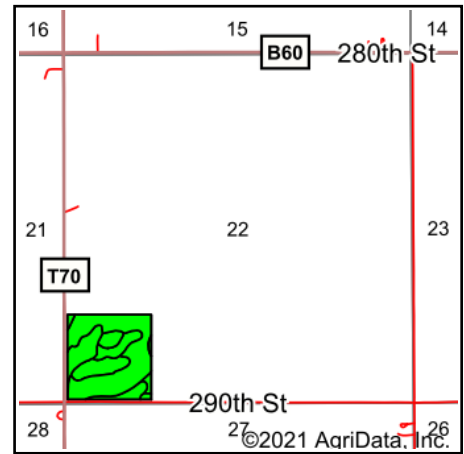

State: **Iowa**
 County: **Floyd**
 Location: **22-94N-15W**
 Township: **Riverton**
 Acres: **37.7**
 Date: **4/25/2021**

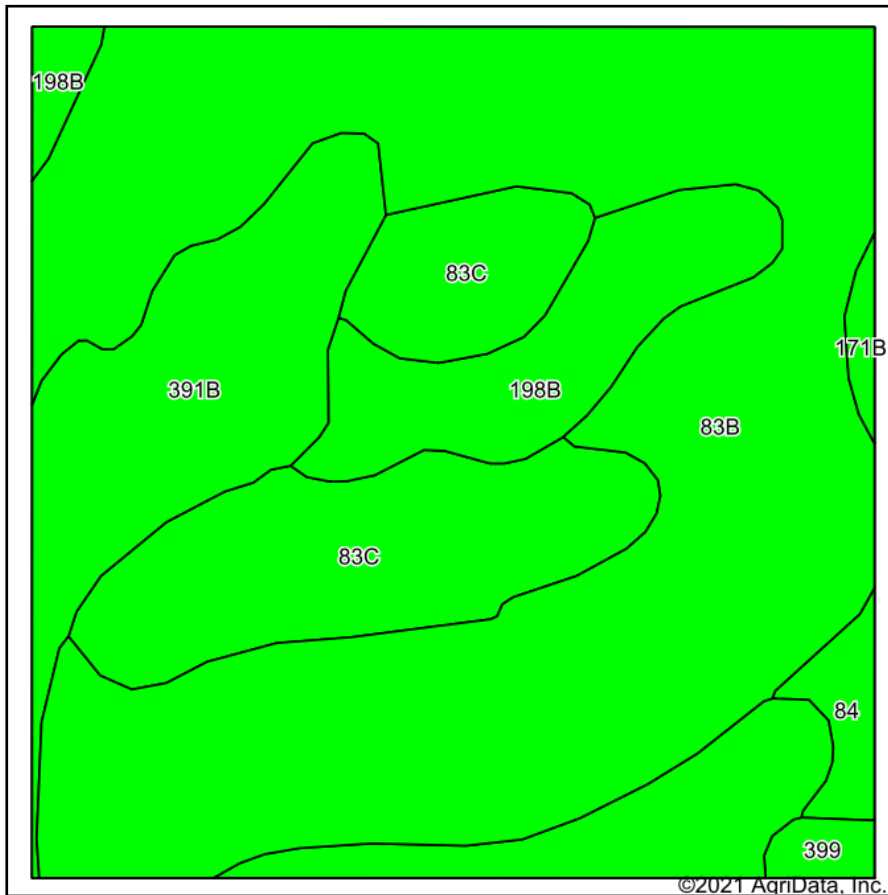

Maps Provided By:



Area Symbol: IA067, Soil Area Version: 26

Code	Soil Description	Acres	Percent of field	CSR2 Legend	Non-Irr Class *c	CSR2**	CSR	*n NCCPI Overall	*n NCCPI Corn	*n NCCPI Soybeans
83B	Kenyon loam, 2 to 5 percent slopes	20.47	54.3%		Ile	90	84	90	90	78
391B	Clyde-Floyd complex, 1 to 4 percent slopes	6.70	17.8%		Ilw	87	73	88	86	85
83C	Kenyon loam, 5 to 9 percent slopes	6.08	16.1%		Ille	85	69	89	89	76
198B	Floyd loam, 1 to 4 percent slopes	3.30	8.8%		Ilw	89	74	85	81	85
84	Clyde silty clay loam, 0 to 3 percent slopes	0.61	1.6%		Ilw	88	77	90	90	85
399	Readlyn silt loam, 1 to 3 percent slopes	0.32	0.8%		Iw	91		80	80	68
171B	Bassett loam, 2 to 5 percent slopes	0.22	0.6%		Ile	85	79	88	88	75
Weighted Average						88.5	*-	*n 88.9	*n 88.2	*n 79.5

**IA has updated the CSR values for each county to CSR2.

*- CSR weighted average cannot be calculated on the current soils data, use prior data version for csr values.

*n: The aggregation method is "Weighted Average using all components"

*c: Using Capabilities Class Dominant Condition Aggregation Method

Soils data provided by USDA and NRCS.