

DECATUR COUNTY

140

ACRES
M/L

Adam Curran

641.203.2931 | Adam@PeoplesCompany.com

Sara Curran

641.344.0847 | Sara@PeoplesCompany.com

Pasture Farm Available | \$505,000

DESCRIPTION

This 140 Acre M/L well established cattle/pasture farm offers some of the best views Southern Iowa has to offer. Located on a gorgeous ridge top and situated in section 20 of Woodland Township Decatur County, Iowa. This farm offers 116 Acres M/L on the west side of the road and an additional 24 Acres M/L on the east side of 300th Ave. The west side of the farm offers a mixture of 86 Acres M/L of open pasture land with existing paddox fences, an automatic water and two ponds. The farmhouse offers 3 bedrooms and 1 bath; it is being sold in "As-Is" condition. Plenty of storage is offered by several outbuildings at the acreage site. Across from the acreage on the east side is 24 Acres M/L which is currently used as grass hay ground. Don't miss out on this rare opportunity to own a larger pasture land farm in Southern Iowa!

DIRECTIONS

From Leon, IA travel east on IA-2 for approximately 2.3 miles. Turn right onto Co Rd R52 and travel 8.6 miles south. Turn left onto Co Rd R58/300th Ave and travel 1.4 miles.

IMPROVEMENTS

Fence, Ponds, Automatic water, Outbuildings

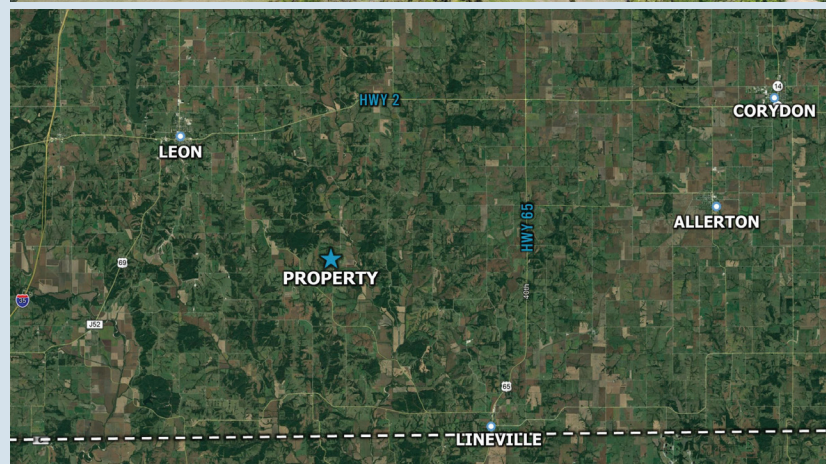

For more information visit
PeoplesCompany.com | Listing #15521