

Current Tillable Soils Map

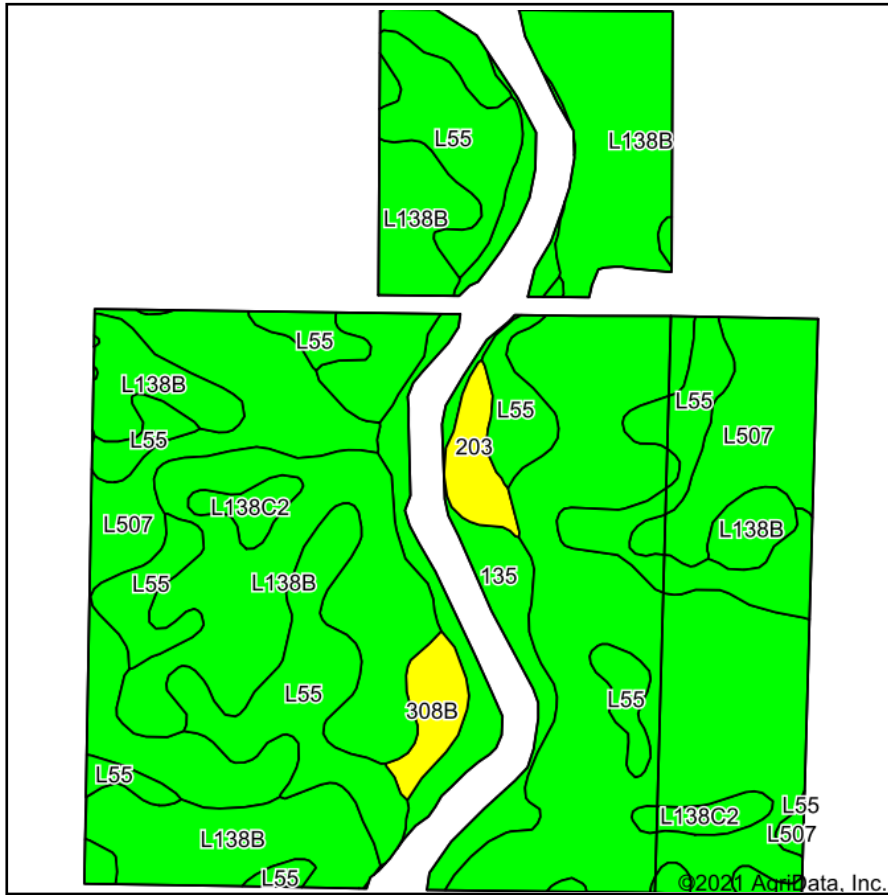

Soils data provided by USDA and NRCS.

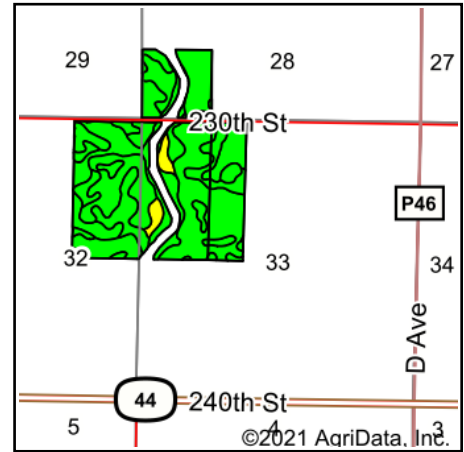

State: **Iowa**
 County: **Dallas**
 Location: **33-80N-29W**
 Township: **Lincoln**
 Acres: **213.87**
 Date: **7/23/2021**

PC PEOPLES
 COMPANY
 INNOVATIVE. REAL ESTATE. SOLUTIONS.

Maps Provided By:

surety
 CUSTOMIZED ONLINE MAPPING
 © AgriData, Inc. 2021 www.AgriDataInc.com



Area Symbol: IA049, Soil Area Version: 26

Code	Soil Description	Acres	Percent of field	CSR2 Legend	Non-Irr Class *c	*i Corn	*i Soybeans	CSR2**	CSR	*n NCCPI Overall
L138B	Clarion loam, Bemis moraine, 2 to 6 percent slopes	115.99	54.2%		Ile	80	23.2	88		80
L55	Nicollet loam, 1 to 3 percent slopes	43.66	20.4%		Ie	0	0	91		85
L507	Canisteo clay loam, Bemis moraine, 0 to 2 percent slopes	30.19	14.1%		Ilw	0	0	87		81
135	Coland clay loam, 0 to 2 percent slopes, occasionally flooded	14.01	6.6%		Ilw	198.4	57.5	76	80	83
L138C2	Clarion loam, Bemis moraine, 6 to 10 percent slopes, moderately eroded	3.71	1.7%		IIIe	0	0	83		67
308B	Wadena loam, 2 to 6 percent slopes	3.18	1.5%		Ile	80	23.2	52	68	63
203	Cylinder loam, 0 to 2 percent slopes	3.13	1.5%		Ils	80	23.2	58	80	73
Weighted Average						58.7	17	86.6	*-	*n 80.8

**IA has updated the CSR values for each county to CSR2.

*- CSR weighted average cannot be calculated on the current soils data, use prior data version for csr values.

*i Yield data provided by the ISPAID Database version 8.1.1 developed by IA State University.

*n: The aggregation method is "Weighted Average using all components"

*c: Using Capabilities Class Dominant Condition Aggregation Method

Soils data provided by USDA and NRCS.