

Soils Map

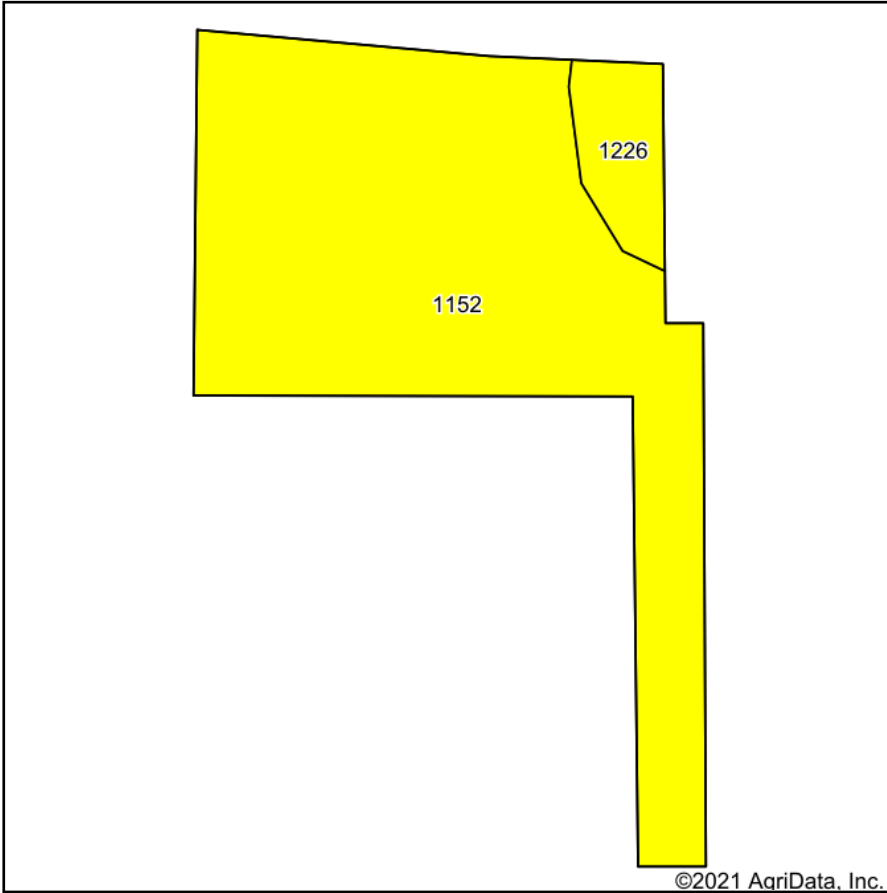

Soils data provided by USDA and NRCS.

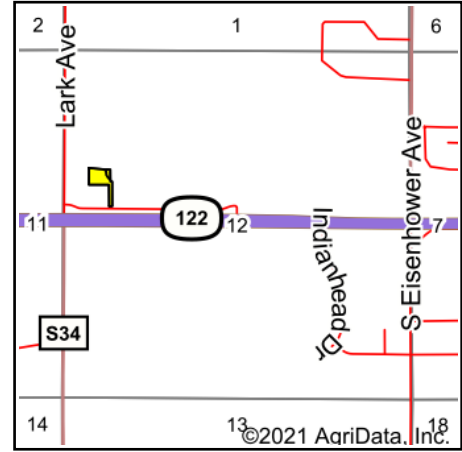

State: **Iowa**
 County: **Cerro Gordo**
 Location: **12-96N-21W**
 Township: **Mason City**
 Acres: **2.21**
 Date: **7/20/2021**



Maps Provided By:



© AgriData, Inc. 2021

www.AgriDataInc.com



Area Symbol: IA033, Soil Area Version: 24

Code	Soil Description	Acres	Percent of field	CSR2 Legend	Non-Irr Class *c	CSR2**	CSR	*n NCCPI Overall
1152	Marshan clay loam, 0 to 2 percent slopes, rarely flooded	2.04	92.3%		llw	54	67	82
1226	Lawler loam, 0 to 2 percent slopes, rarely flooded	0.17	7.7%		lls	59	71	83
Weighted Average						54.4	67.3	*n 82.1

**IA has updated the CSR values for each county to CSR2.

*n: The aggregation method is "Weighted Average using all components"

*c: Using Capabilities Class Dominant Condition Aggregation Method

Soils data provided by USDA and NRCS.