

Soils Map

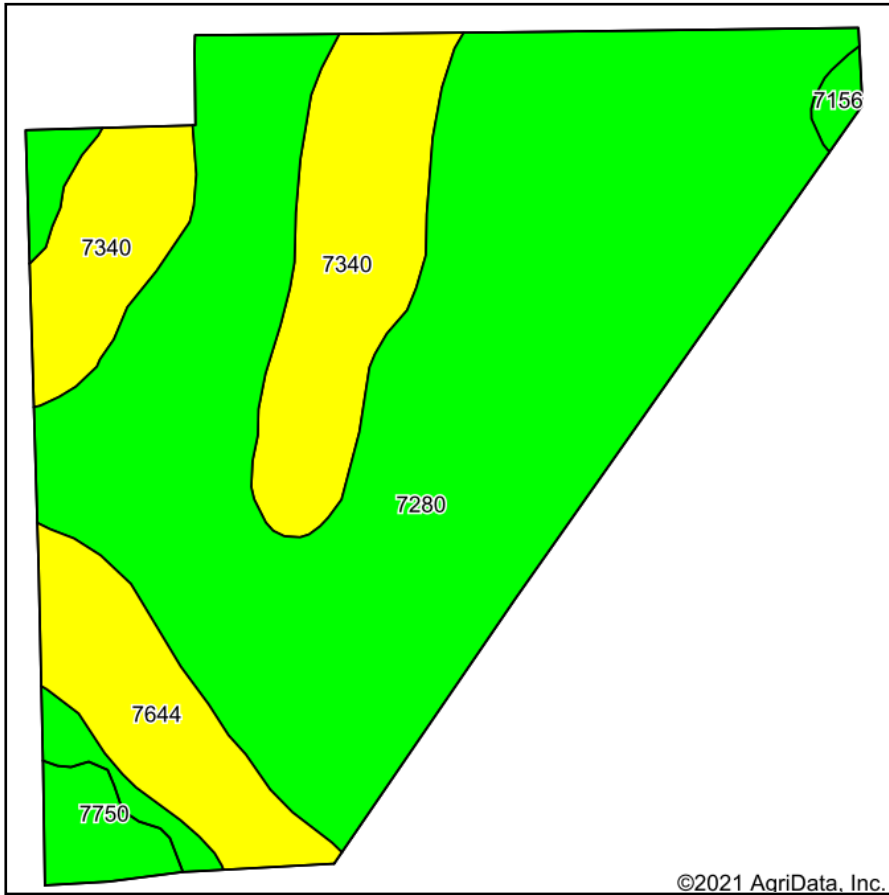

Soils data provided by USDA and NRCS.

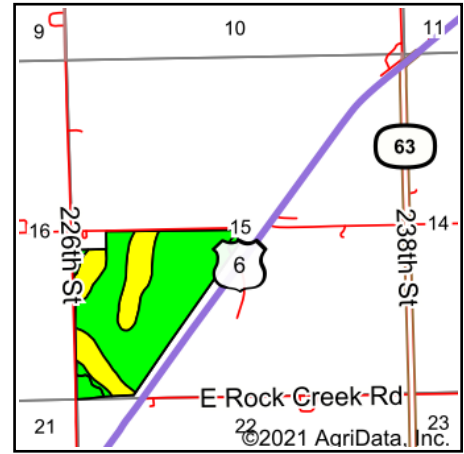

State: **Nebraska**
 County: **Cass**
 Location: **15-12N-9E**
 Township: **Salt Creek**
 Acres: **102.53**
 Date: **9/2/2021**



Maps Provided By:



Area Symbol: NE025, Soil Area Version: 20

Code	Soil Description	Acres	Percent of field	SRPG Legend	Non-Irr Class *c	Irr Class *c	SRPG	*n NCCPI Overall
7280	Tomek silt loam, 0 to 2 percent slopes	70.73	69.0%		Iw	Iw	77	75
7340	Filbert silt loam, 0 to 1 percent slopes	18.55	18.1%		IIw	IIw	60	49
7644	Yutan silty clay loam, 6 to 11 percent slopes, eroded	8.59	8.4%		IIIe	IVe	65	62
7750	Nodaway silt loam, occasionally flooded	3.97	3.9%		IIw	IIw	74	94
7156	Aksarben silty clay loam, terrace, 1 to 3 percent slopes	0.69	0.7%		Ile	IIIe	72	67
Weighted Average							72.8	*n 69.9

*n: The aggregation method is "Weighted Average using all components"

*c: Using Capabilities Class Dominant Condition Aggregation Method

Soils data provided by USDA and NRCS.