

# Tillable Soils Map

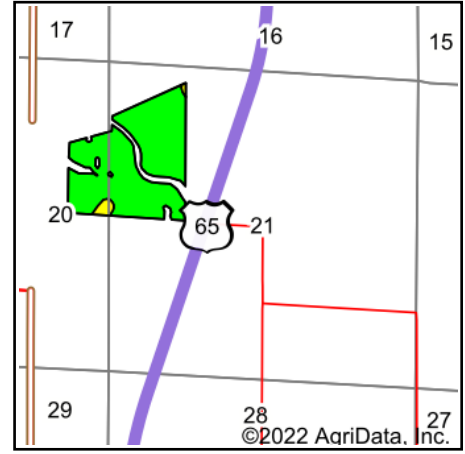

Soils data provided by USDA and NRCS.



State: **Iowa**  
 County: **Polk**  
 Location: **21-78N-23W**  
 Township: **Allen**  
 Acres: **74.56**  
 Date: **2/24/2022**



Maps Provided By:



© AgriData, Inc. 2021

www.AgriDataInc.com



Area Symbol: IA153, Soil Area Version: 23

Code	Soil Description	Acres	Percent of field	CSR2 Legend	Non-Irr Class *c	*i Corn Bu	*i Soybeans Bu	CSR2**	CSR	*n NCCPI Overall
1820	Dockery-Quiver silt loams, 0 to 2 percent slopes, occasionally flooded	72.71	97.5%	<span style="background-color: #00ff00; border: 1px solid black; display: inline-block; width: 15px; height: 15px;"></span>	llw			87		94
208	Klum fine sandy loam, 0 to 2 percent slopes, occasionally flooded	1.85	2.5%	<span style="background-color: #ffff00; border: 1px solid black; display: inline-block; width: 15px; height: 15px;"></span>	lls	169.6	49.2	70	55	90
<b>Weighted Average</b>						<b>2.00</b>	<b>4.2</b>	<b>1.2</b>	<b>86.6</b>	<b>*- *n 93.9</b>

\*\*IA has updated the CSR values for each county to CSR2.

\*- CSR weighted average cannot be calculated on the current soils data, use prior data version for csr values.

\*i Yield data provided by the ISPAID Database version 8.1.1 developed by IA State University.

\*n: The aggregation method is "Weighted Average using all components"

\*c: Using Capabilities Class Dominant Condition Aggregation Method

Soils data provided by USDA and NRCS.