

Soils Map

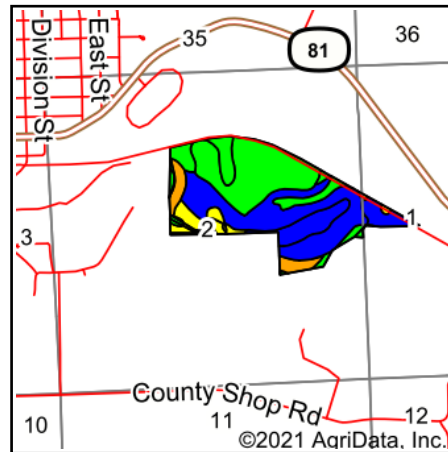

State: **Wisconsin**
 County: **Lafayette**
 Location: **2-2N-3E**
 Township: **Darlington**
 Acres: **122.67**
 Date: **8/30/2021**

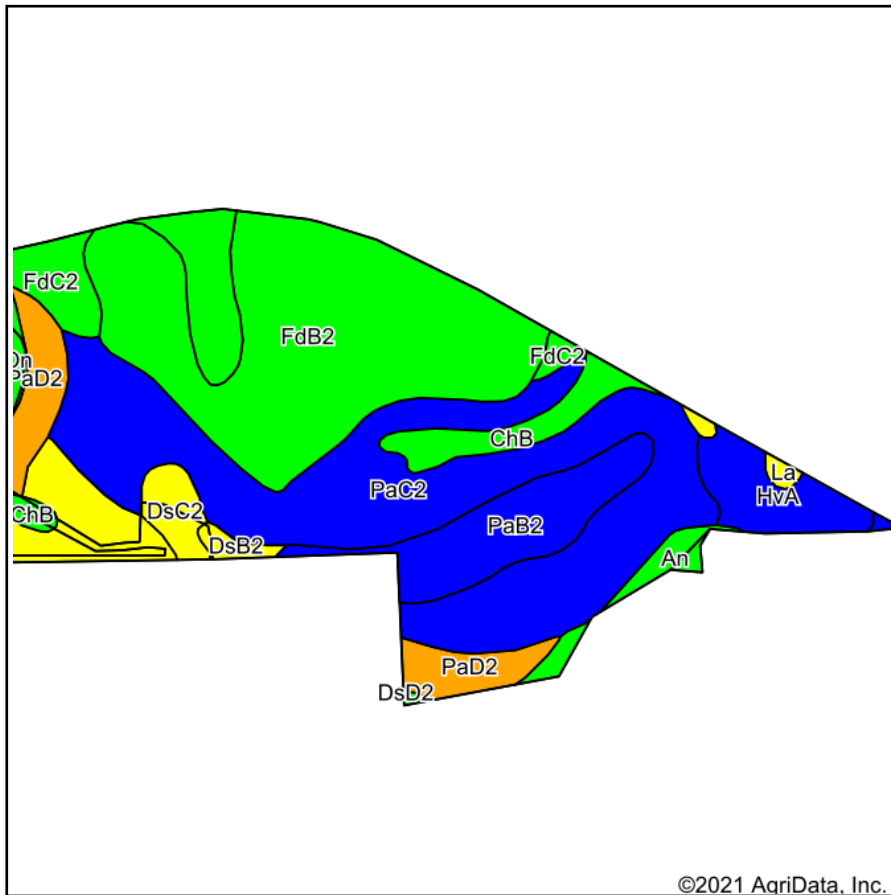

Maps Provided By:



Soils data provided by USDA and NRCS.

©2021 AgriData, Inc.

© AgriData, Inc. 2021

www.AgriDataInc.com

Area Symbol: WI065, Soil Area Version: 17

Code	Soil Description	Acres	Percent of field	NCCPI Overall Legend	Non-Irr Class *c	*n NCCPI Overall
PaC2	Palsgrove silt loam, 6 to 12 percent slopes, moderately eroded	40.09	32.7%		IIIe	74
FdB2	Fayette silt loam, 2 to 6 percent slopes, moderately eroded	35.89	29.3%		IIe	86
PaB2	Palsgrove silt loam, 2 to 6 percent slopes, moderately eroded	9.35	7.6%		IIe	76
FdC2	Fayette silt loam, 6 to 12 percent slopes, moderately eroded	8.43	6.9%		IIIe	83
PaD2	Palsgrove silt loam, 12 to 20 percent slopes, moderately eroded	6.65	5.4%		IVe	68
DsD2	Newglarus silt loam, moderately deep, 12 to 20 percent slopes, moderately eroded	5.48	4.5%		IVe	51
HvA	Huntsville silt loam, 0 to 2 percent slopes	5.32	4.3%		IIw	80
ChB	Chaseburg silt loam, moderately well drained, 2 to 6 percent slopes	4.65	3.8%		IIw	85
DsC2	Newglarus silt loam, moderately deep, 6 to 12 percent slopes, moderately eroded	2.30	1.9%		IIIe	56
An	Arenzville silt loam, 0 to 3 percent slopes, occasionally flooded	2.23	1.8%		IIw	88
DsB2	Newglarus silt loam, moderately deep, 2 to 6 percent slopes, moderately eroded	0.80	0.7%		IIe	57
On	Orion silt loam, 0 to 3 percent slopes, occasionally flooded	0.80	0.7%		IIw	90
La	Lawson silt loam	0.68	0.6%		IIIw	60
Weighted Average						*n 77.4

*n: The aggregation method is "Weighted Average using all components"

*c: Using Capabilities Class Dominant Condition Aggregation Method

Soils data provided by USDA and NRCS.