

FSA Tillable Soils Map

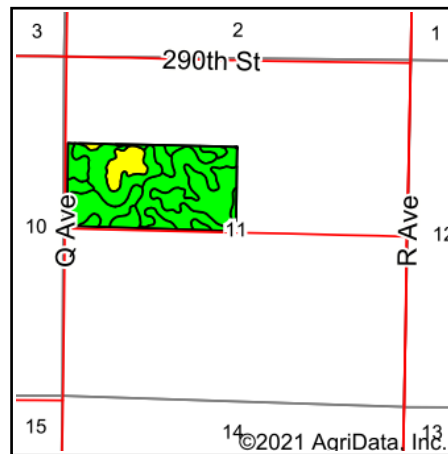

State: **Iowa**
 County: **Greene**
 Location: **11-82N-30W**
 Township: **Franklin**
 Acres: **76.22**
 Date: **9/21/2021**

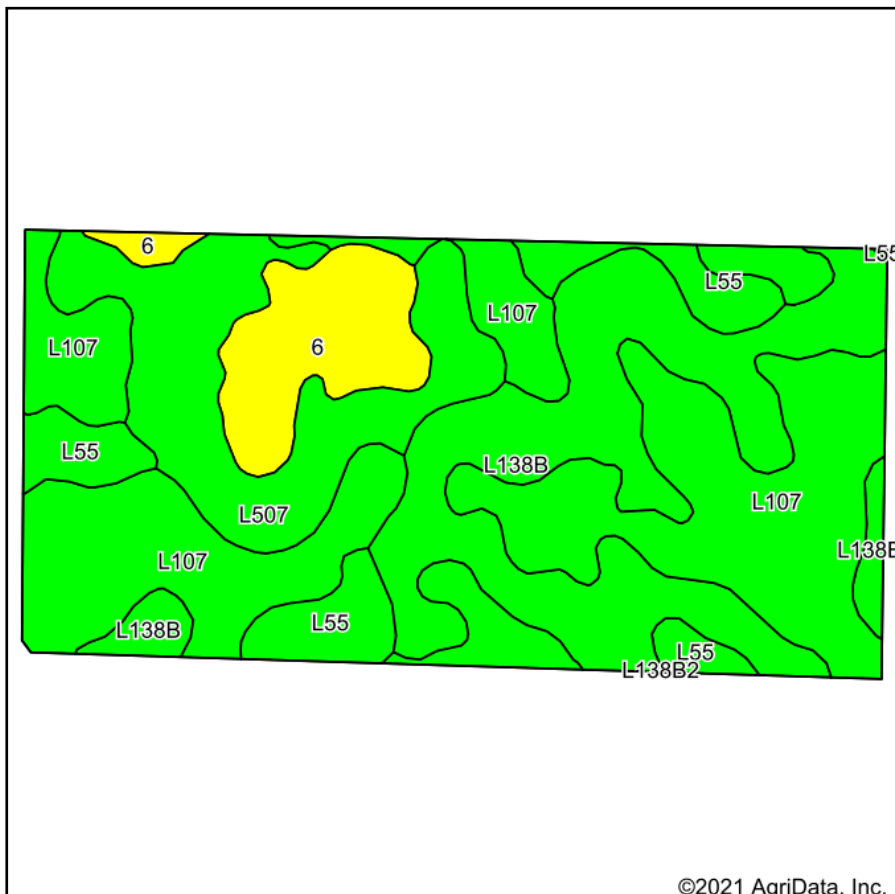

Maps Provided By:



Soils data provided by USDA and NRCS.

©2021 AgriData, Inc.

© AgriData, Inc. 2021

www.AgriDataInc.com

Area Symbol: IA073, Soil Area Version: 26

Code	Soil Description	Acres	Percent of field	CSR2 Legend	Non-Irr Class *c	*i Corn	*i Soybeans	CSR2**	CSR	*n NCCPI Overall
L107	Webster clay loam, Bemis moraine, 0 to 2 percent slopes	31.05	40.7%		Ilw	0	0	88		84
L138B	Clarion loam, Bemis moraine, 2 to 6 percent slopes	19.94	26.2%		Ile	220.8	64	88		80
L507	Canisteo clay loam, Bemis moraine, 0 to 2 percent slopes	12.07	15.8%		Ilw	0	0	87		81
L55	Nicollet loam, 1 to 3 percent slopes	6.58	8.6%		Ie	0	0	91		85
6	Okoboji silty clay loam, 0 to 1 percent slopes	6.58	8.6%		Illw	185.6	53.8	59	58	76
Weighted Average						73.8	21.4	85.6	*-	*n 81.9

**IA has updated the CSR values for each county to CSR2.

*- CSR weighted average cannot be calculated on the current soils data, use prior data version for csr values.

*i Yield data provided by the ISPAID Database version 8.1.1 developed by IA State University.

*n: The aggregation method is "Weighted Average using all components"

*c: Using Capabilities Class Dominant Condition Aggregation Method

Soils data provided by USDA and NRCS.