

# Soils Map

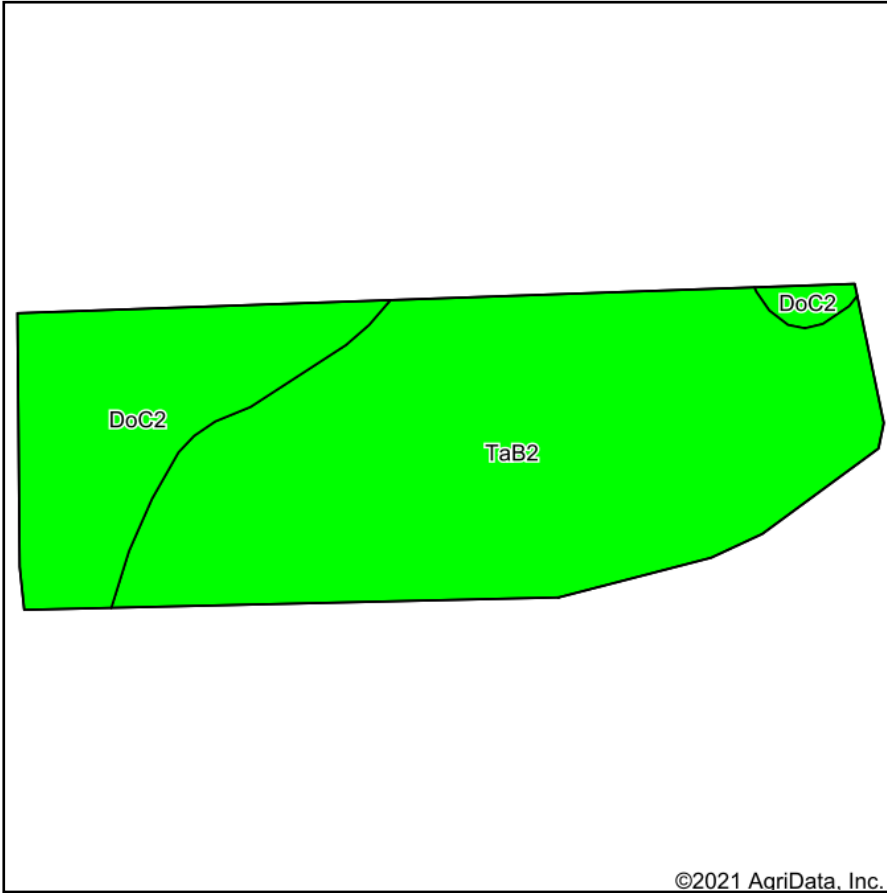

Soils data provided by USDA and NRCS.

©2021 AgriData, Inc.

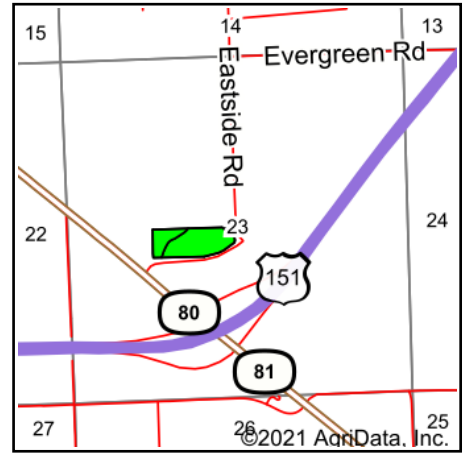

State: **Wisconsin**  
 County: **Grant**  
 Location: **23-3N-1W**  
 Township: **Platteville**  
 Acres: **12.16**  
 Date: **9/7/2021**



Maps Provided By:



© AgriData, Inc. 2021

www.AgriDataInc.com



Area Symbol: WI043, Soil Area Version: 15

Code	Soil Description	Acres	Percent of field	NCCPI Overall Legend	Non-Irr Class *c	*n NCCPI Overall
TaB2	Tama silt loam, driftless, 2 to 6 percent slopes, moderately eroded	9.07	74.6%		IIe	89
DoC2	Downs silt loam, 6 to 12 percent slopes, moderately eroded	3.09	25.4%		IIIe	85
<b>Weighted Average</b>						<b>*n 88</b>

\*n: The aggregation method is "Weighted Average using all components"

\*c: Using Capabilities Class Dominant Condition Aggregation Method

Soils data provided by USDA and NRCS.