

Soils Map - Tillable Acres

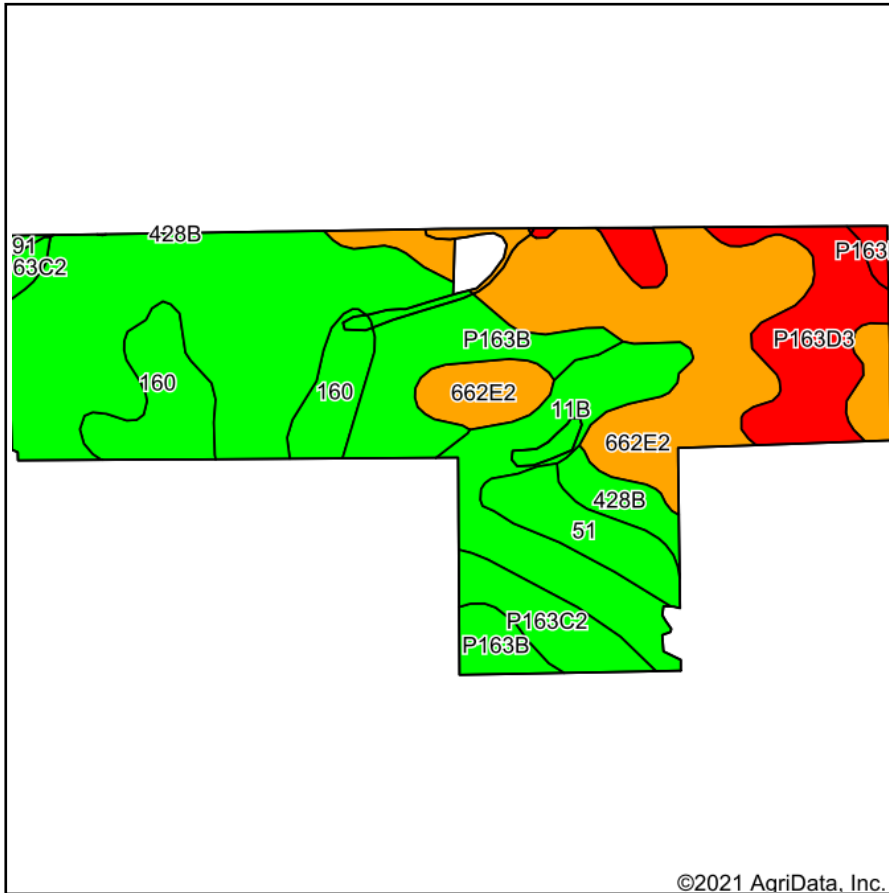

Soils data provided by USDA and NRCS.

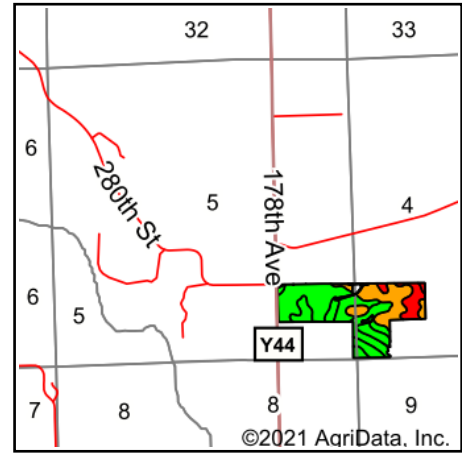

State: **Iowa**
 County: **Clinton**
 Location: **5-80N-2E**
 Township: **Olive**
 Acres: **49.31**
 Date: **9/20/2021**



Maps Provided By:



Area Symbol: IA045, Soil Area Version: 26

Code	Soil Description	Acres	Percent of field	CSR2 Legend	Non-Irr Class *c	*i Corn	*i Alfalfa	*i Soybeans	CSR2**	*n NCCPI Corn	*n NCCPI Soybeans
P163B	Fayette silt loam, paha, 2 to 5 percent slopes	17.35	35.2%		Ile	0	0	0	83	86	77
662E2	Mt. Carroll silt loam, 14 to 18 percent slopes, moderately eroded	12.13	24.6%		IVe	153.6	4.3	44.5	43	76	63
11B	Colo-Ely complex, 0 to 5 percent slopes	5.37	10.9%		IIw	204.8	4.3	59.4	86	92	76
P163D3	Fayette silty clay loam, paha, 9 to 14 percent slopes, severely eroded	4.59	9.3%		IVe	0	0	0	40	69	55
160	Walford silt loam, 0 to 1 percent slopes	4.00	8.1%		IIIw	216	4.5	62.6	85	91	82
P163C2	Fayette silt loam, paha, 5 to 9 percent slopes, eroded	2.26	4.6%		IIIe	0	0	0	75	80	68
51	Vesser silt loam, 0 to 2 percent slopes	2.14	4.3%		IIw	198.4	4.2	57.5	74	80	87
428B	Ely silt loam, 2 to 5 percent slopes	1.09	2.2%		Ile	220.8	5.7	64	87	94	86
P163E3	Fayette silty clay loam, paha, 14 to 18 percent slopes, severely eroded	0.28	0.6%		VIe	0	0	0	28	66	51
291	Atterberry silt loam, 1 to 3 percent slopes	0.10	0.2%		Ile	224	5.8	65	85	98	97
Weighted Average						91.6	2.2	26.5	68.7	*n 82.6	*n 71.9

**IA has updated the CSR values for each county to CSR2.

*i Yield data provided by the ISPAID Database version 8.1.1 developed by IA State University.

*n: The aggregation method is "Weighted Average using all components"

*c: Using Capabilities Class Dominant Condition Aggregation Method

Soils data provided by USDA and NRCS.