

# Soils Map - Total Acres

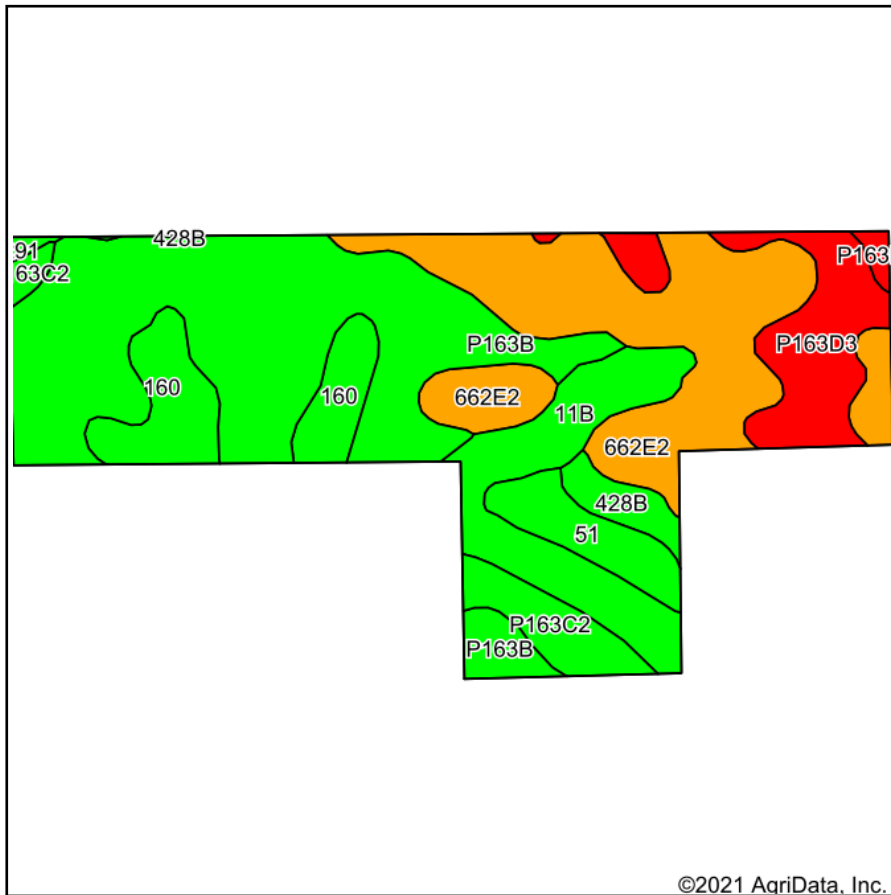

Soils data provided by USDA and NRCS.

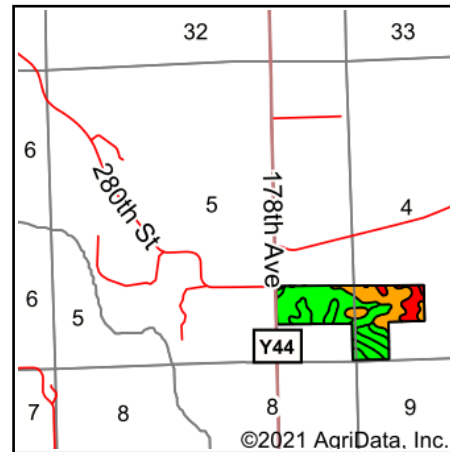

State: **Iowa**  
 County: **Clinton**  
 Location: **5-80N-2E**  
 Township: **Olive**  
 Acres: **50**  
 Date: **9/20/2021**



Maps Provided By:



© AgriData, Inc. 2021

www.AgriDataInc.com



Area Symbol: IA045, Soil Area Version: 26

Code	Soil Description	Acres	Percent of field	CSR2 Legend	Non-Irr Class *c	*i Corn	*i Alfalfa	*i Soybeans	CSR2**	*n NCCPI Corn	*n NCCPI Soybeans
P163B	Fayette silt loam, paha, 2 to 5 percent slopes	17.56	35.1%		Ile	0	0	0	83	86	77
662E2	Mt. Carroll silt loam, 14 to 18 percent slopes, moderately eroded	12.50	25.0%		IVe	153.6	4.3	44.5	43	76	63
11B	Colo-Ely complex, 0 to 5 percent slopes	5.49	11.0%		IIw	204.8	4.3	59.4	86	92	76
P163D3	Fayette silty clay loam, paha, 9 to 14 percent slopes, severely eroded	4.56	9.1%		IVe	0	0	0	40	69	55
160	Walford silt loam, 0 to 1 percent slopes	3.99	8.0%		IIIw	216	4.5	62.6	85	91	82
P163C2	Fayette silt loam, paha, 5 to 9 percent slopes, eroded	2.28	4.6%		IIIe	0	0	0	75	80	68
51	Vesser silt loam, 0 to 2 percent slopes	2.12	4.2%		IIw	198.4	4.2	57.5	74	80	87
428B	Ely silt loam, 2 to 5 percent slopes	1.07	2.1%		Ile	220.8	5.7	64	87	94	86
P163E3	Fayette silty clay loam, paha, 14 to 18 percent slopes, severely eroded	0.26	0.5%		VIe	0	0	0	28	66	51
291	Atterberry silt loam, 1 to 3 percent slopes	0.17	0.3%		Ile	224	5.8	65	85	98	97
<b>Weighted Average</b>						<b>92</b>	<b>2.2</b>	<b>26.7</b>	<b>68.6</b>	<b>*n 82.6</b>	<b>*n 71.9</b>

\*\*IA has updated the CSR values for each county to CSR2.

\*i Yield data provided by the ISPAID Database version 8.1.1 developed by IA State University.

\*n: The aggregation method is "Weighted Average using all components"

\*c: Using Capabilities Class Dominant Condition Aggregation Method

Soils data provided by USDA and NRCS.