

Soils Map

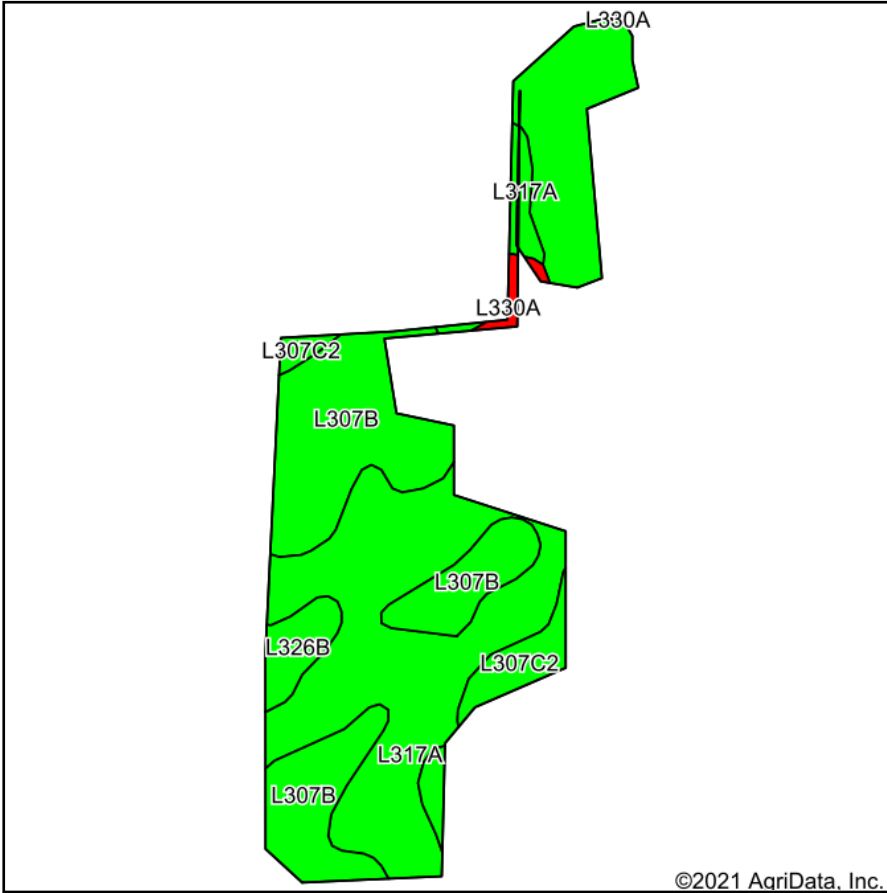

©2021 AgriData, Inc.

Soils data provided by USDA and NRCS.

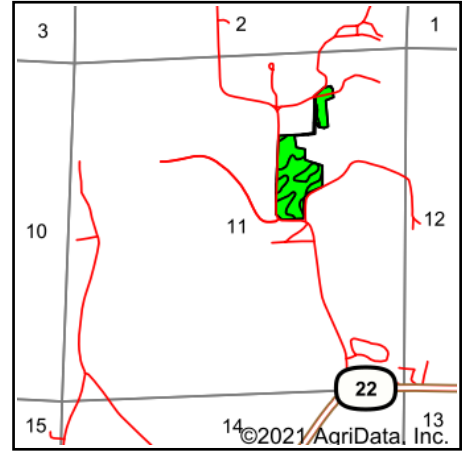

State: **Minnesota**
 County: **Stearns**
 Location: **11-122N-31W**
 Township: **Eden Lake**
 Acres: **18**
 Date: **9/19/2021**



Maps Provided By:



© AgriData, Inc. 2021

www.AgrIDataInc.com



Area Symbol: MN145, Soil Area Version: 18

Code	Soil Description	Acres	Percent of field	NCCPI Overall Legend	Non-Irr Class *c	Productivity Index	Corn	Soybeans	*n NCCPI Overall	*n NCCPI Corn	*n NCCPI Soybeans
L307B	Koronis loam, 2 to 6 percent slopes	8.67	48.2%		Ile	88			76	76	74
L317A	Barry loam, 0 to 2 percent slopes	7.69	42.7%		Ilw	87	159	48	82	82	78
L307C2	Koronis loam, 6 to 10 percent slopes, moderately eroded	0.83	4.6%		Ille	77			72	71	65
L326B	Rohrbeck-Koronis complex, 1 to 6 percent slopes	0.65	3.6%		Ills	78	143	43	72	72	55
L330A	Muskego, Blue Earth and Houghton soils, lundlake catena, 0 to 1 percent slopes, ponded	0.16	0.9%		Vlllw	5			6	2	2
Weighted Average						86	73.1	22.1	*n 77.6	*n 77.5	*n 74

*n: The aggregation method is "Weighted Average using all components"

*c: Using Capabilities Class Dominant Condition Aggregation Method

Soils data provided by USDA and NRCS.