



Summary

Parcel ID 213100224203
Property Address 3691 85TH ST NE
 MONTICELLO
Sec/Twp/Rng 22-121-025
Brief Sect-22 Twp-121 Range-025 UNPLATTED LAND MONTICELLO TWP2 21.91 AC NW1/4 OF SE1/4 LY SELY OF SELY R/W LN OF MN HWY25 EX THFR EX
Tax Description THFR S330FT OF W650.08FT THOF ALSO E208.52FT OF W650.08FT OF S330FT OF NW1/4 OF SE1/4 EX PARCEL 224A ON MNDOT R/W PLAT NO.86-128 (213-225-002241)
 (Note: Not to be used on legal documents)
Deeded Acres 21.91
Class 247 - (NON-HSTD) QUALIFY GOLF COURSES
District (2902) 2902 TOWN OF MONTICELLO 882 H
School District 0882
Creation Date 01/01/0001
 Note: Class refers to Assessor's Classification Used For Property Tax Purposes

Valuation

	2021 Assessment	2020 Assessment	2019 Assessment	2018 Assessment	2017 Assessment
+ Estimated Land Value	\$253,600	\$253,600	\$253,600	\$253,600	\$253,600
+ Estimated Building Value	\$38,700	\$38,700	\$43,500	\$43,200	\$44,700
+ Estimated Machinery Value	\$0	\$0	\$0	\$0	\$0
= Total Estimated Market Value	\$292,300	\$292,300	\$297,100	\$296,800	\$298,300

Taxation

	2021 Payable	2020 Payable	2019 Payable	2018 Payable
Estimated Market Value	\$292,300	\$297,100	\$296,800	\$298,300
- Excluded Value	\$0	\$0	\$0	\$0
- Homestead Exclusion	\$0	\$0	\$0	\$0
= Taxable Market Value	\$292,300	\$297,100	\$296,800	\$298,300
Net Taxes Due	\$3,420.00	\$3,544.00	\$3,682.00	\$3,498.00
+ Special Assessments	\$0.00	\$0.00	\$0.00	\$0.00
= Total Taxes Due	\$3,420.00	\$3,544.00	\$3,682.00	\$3,498.00
% Change	-3.50%	-3.75%	5.26%	-3.90%

Taxes Paid

Receipt #	Receipt Print Date	Bill Pay Year	Amt Adj	Amt Write Off	Amt Charge	Amt Payment
1710022	5/21/2021	2021	\$0.00	\$0.00	\$0.00	(\$9.90)
1689477	5/10/2021	2021	\$0.00	\$0.00	\$0.00	\$1,710.00
1689759	5/10/2021	2021	\$0.00	\$0.00	\$0.00	(\$1,700.10)
1656055	10/15/2020	2020	\$0.00	\$0.00	\$0.00	(\$1,772.00)
1616564	5/12/2020	2020	\$0.00	\$0.00	\$0.00	(\$1,772.00)
1573262	10/10/2019	2019	\$0.00	\$0.00	\$0.00	(\$1,841.00)
1545933	5/15/2019	2019	\$0.00	\$0.00	\$0.00	(\$1,841.00)
1500349	10/15/2018	2018	\$0.00	\$0.00	\$0.00	(\$1,749.00)
1463816	5/15/2018	2018	\$0.00	\$0.00	\$0.00	(\$1,749.00)
1426868	10/18/2017	2017	\$0.00	\$0.00	\$0.00	(\$1,820.00)
1392201	5/15/2017	2017	\$0.00	\$0.00	\$0.00	(\$1,820.00)
1326247	10/13/2016	2016	\$0.00	\$0.00	\$0.00	(\$1,861.00)
1289310	5/16/2016	2016	\$0.00	\$0.00	\$0.00	(\$1,861.00)

Sketches

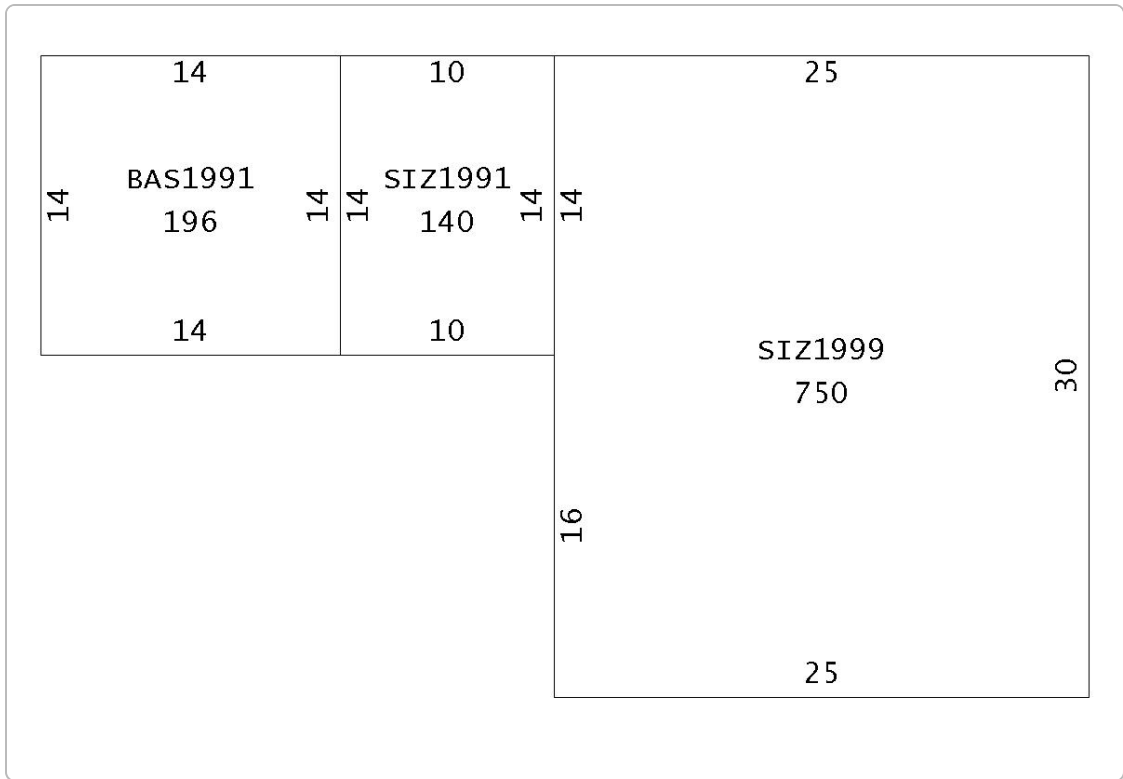
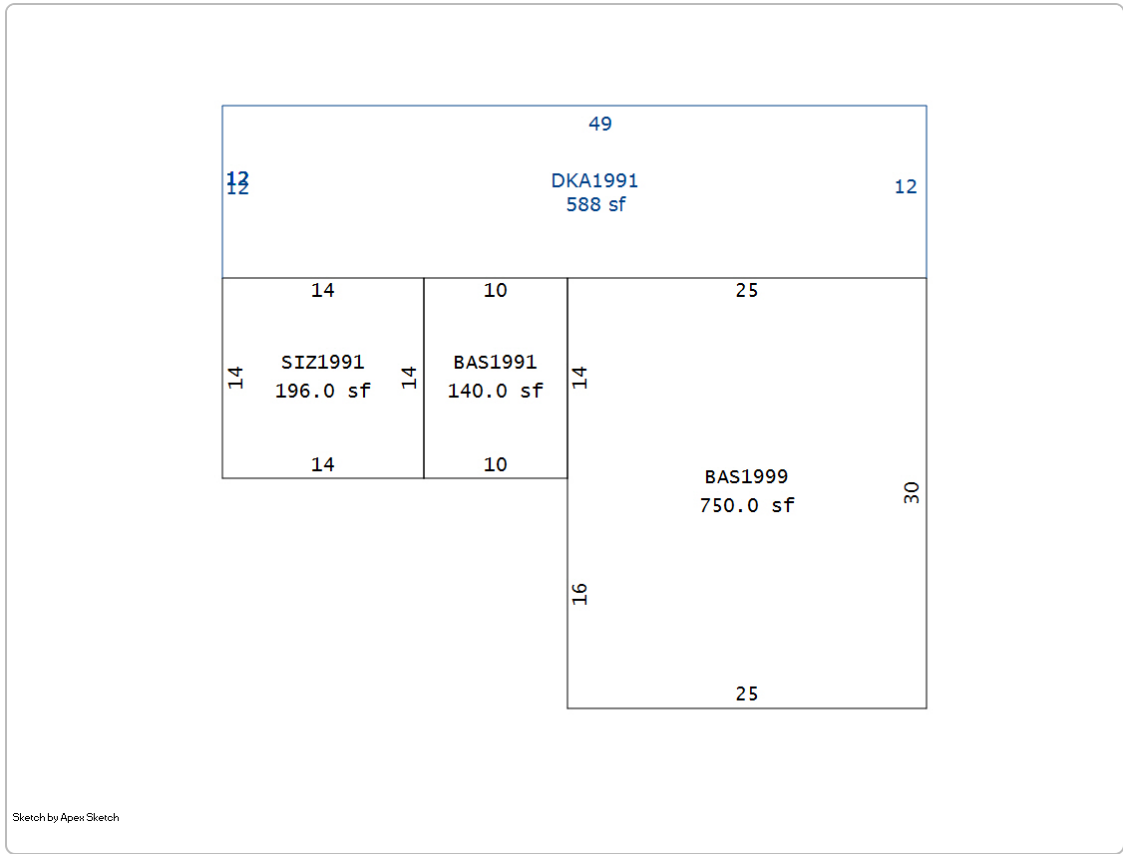

Map



The information provided on this site is intended for reference purposes only. The information is not suitable for legal, engineering, or surveying purposes. Wright County does not guarantee the accuracy of the information contained herein.

[User Privacy Policy](#)
[GDPR Privacy Notice](#)

[Last Data Upload: 8/3/2021, 6:50:48 AM](#)

Developed by
 Schneider
GEOSPATIAL

Version 2.3.137