

# Current Row Crop Tillable Map

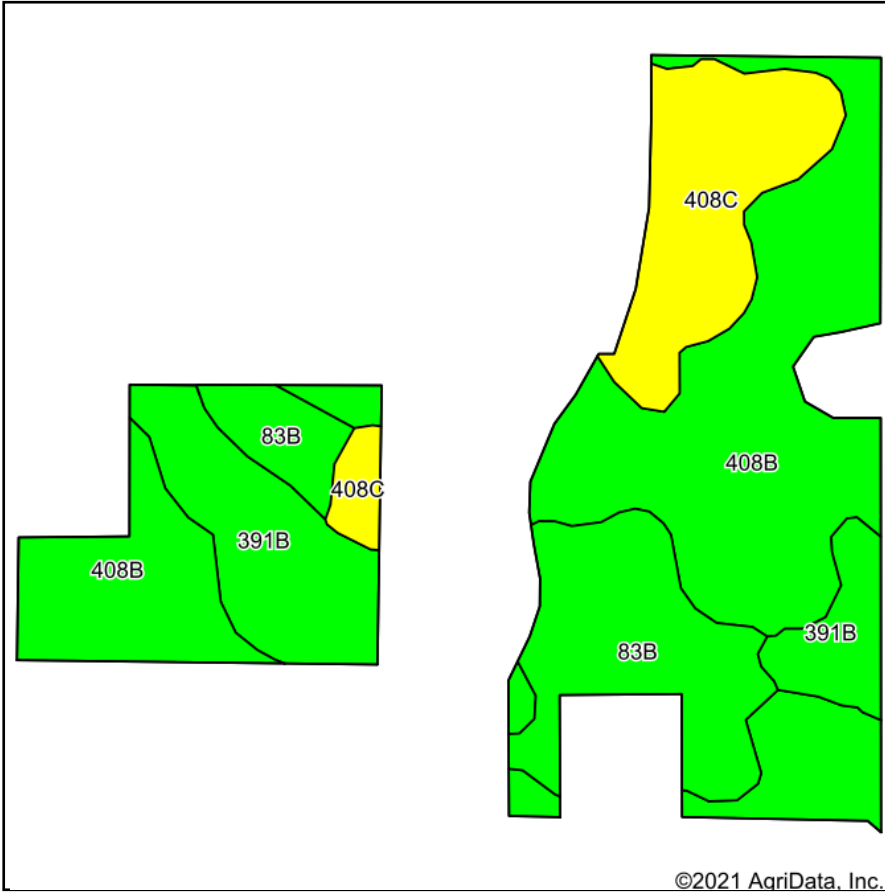

Soils data provided by USDA and NRCS.

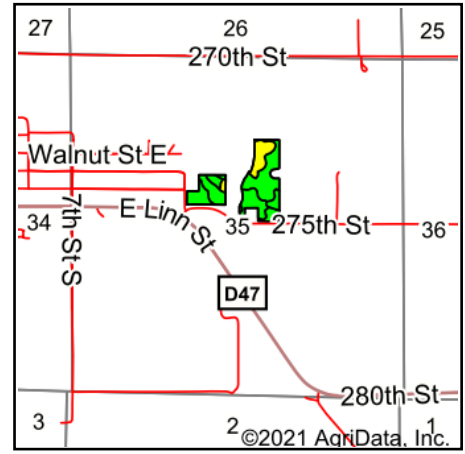

State: **Iowa**  
 County: **Buchanan**  
 Location: **35-88N-8W**  
 Township: **Liberty**  
 Acres: **19.37**  
 Date: **10/27/2021**



Maps Provided By:



© AgriData, Inc. 2021

www.AgriDataInc.com



Area Symbol: IA019, Soil Area Version: 26

Code	Soil Description	Acres	Percent of field	CSR2 Legend	Non-Irr Class *c	CSR2**	*n NCCPI Overall	
408B	Olin fine sandy loam, 2 to 5 percent slopes	9.32	48.1%		Ile	74	77	
83B	Kenyon loam, 2 to 5 percent slopes	3.53	18.2%		Ile	90	90	
391B	Clyde-Floyd complex, 1 to 4 percent slopes	3.39	17.5%		IIw	87	88	
408C	Olin fine sandy loam, 5 to 9 percent slopes	3.13	16.2%		IIIe	65	75	
<b>Weighted Average</b>						<b>2.16</b>	<b>77.7</b>	<b>*n 81</b>

\*\*IA has updated the CSR values for each county to CSR2.

\*n: The aggregation method is "Weighted Average using all components"

\*c: Using Capabilities Class Dominant Condition Aggregation Method

Soils data provided by USDA and NRCS.