

Tillable Soils Map

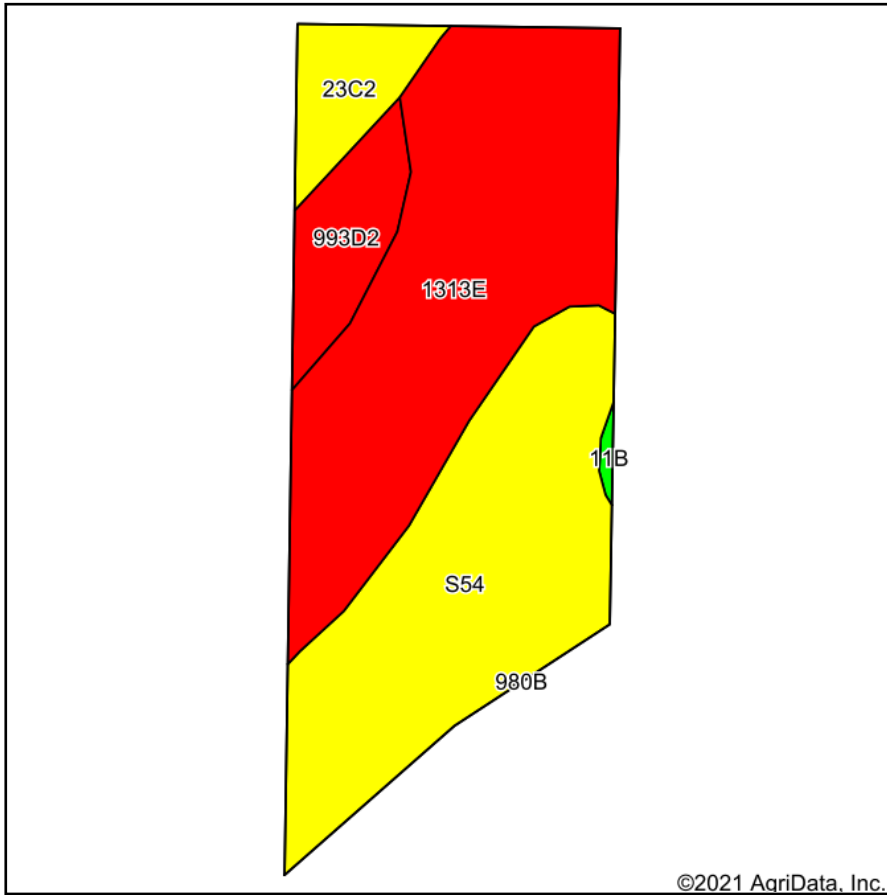

Soils data provided by USDA and NRCS.

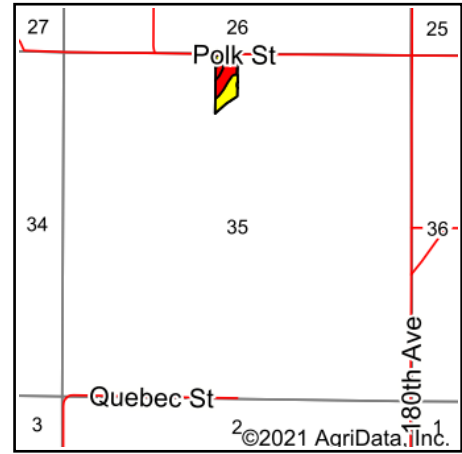

State: **Iowa**
 County: **Warren**
 Location: **35-75N-23W**
 Township: **Otter**
 Acres: **5.82**
 Date: **10/27/2021**



Maps Provided By:



Area Symbol: IA181, Soil Area Version: 25

Code	Soil Description	Acres	Percent of field	CSR2 Legend	Non-Irr Class *c	CSR2**	CSR	
1313E	Munterville silt loam, 14 to 18 percent slopes	2.72	46.7%		VIIe	25	10	
S54	Zook silty clay loam, heavy till, 0 to 2 percent slopes, occasionally flooded	2.26	38.8%		IIw	68		
993D2	Armstrong-Gara loams, 9 to 14 percent slopes, moderately eroded	0.46	7.9%		IVe	23	20	
23C2	Arispe silty clay loam, 5 to 9 percent slopes, moderately eroded	0.38	6.5%		IIIe	62	62	
Weighted Average						4.56	44	*.

**IA has updated the CSR values for each county to CSR2.

*. CSR weighted average cannot be calculated on the current soils data, use prior data version for csr values.

*c: Using Capabilities Class Dominant Condition Aggregation Method

Soils data provided by USDA and NRCS.