

Soils Map

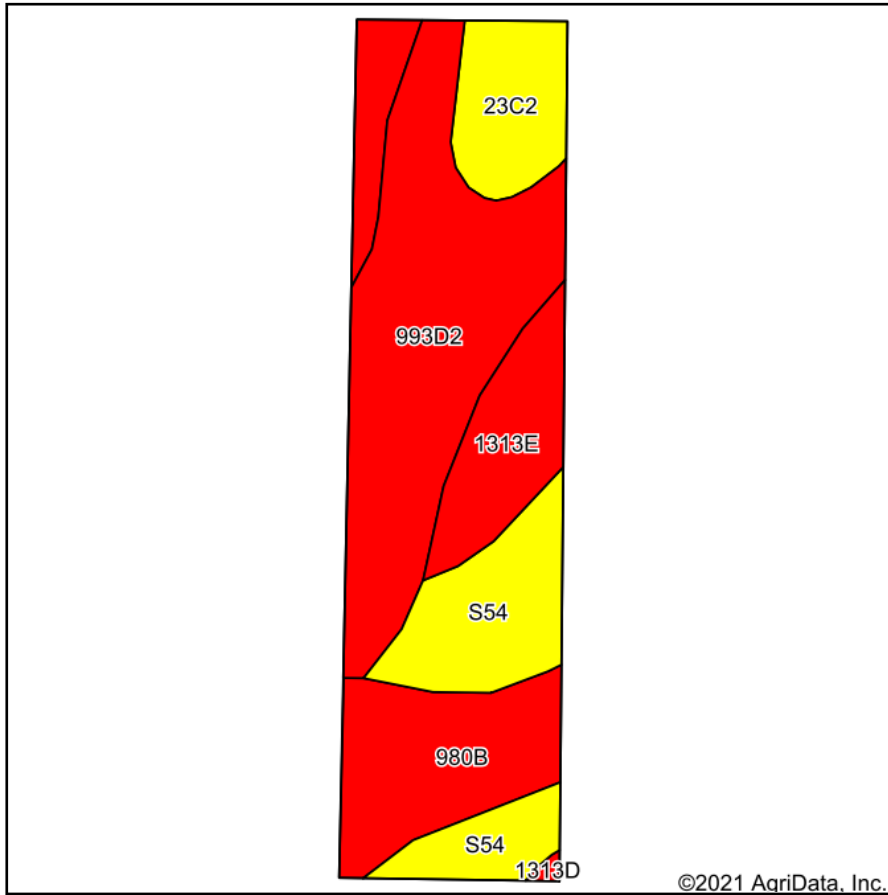

Soils data provided by USDA and NRCS.

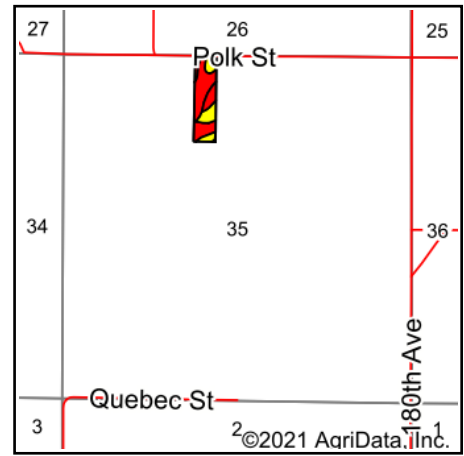

State: **Iowa**
 County: **Warren**
 Location: **35-75N-23W**
 Township: **Otter**
 Acres: **10**
 Date: **10/27/2021**



Maps Provided By:



Area Symbol: IA181, Soil Area Version: 25

Code	Soil Description	Acres	Percent of field	CSR2 Legend	Non-Irr Class *c	CSR2**	CSR
993D2	Armstrong-Gara loams, 9 to 14 percent slopes, moderately eroded	3.89	38.9%		IVe	23	20
980B	Gullied land-Ely-Colo, occasionally flooded, complex, 2 to 5 percent slopes	2.19	21.9%		VIIe	42	25
S54	Zook silty clay loam, heavy till, 0 to 2 percent slopes, occasionally flooded	1.85	18.5%		IIw	68	
1313E	Munterville silt loam, 14 to 18 percent slopes	1.09	10.9%		VIIe	25	10
23C2	Arispe silty clay loam, 5 to 9 percent slopes, moderately eroded	0.98	9.8%		IIIe	62	62
Weighted Average						4.52	39.5
							*-

**IA has updated the CSR values for each county to CSR2.

*- CSR weighted average cannot be calculated on the current soils data, use prior data version for csr values.

*c: Using Capabilities Class Dominant Condition Aggregation Method

Soils data provided by USDA and NRCS.