

# Heritage Hills

## PLAT 10 TOWNHOMES

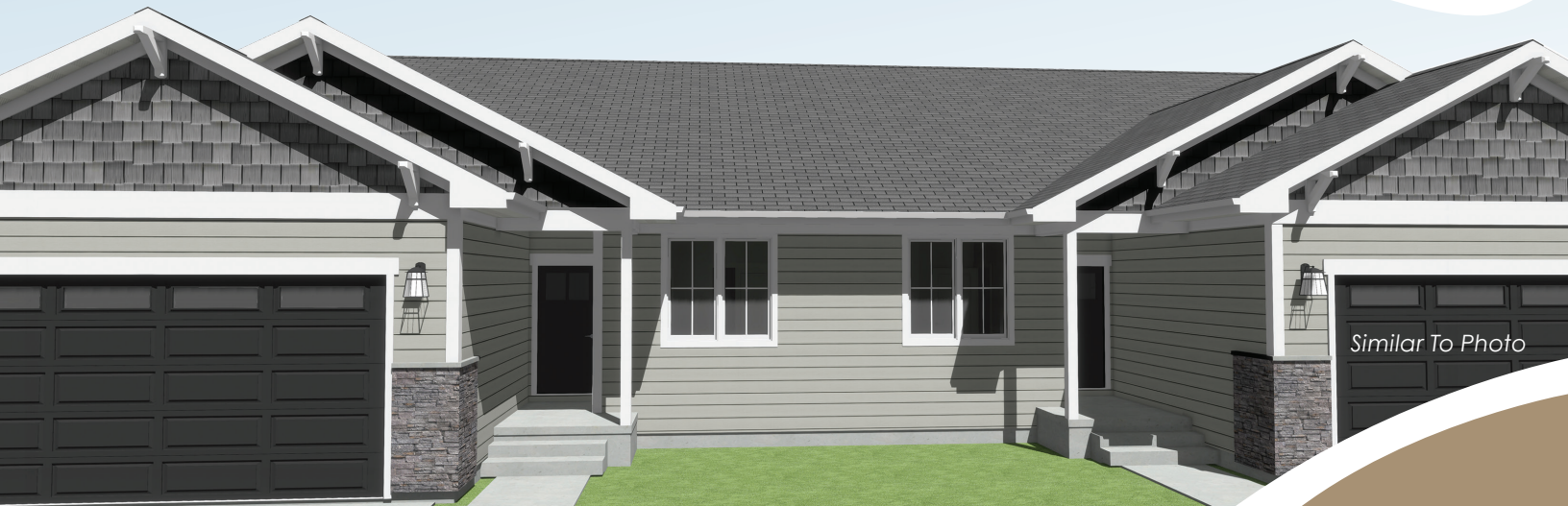

*Now Available*

**20 Ranch Townhomes**  
**2 Bed/2 Bath • 2 Floor Plan Options**

**GBH**

Built by **GROUND BREAKER** *homes*

GroundBreakerHomes.com  
 for more information

**New Era Plan: 1,418 SF**



**Legacy Plan: 1,467 SF**



Located on the north side of Indianola  
 with breathtaking views of the  
 Indianola Country Club

*Reserve your lot now!*

FOR MORE INFORMATION, CONTACT:



**Kalen Ludwig 515.402.3169**  
 Kalen@PeoplesCompany.com

**Keaton Dreher 515.650.1276**  
 Keaton@PeoplesCompany.com



# Heritage Hills

## PLAT 10 TOWNHOMES

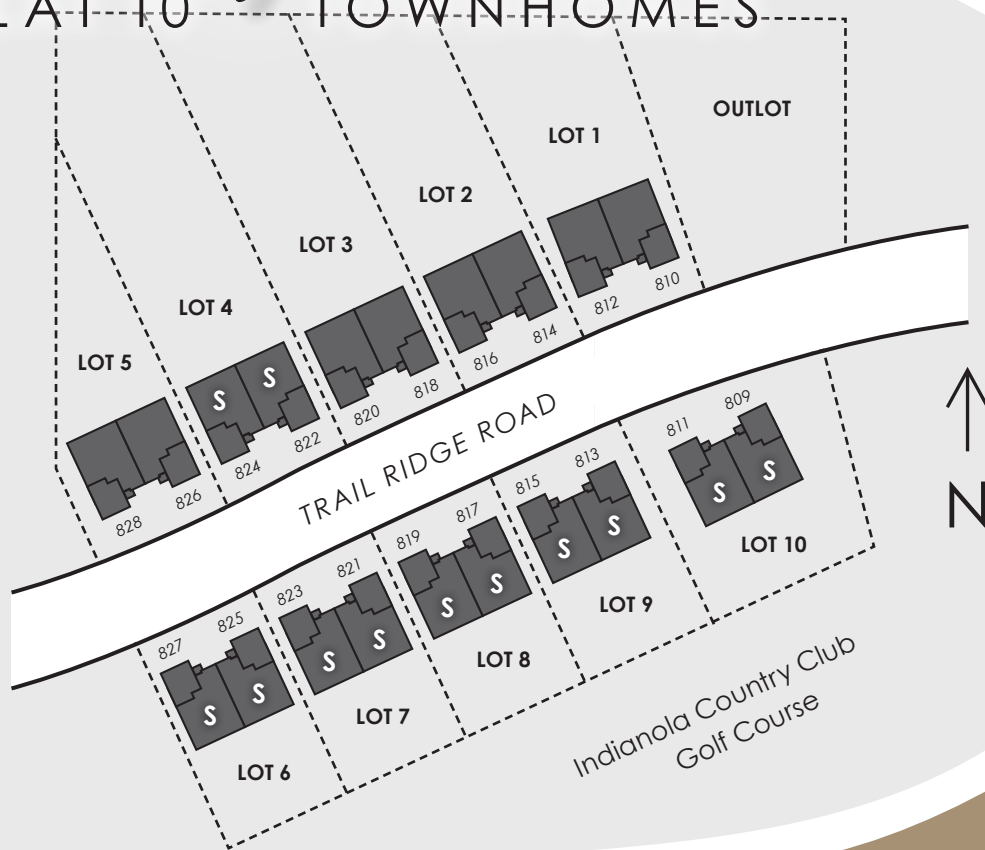

# GBH

Built by **GROUND BREAKER** *homes*

## Golf course lots available!

Please contact an agent for current pricing and options.

## Reserve your lot now!

FOR MORE INFORMATION, CONTACT:

**PEOPLES**  
COMPANY  
INNOVATIVE REAL ESTATE SOLUTIONS

**Kalen Ludwig 515.402.3169**  
[Kalen@PeoplesCompany.com](mailto:Kalen@PeoplesCompany.com)

**Keaton Dreher 515.650.1276**  
[Keaton@PeoplesCompany.com](mailto:Keaton@PeoplesCompany.com)

