

Soils Map

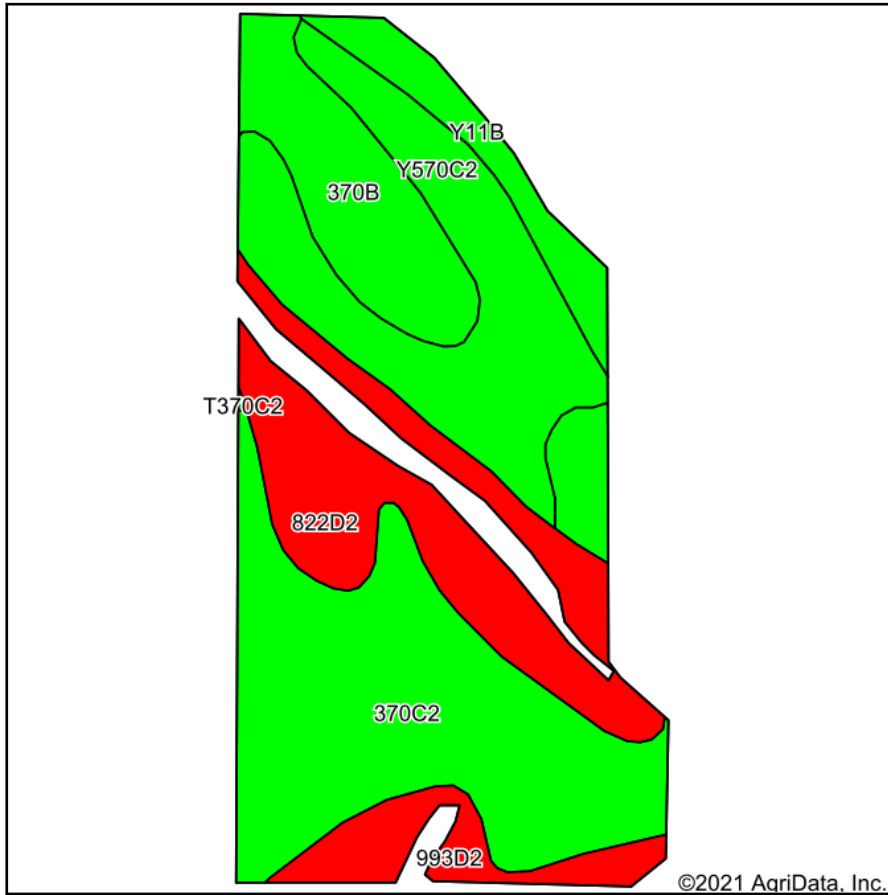

Soils data provided by USDA and NRCS.

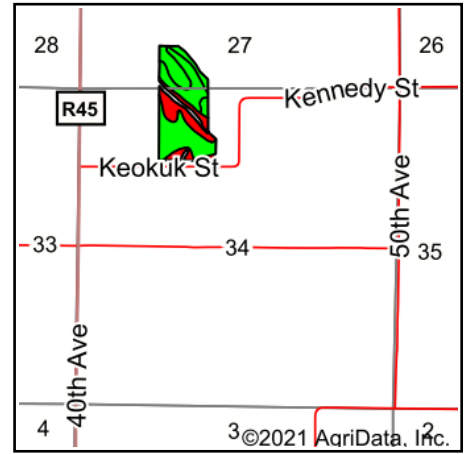

State: **Iowa**
 County: **Warren**
 Location: **34-76N-25W**
 Township: **Jefferson**
 Acres: **32.09**
 Date: **8/25/2021**

PC PEOPLES
 COMPANY
 INNOVATIVE. REAL ESTATE. SOLUTIONS.

Maps Provided By:

surety
 CUSTOMIZED ONLINE MAPPING
 © AgriData, Inc. 2021 www.AgriDataInc.com



Area Symbol: IA181, Soil Area Version: 25

Code	Soil Description	Acres	Percent of field	CSR2 Legend	Non-Irr Class *c	CSR2**	CSR
370C2	Sharpsburg silty clay loam, 5 to 9 percent slopes, eroded	11.35	35.4%		IIIe	80	67
Y570C2	Nira silty clay loam, dissected till plain, 5 to 9 percent slopes, eroded	6.90	21.5%		IIIe	81	
822D2	Lamoni silty clay loam, 9 to 14 percent slopes, eroded	6.33	19.7%		IVe	10	15
370B	Sharpsburg silty clay loam, 2 to 5 percent slopes	3.82	11.9%		Ile	91	87
993D2	Armstrong-Gara loams, 9 to 14 percent slopes, moderately eroded	1.87	5.8%		IVe	23	20
Y11B	Colo, occasionally flooded-Ely silty clay loams, dissected till plain, 2 to 5 percent slopes	1.82	5.7%		IIw	80	
Weighted Average						64.4	*-

**IA has updated the CSR values for each county to CSR2.

*- CSR weighted average cannot be calculated on the current soils data, use prior data version for csr values.

*c: Using Capabilities Class Dominant Condition Aggregation Method

Soils data provided by USDA and NRCS.