

Soils Map

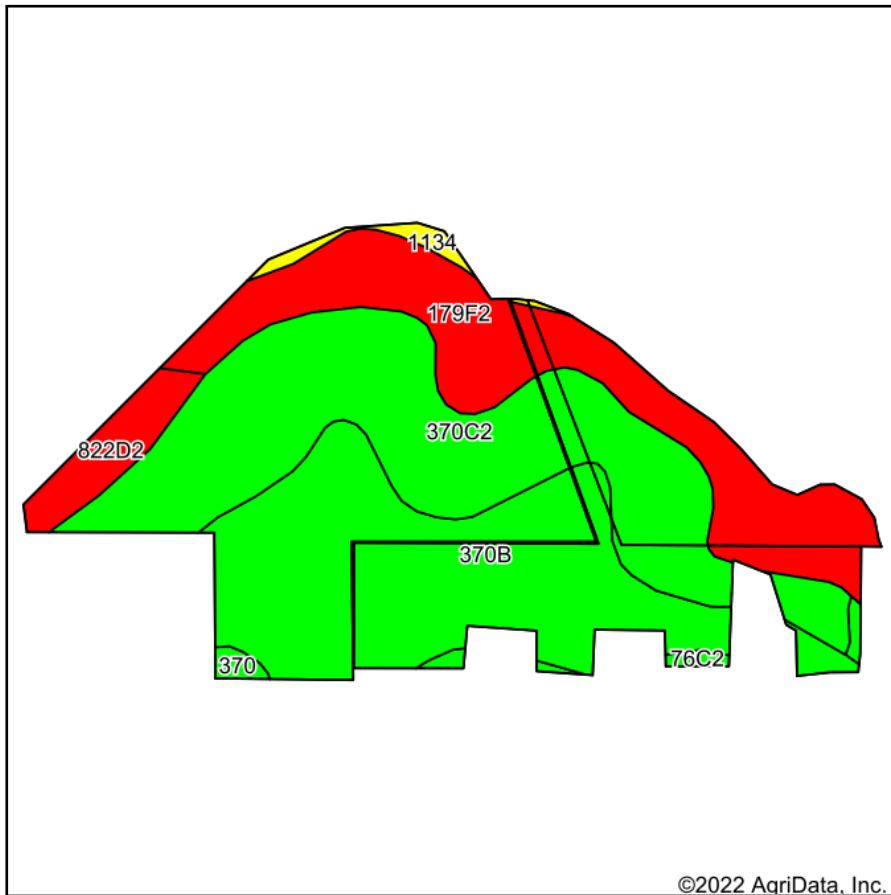

Soils data provided by USDA and NRCS.

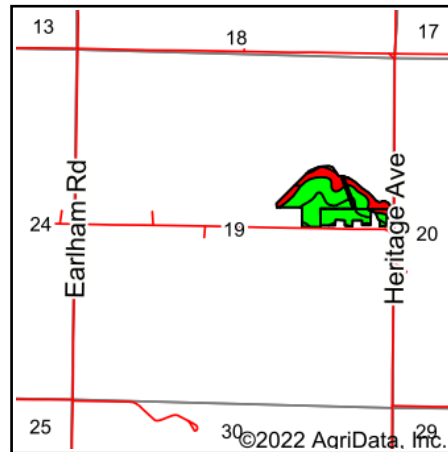

State: **Iowa**
 County: **Madison**
 Location: **19-76N-28W**
 Township: **Douglas**
 Acres: **21.15**
 Date: **1/19/2022**



Maps Provided By:



Area Symbol: IA121, Soil Area Version: 25

Code	Soil Description	Acres	Percent of field	CSR2 Legend	Non-Irr Class *c	CSR2**	*n NCCPI Overall	*n NCCPI Corn	*n NCCPI Small Grains	*n NCCPI Soybeans	
370C2	Sharpsburg silty clay loam, 5 to 9 percent slopes, eroded	7.70	36.4%		IIle	80	84	84	69	67	
370B	Sharpsburg silty clay loam, 2 to 5 percent slopes	7.11	33.6%		Ile	91	93	93	78	80	
179F2	Gara loam, dissected till plain, 18 to 25 percent slopes, eroded	4.84	22.9%		VIIle	16	57	57	36	38	
822D2	Lamoni clay loam, 9 to 14 percent slopes, eroded	0.89	4.2%		IVe	7	58	58	53	41	
1134	Colo, frequently flooded-Ely silty clay loams, gullied, 2 to 5 percent slopes	0.26	1.2%		Ile	59	45	7	7	45	
76C2	Ladoga silt loam, dissected till plain, 5 to 9 percent slopes, eroded	0.23	1.1%		IIle	75	78	78	69	66	
370	Sharpsburg silty clay loam, 0 to 2 percent slopes	0.12	0.6%		I	96	90	90	77	79	
Weighted Average						3.60	65.8	*n 79.2	*n 78.8	*n 63.1	*n 63.4

**IA has updated the CSR values for each county to CSR2.

*n: The aggregation method is "Weighted Average using all components"

*c: Using Capabilities Class Dominant Condition Aggregation Method

Soils data provided by USDA and NRCS.