

Soils Map

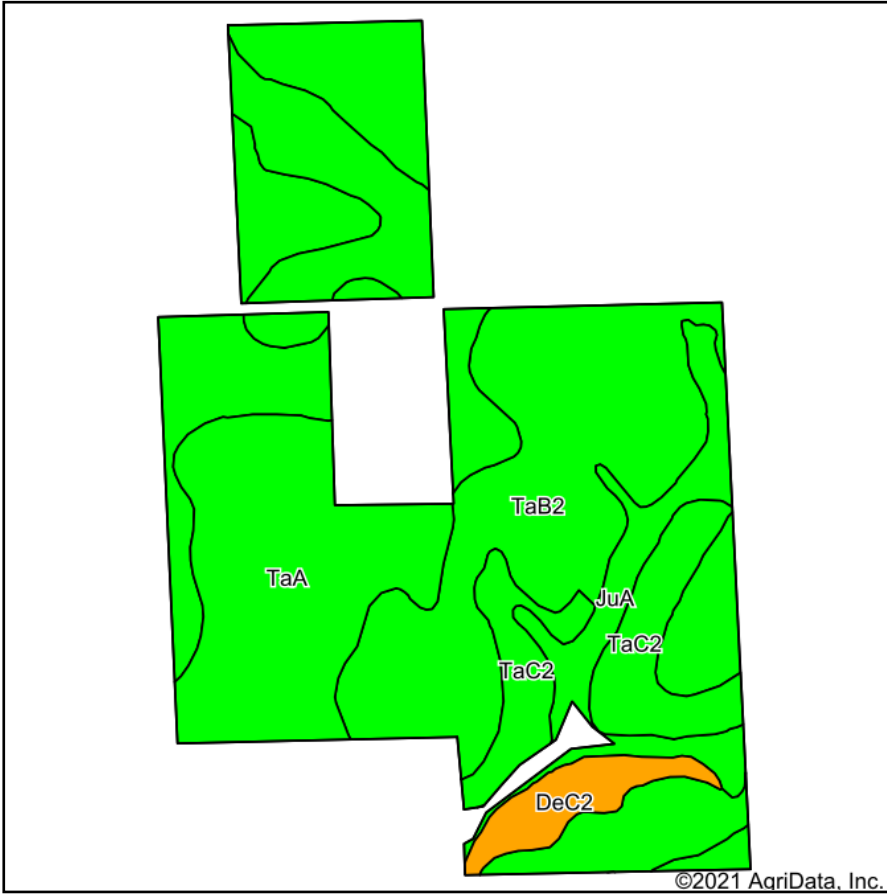

Soils data provided by USDA and NRCS.

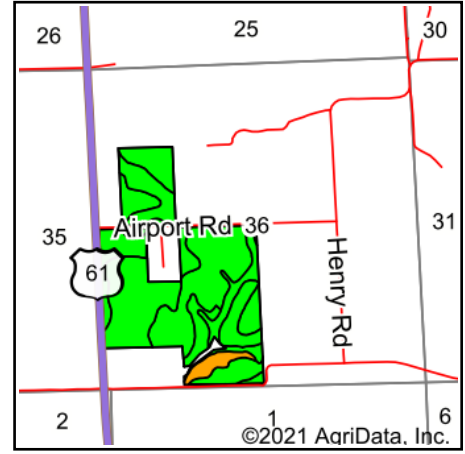

State: **Wisconsin**
 County: **Grant**
 Location: **36-4N-3W**
 Township: **South Lancaster**
 Acres: **149.98**
 Date: **10/19/2021**



Maps Provided By:



© AgriData, Inc. 2021

www.AgriDataInc.com



Area Symbol: WI043, Soil Area Version: 15

Code	Soil Description	Acres	Percent of field	NCCPI Overall Legend	Non-Irr Class *c	*n NCCPI Overall
TaB2	Tama silt loam, driftless, 2 to 6 percent slopes, moderately eroded	68.19	45.5%		Ile	89
TaA	Tama silt loam, driftless, 0 to 2 percent slopes	45.02	30.0%		Iw	95
TaC2	Tama silt loam, driftless, 6 to 12 percent slopes, moderately eroded	21.16	14.1%		IIIe	87
JuA	Judson silt loam, 0 to 3 percent slopes	10.35	6.9%		IIw	83
DeC2	Dodgeville soils, deep, 6 to 10 percent slopes, moderately eroded	5.26	3.5%		IIIe	64
Weighted Average					1.88	*n 89.2

*n: The aggregation method is "Weighted Average using all components"

*c: Using Capabilities Class Dominant Condition Aggregation Method

Soils data provided by USDA and NRCS.