

T-81-82-N

CENTER PLAT

R-5-E

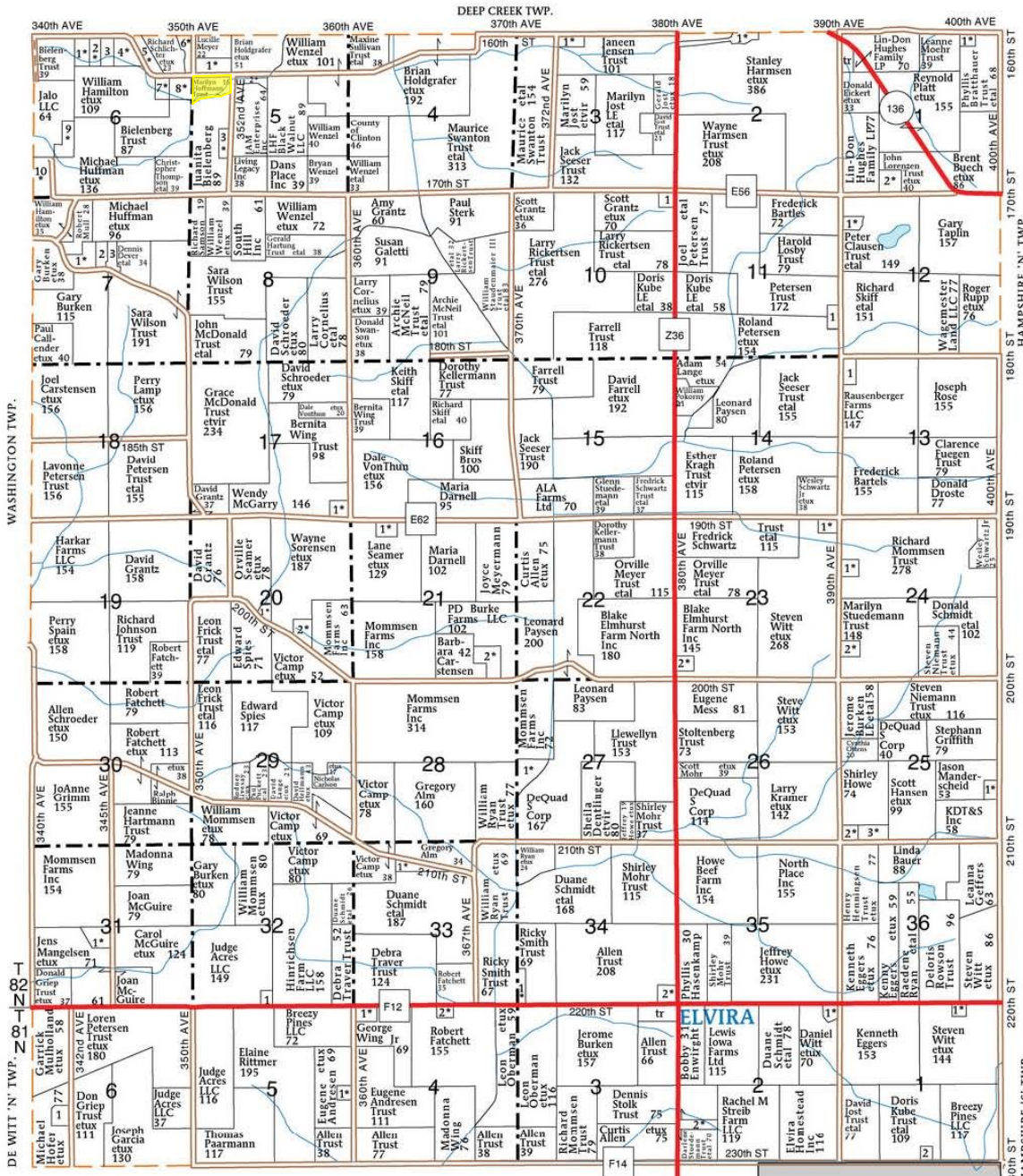

- CENTER TOWNSHIP**
- SECTION 1N**
1. Olson, Gary etux 5
 2. Eberhart, Michael etux 10
- SECTION 1S**
1. Robertson, Clifford etux 9
 2. Zarate, Raul 8
- SECTION 2N**
1. Voss, Mark etux 12
- SECTION 2S**
1. Boyd, Kevin etux 6
 2. Munck, Curtis etux 6
- SECTION 3N**
1. Swanton, Joseph etux 9
- SECTION 4S**
1. Wulweber, Billy etux 8

2. Oberman Jr, Leon etux 5
- SECTION 5N**
1. Frame, Aaron etux 10
 2. Mullin, James etux 12
 3. Cook, William etux 7
- SECTION 5S**
1. Andersen, Arlen etux 9
- SECTION 6N**
1. Housenga Trust, Robert etux 10
 2. Vauter, Michael etux 8
 3. Stuit, James 11
 4. Guesing, John etal 13
 5. Newsom, Joseph etux 13
 6. Trujillo, Matthew etux 19
 7. Franks, Robert etux 9

8. Ganzer, Todd etux 13
 9. Nash, Kirby etux 12
 10. Grantz Trust, Gerhardt etux 19
- SECTION 6S**
1. Jurczyk, Andrew 13
- SECTION 7**
1. Rutledge, Clark etux 15
 2. Edwards, Terry 9
 3. Sledge, Michael 5
- SECTION 10**
1. Grantz, Scott 6
- SECTION 11N**
1. Gradert, Jay 6
- SECTION 12**
1. Lauritzen, James etux 7
- SECTION 13**
1. Gradert, Joan 9

SEE PAGE 93 FOR ADDITIONAL NAMES NOT LISTED ON MAPS.

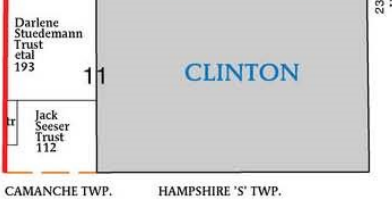

© Farm & Home Publishers, Ltd.

CLINTON CO., IA