

Soils Map

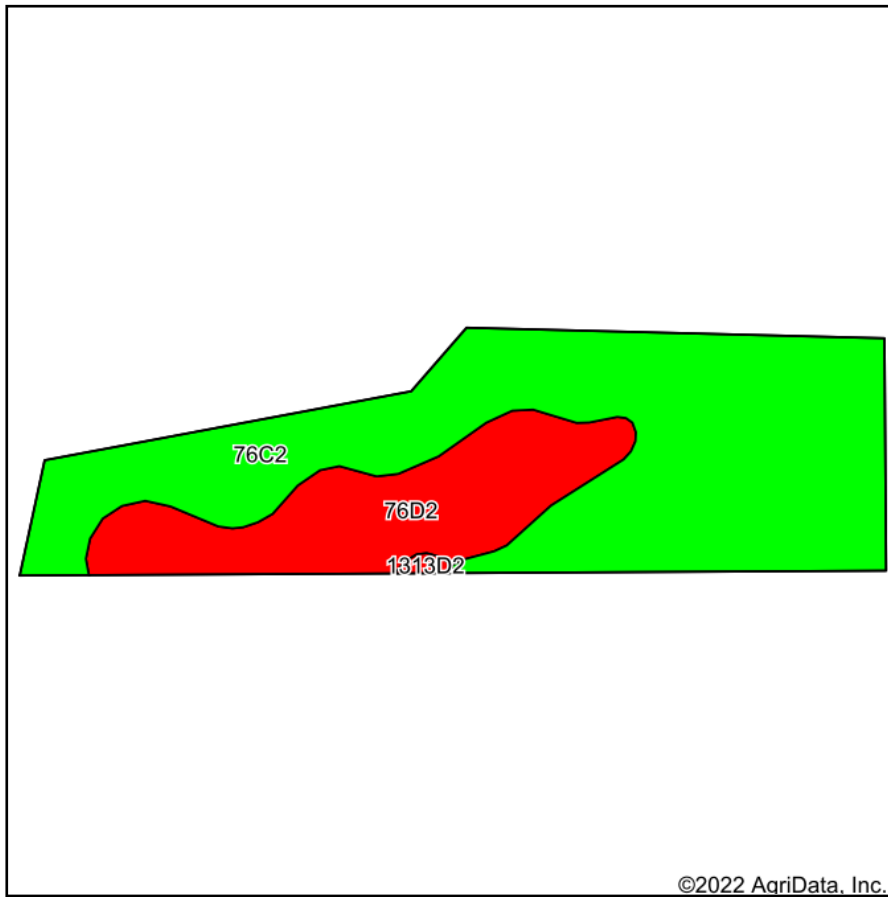

Soils data provided by USDA and NRCS.

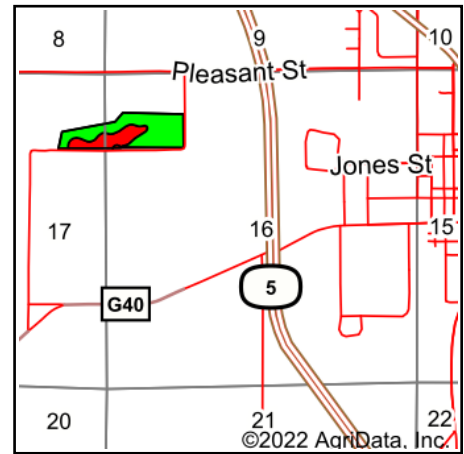

State: **Iowa**
 County: **Marion**
 Location: **16-76N-21W**
 Township: **Pleasant Grove**
 Acres: **23**
 Date: **4/20/2022**



Maps Provided By:



Area Symbol: IA125, Soil Area Version: 30											
Code	Soil Description	Acres	Percent of field	CSR2 Legend	Non-Irr Class *c	CSR2**	CSR	*n NCCPI Overall	*n NCCPI Corn	*n NCCPI Small Grains	*n NCCPI Soybeans
76C2	Ladoga silt loam, 5 to 9 percent slopes, eroded	16.73	72.7%		IIIe	75	65	87	87	67	68
76D2	Ladoga silt loam, 9 to 14 percent slopes, eroded	6.16	26.8%		IIIe	49	55	83	83	65	63
1313D2	Munterville silt loam, 9 to 14 percent slopes, moderately eroded	0.11	0.5%		VIe	34	10	61	61	48	43
Weighted Average					3.01	67.8	62.1	*n 85.8	*n 85.8	*n 66.4	*n 66.5

**IA has updated the CSR values for each county to CSR2.

*n: The aggregation method is "Weighted Average using all components"

*c: Using Capabilities Class Dominant Condition Aggregation Method

Soils data provided by USDA and NRCS.