

Soils Map

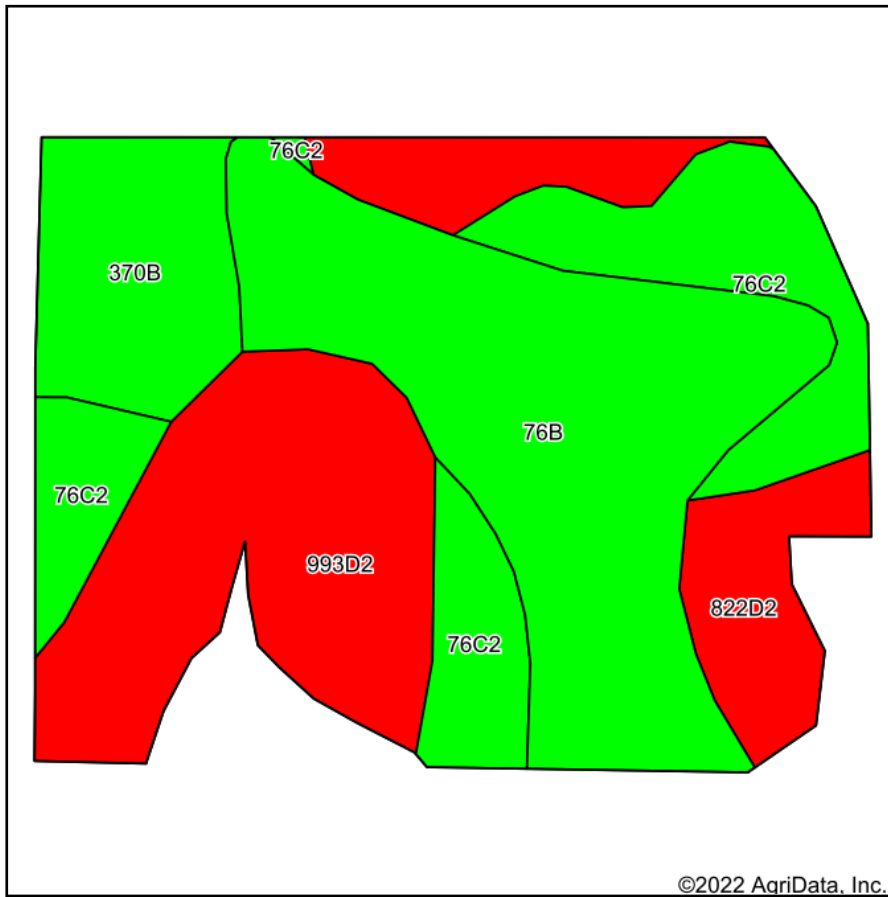

Soils data provided by USDA and NRCS.

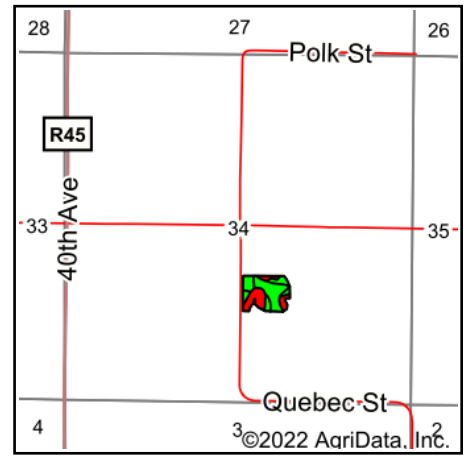

State: **Iowa**
 County: **Warren**
 Location: **34-75N-25W**
 Township: **Jackson**
 Acres: **8.28**
 Date: **5/18/2022**

PC PEOPLES
 COMPANY
 INNOVATIVE. REAL ESTATE. SOLUTIONS.

Maps Provided By:

surety
 CUSTOMIZED ONLINE MAPPING
 © AgriData, Inc. 2021 www.AgriDataInc.com



Area Symbol: IA181, Soil Area Version: 26

Code	Soil Description	Acres	Percent of field	CSR2 Legend	Non-Irr Class *c	CSR2**	CSR	*n NCCPI Overall	*n NCCPI Corn	*n NCCPI Small Grains	*n NCCPI Soybeans
76B	Ladoga silt loam, 2 to 5 percent slopes	2.86	34.5%		Ile	86	85	84	84	77	78
993D2	Armstrong-Gara loams, 9 to 14 percent slopes, moderately eroded	1.89	22.8%		IVe	23	20	68	68	52	47
76C2	Ladoga silt loam, dissected till plain, 5 to 9 percent slopes, eroded	1.62	19.6%		IIle	75	65	78	78	69	66
822D2	Lamoni silty clay loam, 9 to 14 percent slopes, eroded	1.02	12.3%		IVe	10	15	60	60	54	43
370B	Sharpsburg silty clay loam, 2 to 5 percent slopes	0.89	10.7%		Ile	91	87	93	93	78	80
Weighted Average					2.90	60.6	57.8	*n 77.2	*n 77.2	*n 67	*n 64.5

**IA has updated the CSR values for each county to CSR2.

*n: The aggregation method is "Weighted Average using all components"

*c: Using Capabilities Class Dominant Condition Aggregation Method

Soils data provided by USDA and NRCS.