

# FSA Tillable Soils Map

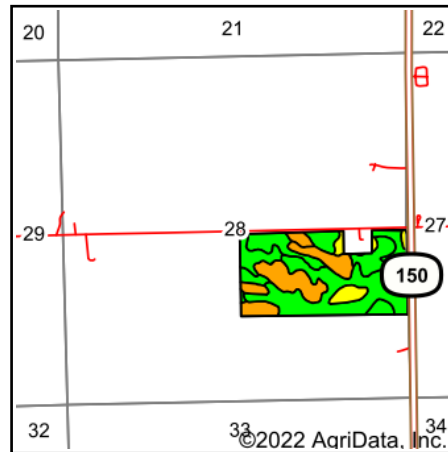

State: **Iowa**  
 County: **Buchanan**  
 Location: **28-88N-9W**  
 Township: **Sumner**  
 Acres: **71.91**  
 Date: **5/16/2022**

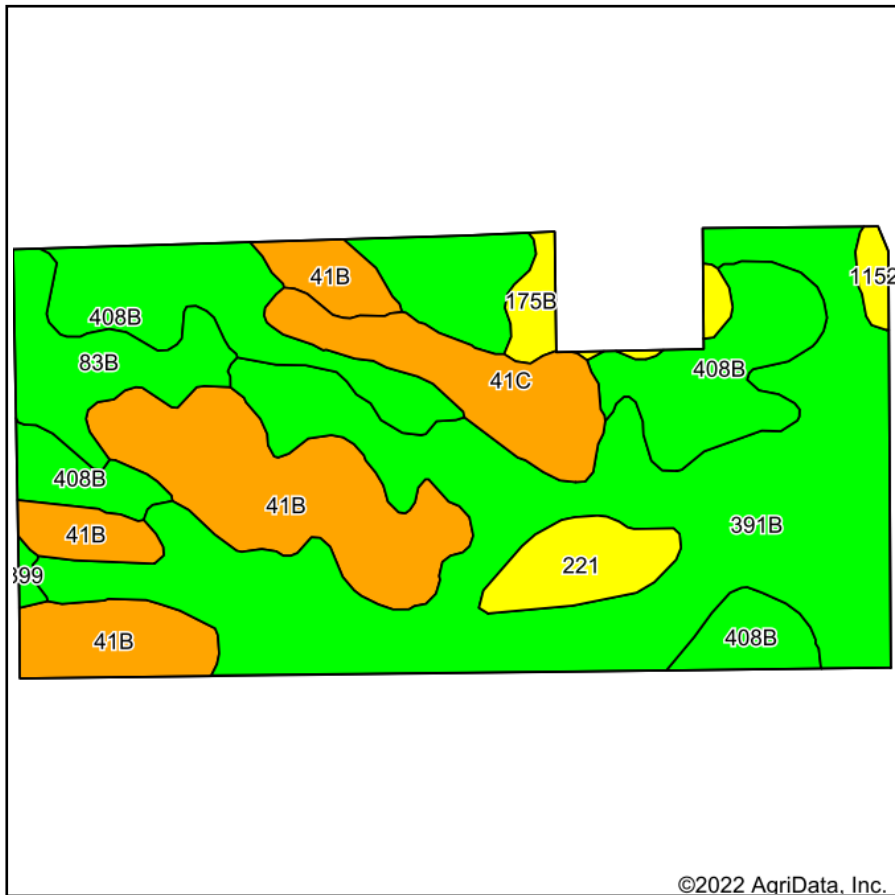

Maps Provided By:



Soils data provided by USDA and NRCS.

©2022 AgriData, Inc.

Area Symbol: IA019, Soil Area Version: 27

Code	Soil Description	Acres	Percent of field	CSR2 Legend	Non-Irr Class *c	CSR2**
391B	Clyde-Floyd complex, 1 to 4 percent slopes	29.06	40.4%		IIw	87
408B	Olin fine sandy loam, 2 to 5 percent slopes	16.09	22.4%		Ile	74
41B	Sparta loamy fine sand, 2 to 5 percent slopes	13.45	18.7%		IVs	39
41C	Sparta loamy fine sand, 5 to 9 percent slopes	4.67	6.5%		IVs	34
83B	Kenyon loam, 2 to 5 percent slopes	3.98	5.5%		Ile	90
221	Klossner muck, 1 to 4 percent slopes	2.54	3.5%		IIIw	48
175B	Dickinson fine sandy loam, 2 to 5 percent slopes	1.36	1.9%		IIIe	50
1152	Marshan clay loam, 0 to 2 percent slopes, rarely flooded	0.53	0.7%		IIw	54
399	Readlyn silt loam, 1 to 3 percent slopes	0.23	0.3%		Iw	91
<b>Weighted Average</b>					<b>2.55</b>	<b>69.5</b>

\*\*IA has updated the CSR values for each county to CSR2.

\*c: Using Capabilities Class Dominant Condition Aggregation Method

Soils data provided by USDA and NRCS.