

Soils Map

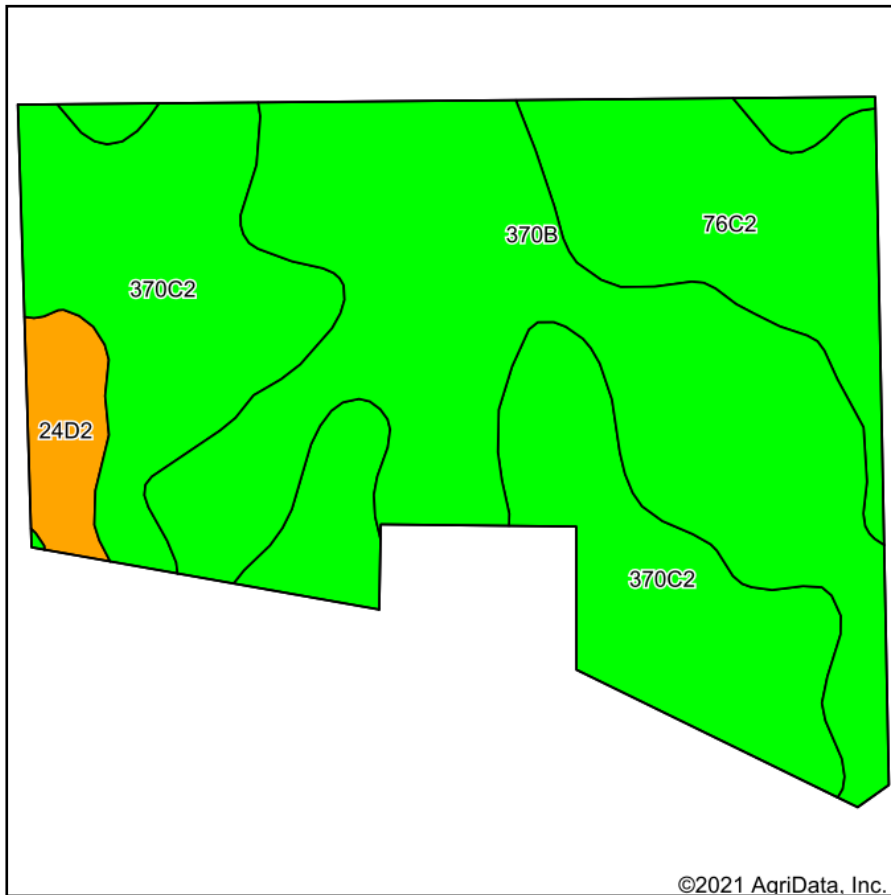

Soils data provided by USDA and NRCS.

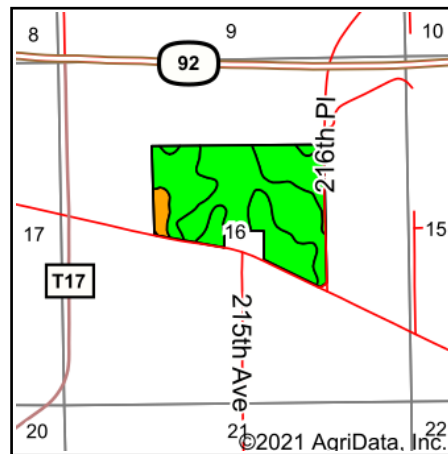

State: **Iowa**
 County: **Marion**
 Location: **16-75N-18W**
 Township: **Clay**
 Acres: **99.17**
 Date: **10/18/2021**



Maps Provided By:



© AgriData, Inc. 2021

www.AgriDataInc.com



Area Symbol: IA125, Soil Area Version: 29

Code	Soil Description	Acres	Percent of field	CSR2 Legend	Non-Irr Class *c	CSR2**	CSR	*n NCCPI Overall	*n NCCPI Corn	*n NCCPI Small Grains	*n NCCPI Soybeans	
370B	Sharpsburg silty clay loam, 2 to 5 percent slopes	43.29	43.7%		Ile	91	87	93	93	78	80	
370C2	Sharpsburg silty clay loam, 5 to 9 percent slopes, eroded	36.90	37.2%		IIle	80	67	84	84	69	67	
76C2	Ladoga silt loam, 5 to 9 percent slopes, eroded	15.12	15.2%		IIIle	75	65	87	87	67	68	
24D2	Shelby loam, 9 to 14 percent slopes, moderately eroded	3.86	3.9%		IIle	45	48	69	69	56	55	
Weighted Average						2.56	82.7	74.7	*n 87.8	*n 87.8	*n 72.1	*n 72.4

**IA has updated the CSR values for each county to CSR2.

*n: The aggregation method is "Weighted Average using all components"

*c: Using Capabilities Class Dominant Condition Aggregation Method

Soils data provided by USDA and NRCS.