

# FSA Tillable Soils Map

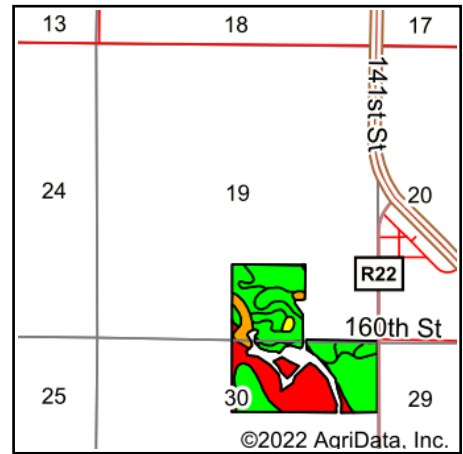

State: **Iowa**  
 County: **Dallas**  
 Location: **19-81N-26W**  
 Township: **Des Moines**  
 Acres: **105.82**  
 Date: **7/8/2022**

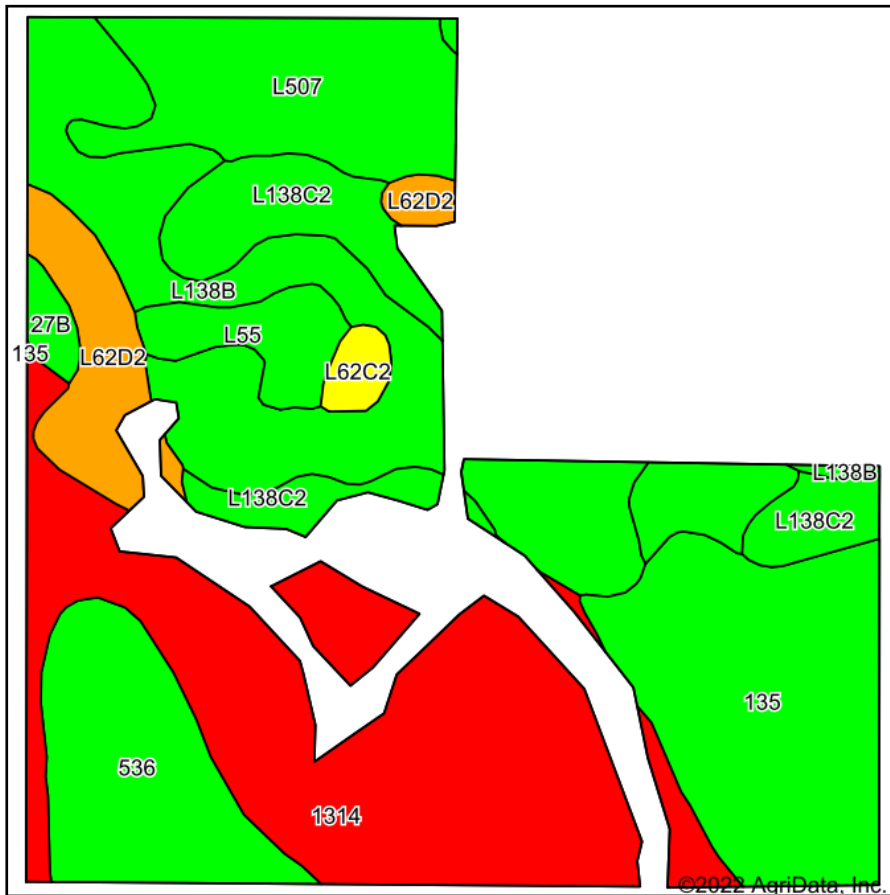

Soils data provided by USDA and NRCS.

Area Symbol: IA049, Soil Area Version: 27

Code	Soil Description	Acres	Percent of field	CSR2 Legend	Non-Irr Class *c	*i Corn Bu	*i Soybeans Bu	CSR2**	CSR	*n NCCPI Overall
1314	Hanlon-Spillville complex, channeled, 0 to 2 percent slopes	28.40	26.8%		Vw	120.0	34.8	33	25	50
L138B	Clarion loam, Bemis moraine, 2 to 6 percent slopes	19.10	18.0%		Ile	80.0	23.2	88		80
135	Coland clay loam, 0 to 2 percent slopes, occasionally flooded	16.37	15.5%		IIw	198.4	57.5	76	80	83
L507	Canisteo clay loam, Bemis moraine, 0 to 2 percent slopes	12.73	12.0%		IIw	0.0	0.0	87		81
536	Hanlon fine sandy loam, 0 to 2 percent slopes	9.94	9.4%		IIs	171.2	49.6	79	72	86
L138C2	Clarion loam, Bemis moraine, 6 to 10 percent slopes, moderately eroded	8.74	8.3%		IIIe	0.0	0.0	83		67
L62D2	Storden loam, Bemis moraine, 10 to 16 percent slopes, moderately eroded	5.52	5.2%		IVe	0.0	0.0	41		64
L55	Nicollet loam, 1 to 3 percent slopes	3.09	2.9%		Ie	0.0	0.0	91		85
L62C2	Storden loam, Bemis moraine, 6 to 10 percent slopes, moderately eroded	0.99	0.9%		IIIe	0.0	0.0	64		67
27B	Terril loam, 2 to 6 percent slopes	0.94	0.9%		Ile	224.0	65.0	87	82	88
<b>Weighted Average</b>					<b>2.97</b>	<b>95.4</b>	<b>27.7</b>	<b>67.4</b>	<b>*.</b>	<b>*n 71.3</b>

\*\*IA has updated the CSR values for each county to CSR2.

\*. CSR weighted average cannot be calculated on the current soils data, use prior data version for csr values.

\*i Yield data provided by the ISPAID Database version 8.1.1 developed by IA State University.

\*n: The aggregation method is "Weighted Average using all components"

\*c: Using Capabilities Class Dominant Condition Aggregation Method

Soils data provided by USDA and NRCS.