

Soils Map

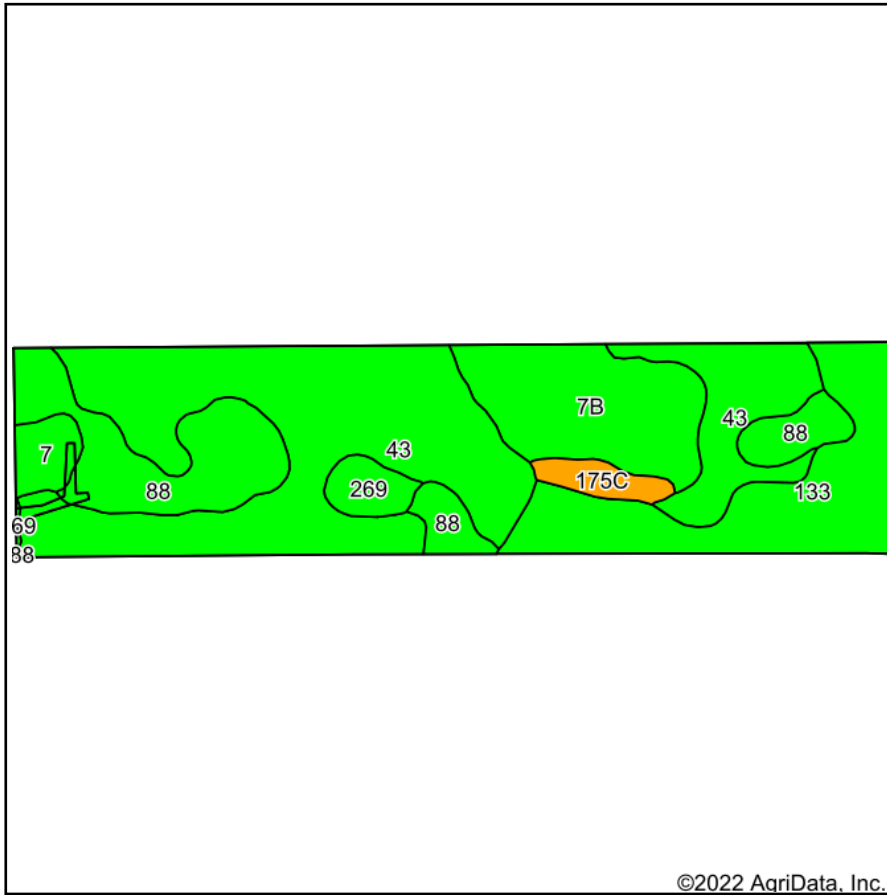

Soils data provided by USDA and NRCS.

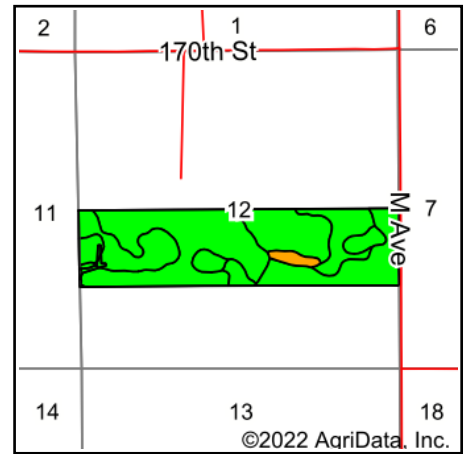

State: **Iowa**
 County: **Tama**
 Location: **12-85N-15W**
 Township: **Crystal**
 Acres: **153.1**
 Date: **7/18/2022**



Maps Provided By:



Area Symbol: IA171, Soil Area Version: 26						
Code	Soil Description	Acres	Percent of field	CSR2 Legend	Non-Irr Class *c	CSR2**
43	Bremer silty clay loam, 0 to 2 percent slopes	69.88	45.6%		IIw	74
133	Colo silty clay loam, 0 to 2 percent slopes, occasionally flooded	25.89	16.9%		IIw	78
88	Nevin silty clay loam, 0 to 2 percent slopes	25.24	16.5%		Iw	95
7B	Wiota silt loam, 2 to 5 percent slopes	21.40	14.0%		Ile	95
269	Humeston silt loam, 0 to 2 percent slopes	3.71	2.4%		IIlw	72
7	Wiota silt loam, 0 to 2 percent slopes	3.70	2.4%		I	100
175C	Dickinson fine sandy loam, 5 to 9 percent slopes	3.28	2.1%		IIIe	45
Weighted Average					1.86	81

**IA has updated the CSR values for each county to CSR2.

*c: Using Capabilities Class Dominant Condition Aggregation Method
 Soils data provided by USDA and NRCS.