

# Tillable Soils Map

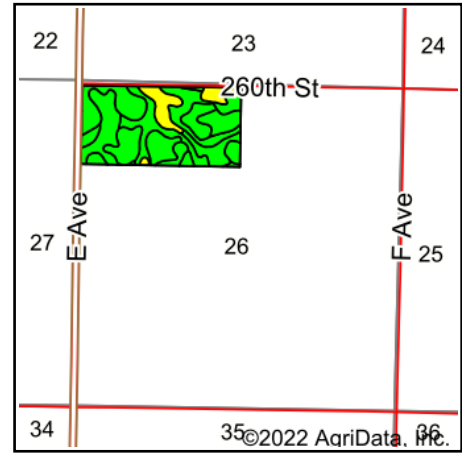

State: **Iowa**  
 County: **Greene**  
 Location: **26-83N-32W**  
 Township: **Scranton**  
 Acres: **76.22**  
 Date: **6/7/2022**

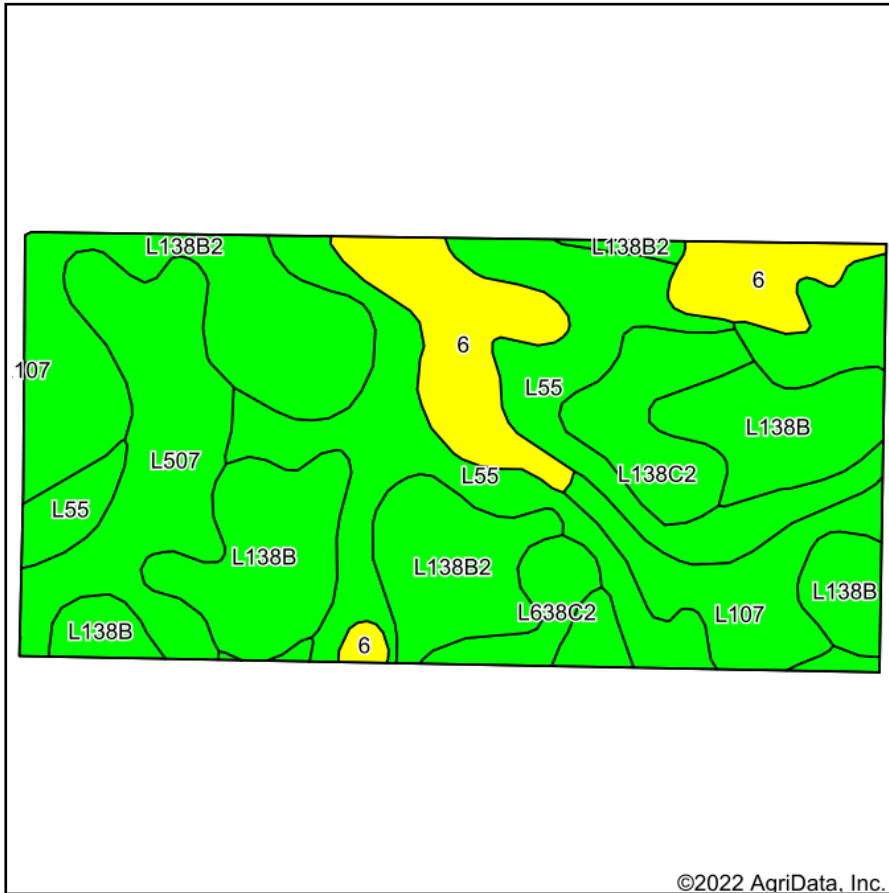

Maps Provided By:  
  
 CUSTOMIZED ONLINE MAPPING  
 © AgriData, Inc. 2021 www.AgriDataInc.com



Soils data provided by USDA and NRCS.

©2022 AgriData, Inc.

Area Symbol: IA073, Soil Area Version: 27

Code	Soil Description	Acres	Percent of field	CSR2 Legend	Non-Irr Class *c	*i Corn Bu	*i Soybeans Bu	CSR2**	CSR	*n NCCPI Overall
L55	Nicollet loam, 1 to 3 percent slopes	17.90	23.5%		le	0.0	0.0	91		85
L138B2	Clarion loam, Bemis moraine, 2 to 6 percent slopes, moderately eroded	15.41	20.2%		lle	0.0	0.0	85		72
L138B	Clarion loam, Bemis moraine, 2 to 6 percent slopes	12.59	16.5%		lle	220.8	64.0	88		80
L507	Canisteo clay loam, Bemis moraine, 0 to 2 percent slopes	9.11	12.0%		llw	0.0	0.0	87		81
6	Okoboji silty clay loam, 0 to 1 percent slopes	8.22	10.8%		lllw	185.6	53.8	59	58	76
L107	Webster clay loam, Bemis moraine, 0 to 2 percent slopes	6.98	9.2%		llw	0.0	0.0	88		84
L138C2	Clarion loam, Bemis moraine, 6 to 10 percent slopes, moderately eroded	4.10	5.4%		llle	0.0	0.0	83		67
L638C2	Clarion-Storden complex, Bemis moraine, 6 to 10 percent slopes, moderately eroded	1.91	2.5%		llle	0.0	0.0	75		70
<b>Weighted Average</b>					<b>1.95</b>	<b>56.5</b>	<b>16.4</b>	<b>84.3</b>	<b>*</b>	<b>*n 78.7</b>

\*\*IA has updated the CSR values for each county to CSR2.

\*- CSR weighted average cannot be calculated on the current soils data, use prior data version for csr values.

\*i Yield data provided by the ISPAID Database version 8.1.1 developed by IA State University.

\*n: The aggregation method is "Weighted Average using all components"

\*c: Using Capabilities Class Dominant Condition Aggregation Method

Soils data provided by USDA and NRCS.