

Potential Tillable Soils Map

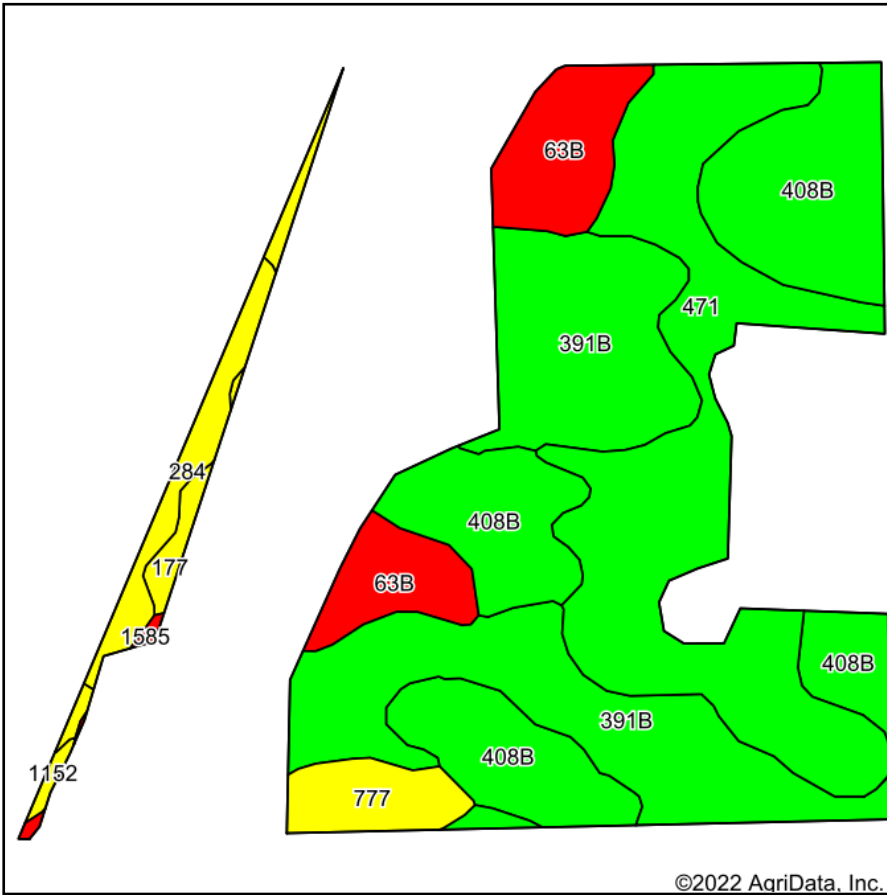

Soils data provided by USDA and NRCS.

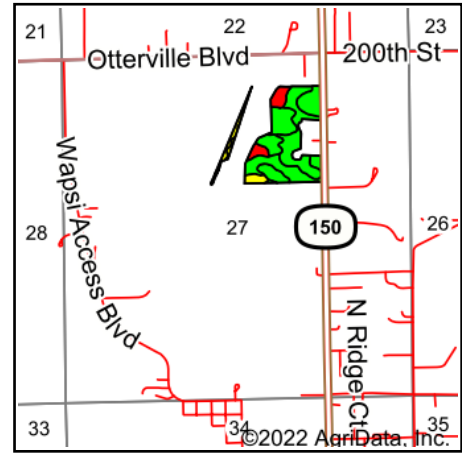

State: **Iowa**
 County: **Buchanan**
 Location: **27-89N-9W**
 Township: **Washington**
 Acres: **28.8**
 Date: **8/1/2022**



Maps Provided By:



© AgriData, Inc. 2021

www.AgriDataInc.com



Area Symbol: IA019, Soil Area Version: 27

Code	Soil Description	Acres	Percent of field	CSR2 Legend	Non-Irr Class *c	CSR2**
391B	Clyde-Floyd complex, 1 to 4 percent slopes	8.24	28.6%		Ilw	87
471	Oran loam, 1 to 3 percent slopes	7.92	27.5%		Iw	74
408B	Olin fine sandy loam, 2 to 5 percent slopes	7.38	25.6%		Ile	74
63B	Chelsea loamy fine sand, 2 to 5 percent slopes	2.67	9.3%		IVs	19
777	Wapsie loam, 0 to 2 percent slopes	1.00	3.5%		IIs	51
284	Flagler sandy loam, 0 to 2 percent slopes	0.92	3.2%		IIIs	55
177	Saude loam, 0 to 2 percent slopes	0.51	1.8%		IIs	60
1152	Marshan clay loam, 0 to 2 percent slopes, rarely flooded	0.09	0.3%		Ilw	54
1585	Spillville-Coland complex, 0 to 2 percent slopes, frequently flooded	0.07	0.2%		Vw	22
Weighted Average					1.95	70.8

**IA has updated the CSR values for each county to CSR2.

*c: Using Capabilities Class Dominant Condition Aggregation Method

Soils data provided by USDA and NRCS.