

Total Soils Map

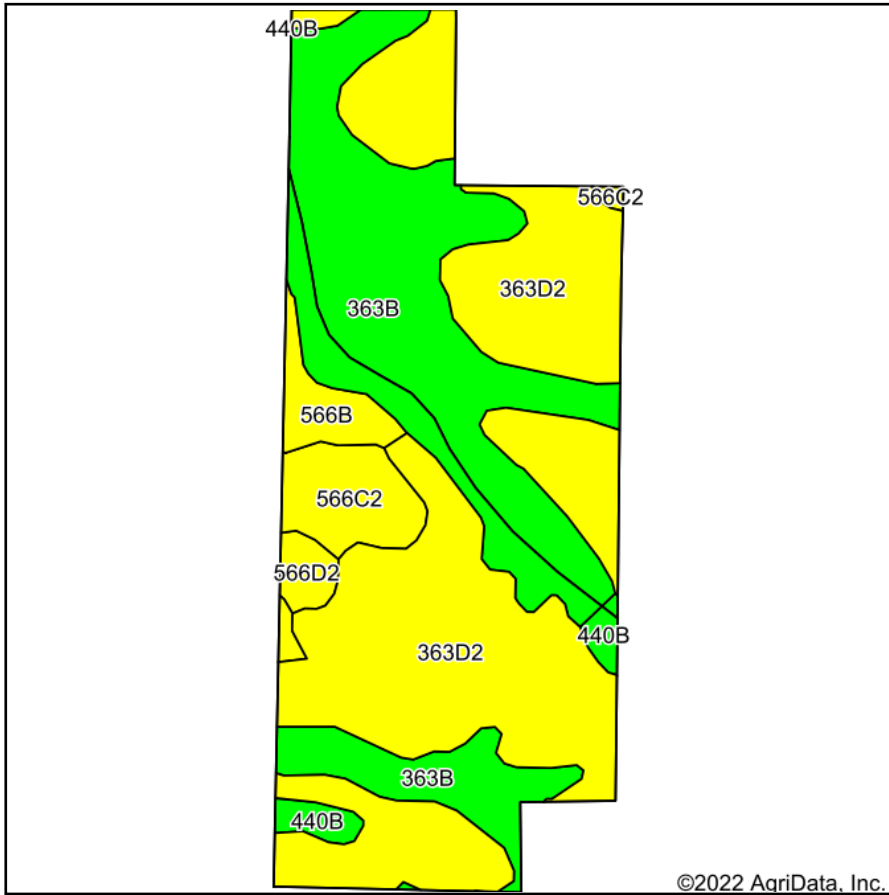

Soils data provided by USDA and NRCS.

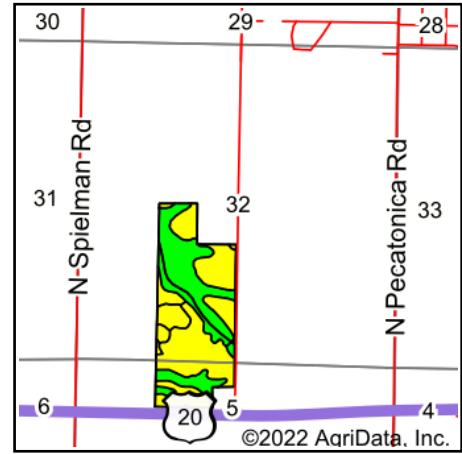

State: **Illinois**
 County: **Winnebago**
 Location: **32-27N-10E**
 Township: **Pecatonica**
 Acres: **87.21**
 Date: **8/1/2022**



Maps Provided By:



Area Symbol: IL201, Soil Area Version: 17

Code	Soil Description	Acres	Percent of field	Il. State Productivity Index Legend	Crop productivity index for optimum management
**363D2	Griswold loam, 6 to 12 percent slopes, eroded	45.12	51.7%		**109
**363B	Griswold loam, 2 to 4 percent slopes	31.86	36.5%		**116
**566C2	Rockton and Dodgeville soils, 5 to 10 percent slopes, eroded	4.82	5.5%		**96
**566B	Rockton and Dodgeville soils, 2 to 5 percent slopes	2.56	2.9%		**102
**440B	Jasper silt loam, 2 to 5 percent slopes	1.58	1.8%		**129
**566D2	Rockton and Dodgeville soils, 10 to 15 percent slopes, eroded	1.27	1.5%		**92
Weighted Average					110.7

Table: Optimum Crop Productivity Ratings for Illinois Soil by K.R. Olson and J.M. Lang, Office of Research, ACES, University of Illinois at Champaign-Urbana. Version: 1/2/2012 Amended Table S2 B811

Crop yields and productivity indices for optimum management (B811) are maintained at the following NRES web site: <http://soilproductivity.nres.illinois.edu/>

** Indexes adjusted for slope and erosion according to Bulletin 811 Table S3

Soils data provided by USDA and NRCS. Soils data provided by University of Illinois at Champaign-Urbana.