

Soils Map

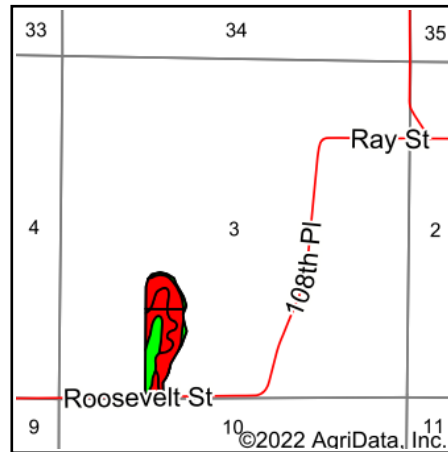

State: **Iowa**
 County: **Warren**
 Location: **3-74N-24W**
 Township: **Squaw**
 Acres: **20.1**
 Date: **8/29/2022**

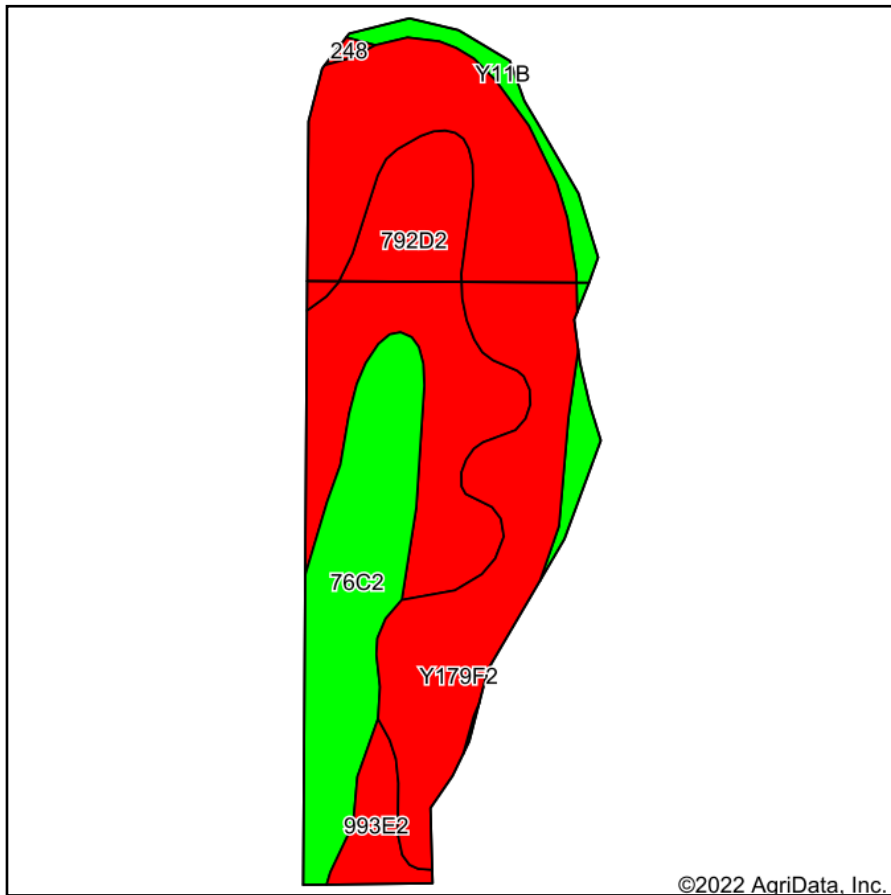

Maps Provided By:



Soils data provided by USDA and NRCS.

©2022 AgriData, Inc.

Area Symbol: IA181, Soil Area Version: 26

Code	Soil Description	Acres	Percent of field	CSR2 Legend	Non-Irr Class *c	CSR2**	CSR	*n NCCPI Overall	*n NCCPI Corn	*n NCCPI Small Grains	*n NCCPI Soybeans	
Y179F2	Gara loam, dissected till plain, 18 to 25 percent slopes, eroded	8.88	44.2%		Vlle	16		57	57	36	38	
792D2	Armstrong loam, 9 to 14 percent slopes, moderately eroded	5.28	26.3%		IVe	7	13	65	65	51	43	
76C2	Ladoga silt loam, dissected till plain, 5 to 9 percent slopes, eroded	4.01	20.0%		IIle	75	65	78	78	69	66	
Y11B	Colo, occasionally flooded-Ely silty clay loams, dissected till plain, 2 to 5 percent slopes	1.08	5.4%		IIw	80		88	86	52	81	
993E2	Armstrong-Gara loams, 14 to 18 percent slopes, moderately eroded	0.79	3.9%		VIe	17	5	63	63	45	43	
248	Wabash silty clay loam, 0 to 2 percent slopes	0.06	0.3%		IIIw	38	60	50	47	20	50	
Weighted Average						5.09	29	*-	*n 65.2	*n 65.1	*n 47.7	*n 47.4

**IA has updated the CSR values for each county to CSR2.

*- CSR weighted average cannot be calculated on the current soils data, use prior data version for csr values.

*n: The aggregation method is "Weighted Average using all components"

*c: Using Capabilities Class Dominant Condition Aggregation Method

Soils data provided by USDA and NRCS.