

Tillable Soils Map

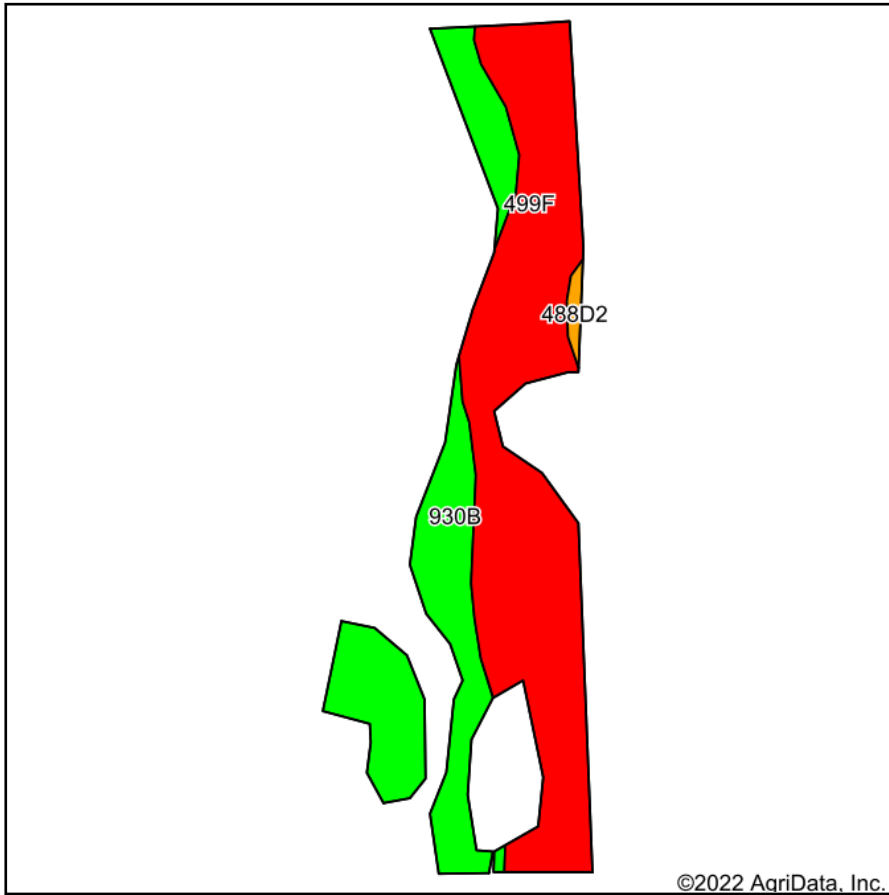

Soils data provided by USDA and NRCS.

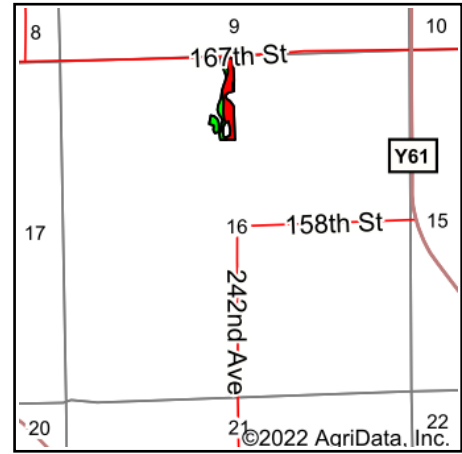

State: **Iowa**
 County: **Jackson**
 Location: **16-85N-3E**
 Township: **Perry**
 Acres: **5.38**
 Date: **9/18/2022**



Maps Provided By:



Area Symbol: IA097, Soil Area Version: 27

Code	Soil Description	Acres	Percent of field	CSR2 Legend	Non-Irr Class *c	CSR2**
499F	Nordness silt loam, 14 to 35 percent slopes	3.39	63.0%		Vlls	5
930B	Orion silt loam, 2 to 5 percent slopes, occasionally flooded	1.93	35.9%		llw	76
488D2	Newvienna silt loam, 9 to 14 percent slopes, moderately eroded	0.06	1.1%		llle	51
Weighted Average					5.16	31

**IA has updated the CSR values for each county to CSR2.

*c: Using Capabilities Class Dominant Condition Aggregation Method

Soils data provided by USDA and NRCS.