

FSA Tillable Soils Map

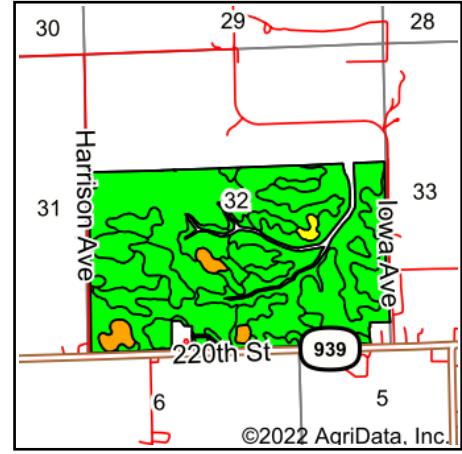

State: **Iowa**
 County: **Buchanan**
 Location: **32-89N-9W**
 Township: **Washington**
 Acres: **360.64**
 Date: **9/21/2022**

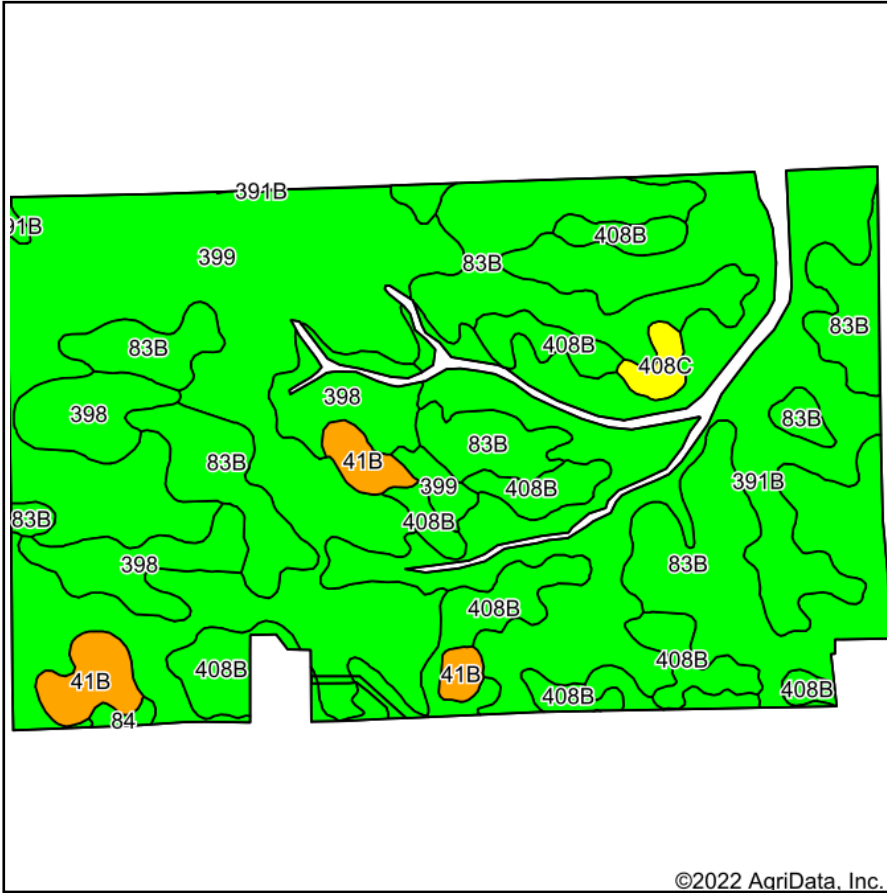

Maps Provided By:



© AgriData, Inc. 2021

www.AgriDataInc.com



Soils data provided by USDA and NRCS.

©2022 AgriData, Inc.

Area Symbol: IA019, Soil Area Version: 27

Code	Soil Description	Acres	Percent of field	CSR2 Legend	Non-Irr Class *c	CSR2**
399	Readlyn silt loam, 1 to 3 percent slopes	110.94	30.8%		lw	91
391B	Clyde-Floyd complex, 1 to 4 percent slopes	89.43	24.8%		llw	87
83B	Kenyon loam, 2 to 5 percent slopes	87.98	24.4%		lle	90
408B	Olin fine sandy loam, 2 to 5 percent slopes	33.06	9.2%		lle	74
398	Tripoli clay loam, 0 to 2 percent slopes	26.00	7.2%		llw	82
41B	Sparta loamy fine sand, 2 to 5 percent slopes	9.81	2.7%		IVs	39
408C	Olin fine sandy loam, 5 to 9 percent slopes	2.46	0.7%		llle	65
84	Clyde clay loam, 0 to 3 percent slopes	0.96	0.3%		llw	88
Weighted Average					1.75	86

**IA has updated the CSR values for each county to CSR2.

*c: Using Capabilities Class Dominant Condition Aggregation Method

Soils data provided by USDA and NRCS.