

Soils Map

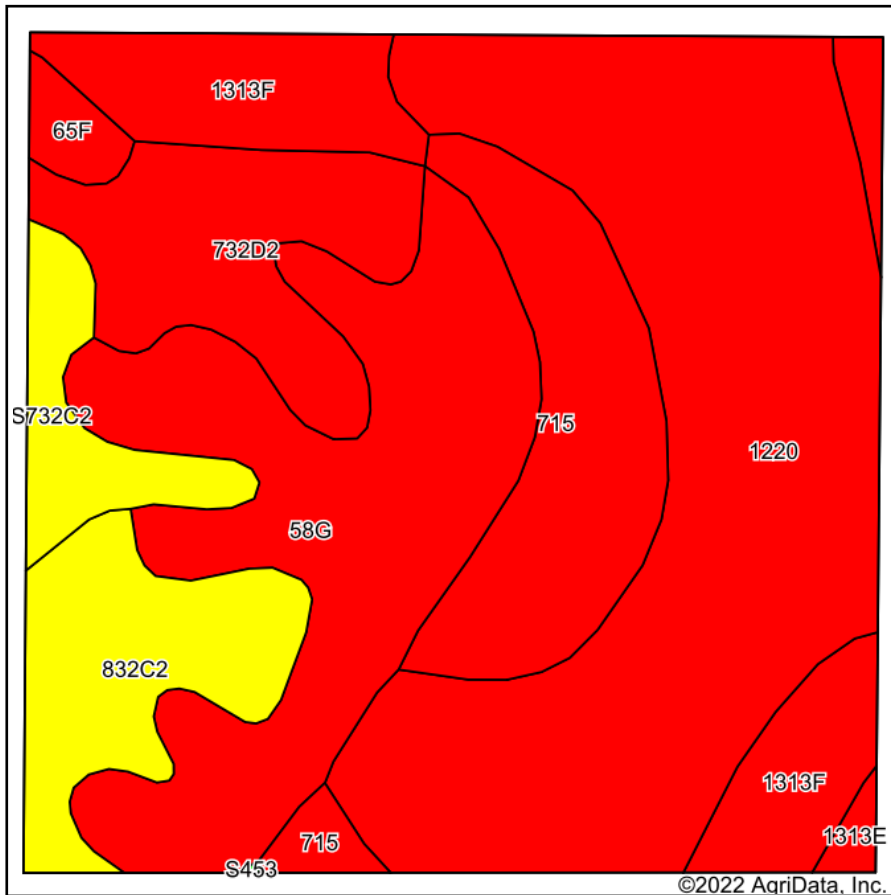

Soils data provided by USDA and NRCS.

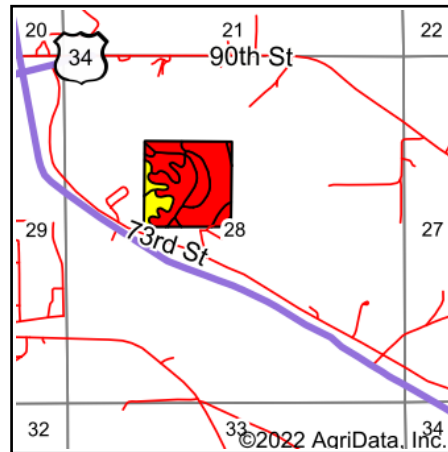

State: **Iowa**
 County: **Wapello**
 Location: **28-72N-13W**
 Township: **Center**
 Acres: **40**
 Date: **10/12/2022**



Maps Provided By:



Area Symbol: IA179, Soil Area Version: 30

Code	Soil Description	Acres	Percent of field	CSR2 Legend	Non-Irr Class *c	CSR2**	CSR	*n NCCPI Overall	*n NCCPI Corn	*n NCCPI Small Grains	*n NCCPI Soybeans
1220	Nodaway silt loam, channeled, 0 to 2 percent slopes	14.28	35.7%		Vw	5	25	15	7	15	2
58G	Douds soils, 18 to 40 percent slopes	8.44	21.1%		Vllle	12	5	41	41	26	24
715	Nodaway-Landes complex, 0 to 2 percent slopes	4.45	11.1%		Illw	49	75	64	63	48	50
1313F	Munterville silt loam, 18 to 40 percent slopes	3.87	9.7%		Vllle	5	5	16	16	12	7
732D2	Weller silty clay loam, 9 to 14 percent slopes, moderately eroded	3.61	9.0%		IVe	34	15	82	82	69	66
832C2	Weller silty clay loam, terrace, 5 to 9 percent slopes, moderately eroded	3.15	7.9%		IVe	61	30	88	88	73	72
S732C2	Weller silty clay loam, 5 to 9 percent slopes, moderately eroded	1.52	3.8%		Illle	59		86	86	72	71
65F	Lindley loam, 18 to 25 percent slopes	0.48	1.2%		Vllle	17	10	61	61	44	50
1313E	Munterville silt loam, 9 to 18 percent slopes	0.20	0.5%		Vllle	30	10	57	57	49	45
Weighted Average								*n 41.3	*n 38.3	*n 32.8	*n 27.2

**IA has updated the CSR values for each county to CSR2.

*- CSR weighted average cannot be calculated on the current soils data, use prior data version for csr values.

*n: The aggregation method is "Weighted Average using all components"

*c: Using Capabilities Class Dominant Condition Aggregation Method

Soils data provided by USDA and NRCS.