

Soils Map

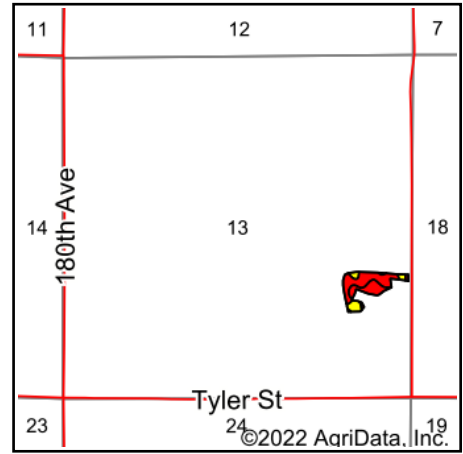

State: **Iowa**
 County: **Warren**
 Location: **13-74N-23W**
 Township: **Liberty**
 Acres: **6.83**
 Date: **11/1/2022**

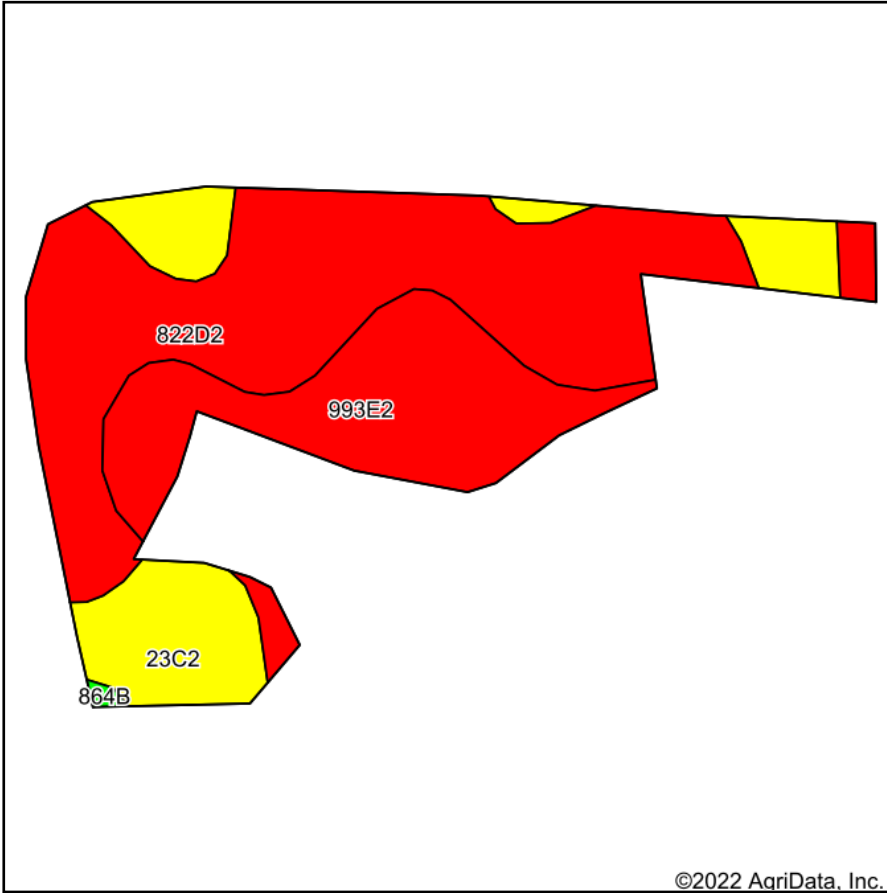

Maps Provided By:



Soils data provided by USDA and NRCS.

©2022 AgriData, Inc.

Area Symbol: IA181, Soil Area Version: 26

Code	Soil Description	Acres	Percent of field	CSR2 Legend	Non-Irr Class *c	CSR2**	CSR	*n NCCPI Overall	*n NCCPI Corn	*n NCCPI Small Grains	*n NCCPI Soybeans	
822D2	Lamoni silty clay loam, 9 to 14 percent slopes, eroded	3.69	54.0%		IVe	10	15	60	60	54	43	
993E2	Armstrong-Gara loams, 14 to 18 percent slopes, moderately eroded	1.84	26.9%		VIe	17	5	63	63	45	43	
23C2	Arispe silty clay loam, 5 to 9 percent slopes, moderately eroded	1.30	19.0%		IIIe	62	62	74	74	67	69	
Weighted Average						4.35	21.8	21.3	*n 63.5	*n 63.5	*n 54	*n 47.9

**IA has updated the CSR values for each county to CSR2.

*n: The aggregation method is "Weighted Average using all components"

*c: Using Capabilities Class Dominant Condition Aggregation Method

Soils data provided by USDA and NRCS.