

Soils Map

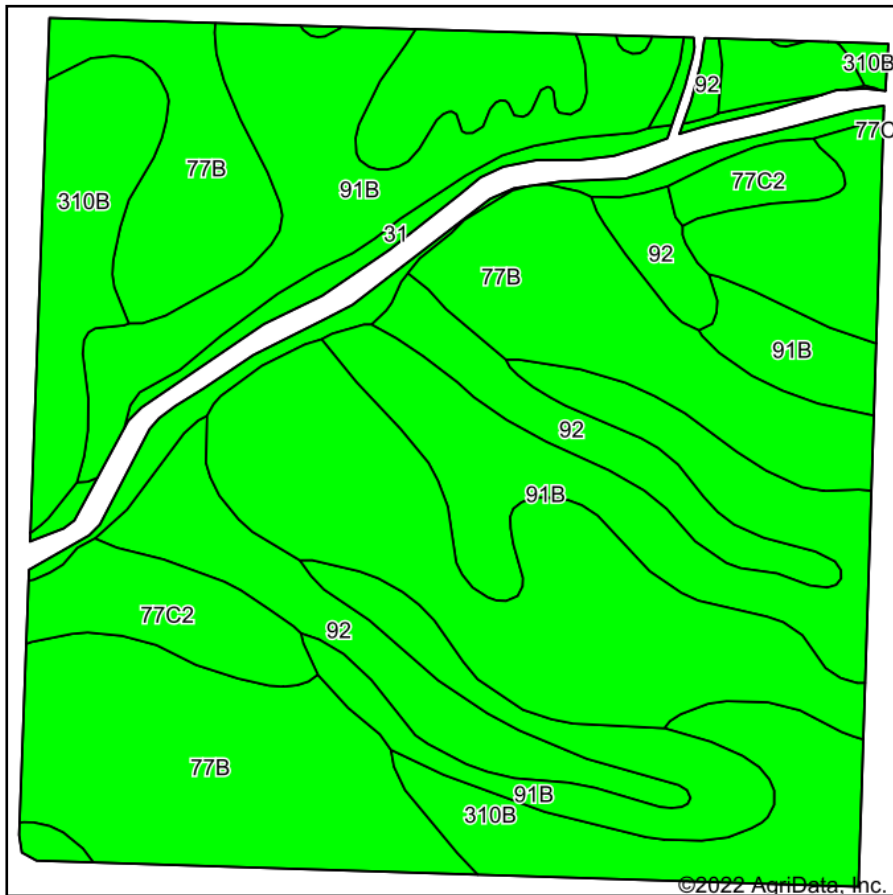

Soils data provided by USDA and NRCS.

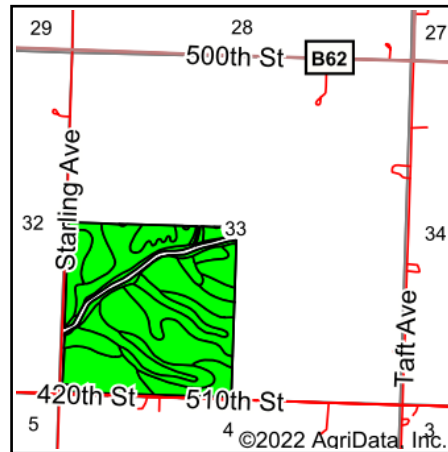

State: **Iowa**
 County: **O'Brien**
 Location: **33-94N-40W**
 Township: **Liberty**
 Acres: **150.64**
 Date: **12/6/2022**



Maps Provided By:



© AgriData, Inc. 2021

www.AgriDataInc.com



Area Symbol: IA141, Soil Area Version: 27

Code	Soil Description	Acres	Percent of field	CSR2 Legend	Non-Irr Class *c	CSR2**	CSR	*n NCCPI Overall	
77B	Sac silty clay loam, loam substratum, 2 to 5 percent slopes	65.50	43.5%		Ile	95	68	77	
91B	Primghar silty clay loam, 2 to 5 percent slopes	39.84	26.4%		Ile	95	78	78	
310B	Galva silty clay loam, 2 to 5 percent slopes	16.77	11.1%		Ile	95	70	75	
92	Marcus silty clay loam, 0 to 2 percent slopes	15.14	10.1%		Ilw	94	75	75	
77C2	Sac silty clay loam, loam substratum, 5 to 9 percent slopes, eroded	7.04	4.7%		Ille	88	51	73	
31	Afton silty clay loam, 0 to 2 percent slopes, occasionally flooded	6.35	4.2%		Ilw	80	72	67	
Weighted Average						2.05	93.9	70.9	*n 76.2

**IA has updated the CSR values for each county to CSR2.

*n: The aggregation method is "Weighted Average using all components"

*c: Using Capabilities Class Dominant Condition Aggregation Method

Soils data provided by USDA and NRCS.