

Soils Map

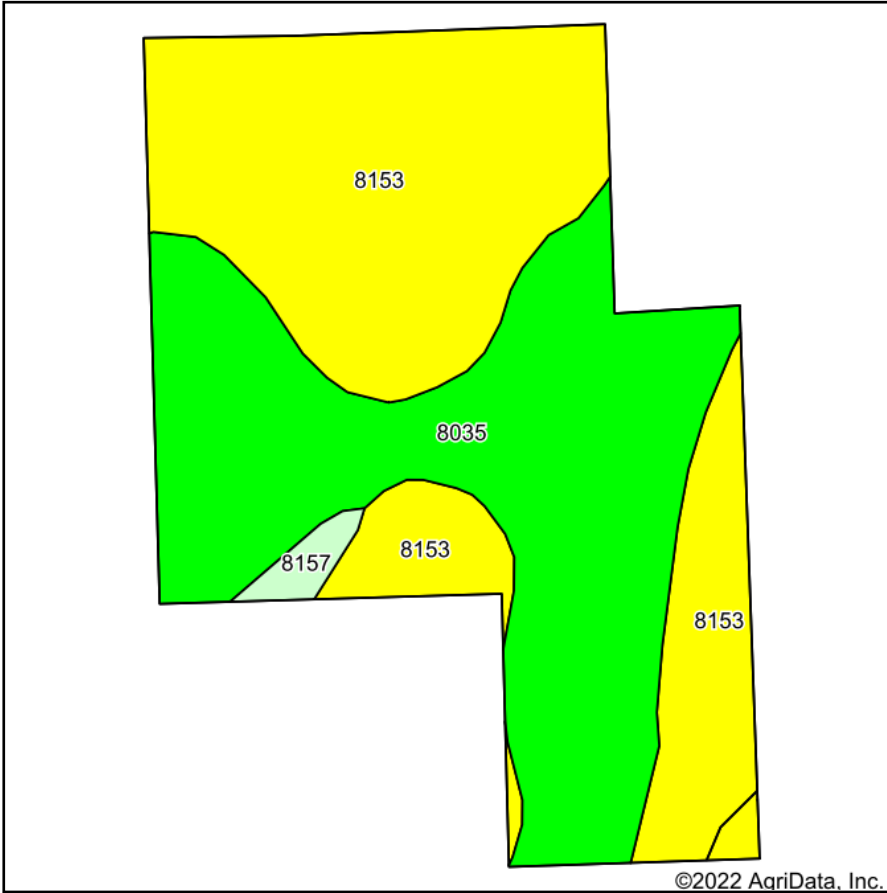

Soils data provided by USDA and NRCS.

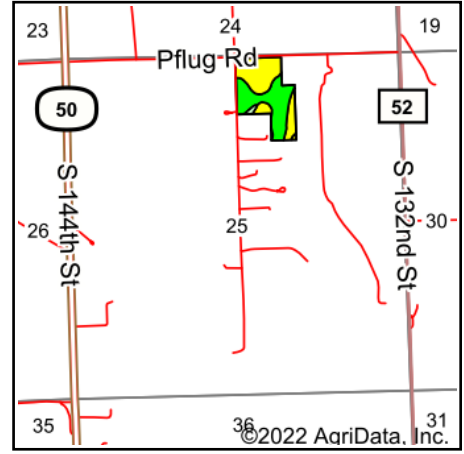

State: **Nebraska**
 County: **Sarpy**
 Location: **25-13N-11E**
 Township: **Plattford-Springfield I**
 Acres: **20.16**
 Date: **12/17/2022**



Maps Provided By:



© AgriData, Inc. 2021

www.AgriDataInc.com



Area Symbol: NE153, Soil Area Version: 16

Code	Soil Description	Acres	Percent of field	Irr class Legend	Non-Irr Class *c	Irr Class *c	SRPG	*n NCCPI Overall	
8153	Contrary-Marshall silty clay loams, 6 to 11 percent slopes	10.30	51.1%		IIIe	IVe	67	88	
8035	Marshall-Contrary silty clay loams, 2 to 7 percent slopes	9.58	47.5%		IIe	IIIe	73	92	
8157	Contrary-Monona-Ida complex, 6 to 17 percent slopes	0.28	1.4%		IVe		59	79	
Weighted Average						2.54	*-	69.7	*n 89.8

*n: The aggregation method is "Weighted Average using all components"

*c: Using Capabilities Class Dominant Condition Aggregation Method

*- Irr Class weighted average cannot be calculated on the current soils data due to missing data.

Soils data provided by USDA and NRCS.