

Soils Map

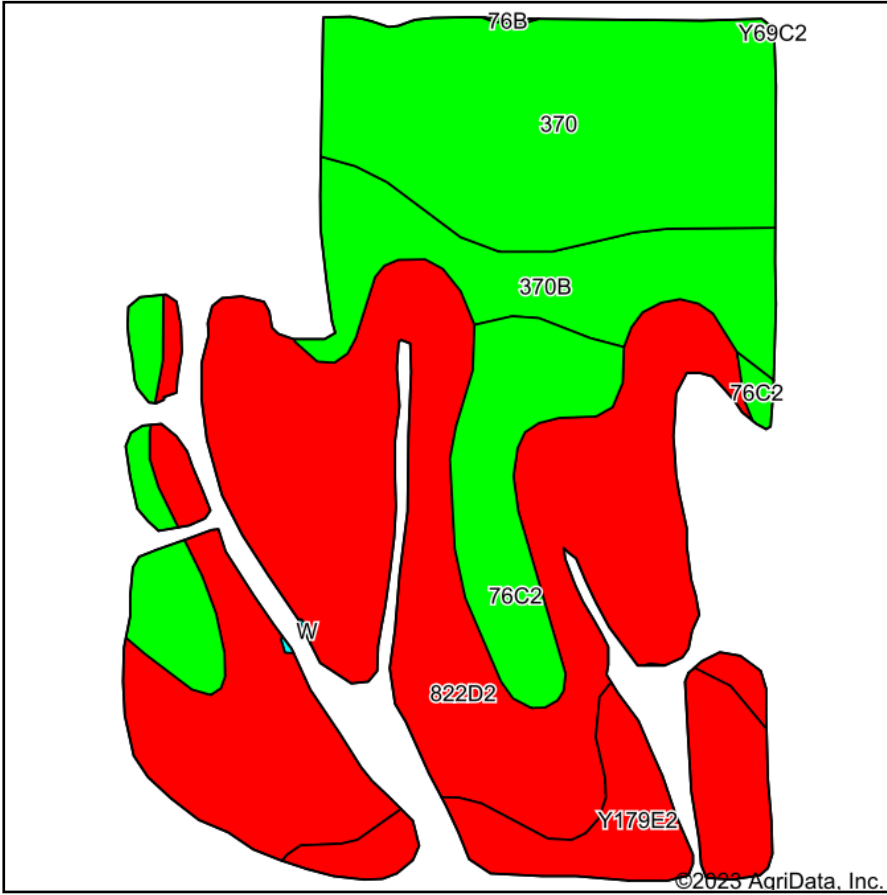

Soils data provided by USDA and NRCS.

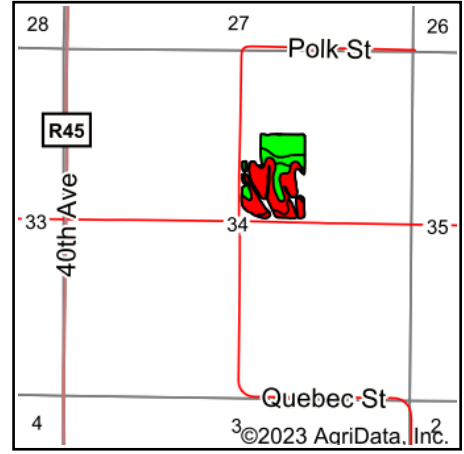

State: **Iowa**
 County: **Warren**
 Location: **34-75N-25W**
 Township: **Jackson**
 Acres: **21.68**
 Date: **1/2/2023**



Maps Provided By:



© AgriData, Inc. 2021

www.AgriDataInc.com



Area Symbol: IA181, Soil Area Version: 28

Code	Soil Description	Acres	Percent of field	CSR2 Legend	Non-Irr Class *c	CSR2**	CSR	
822D2	Lamoni silty clay loam, 9 to 14 percent slopes, eroded	10.25	47.3%		IVe	10	15	
370	Sharpsburg silty clay loam, 0 to 2 percent slopes	4.71	21.7%		I	96	92	
370B	Sharpsburg silty clay loam, 2 to 5 percent slopes	2.97	13.7%		IIe	91	87	
Y179E2	Gara loam, dissected till plain, 14 to 18 percent slopes, eroded	1.96	9.0%		VIe	32		
76C2	Ladoga silt loam, dissected till plain, 5 to 9 percent slopes, eroded	1.79	8.3%		IIIe	75	65	
Weighted Average						3.17	47.1	*-

**IA has updated the CSR values for each county to CSR2.

*- CSR weighted average cannot be calculated on the current soils data, use prior data version for csr values.

*c: Using Capabilities Class Dominant Condition Aggregation Method

Soils data provided by USDA and NRCS.